

Deceptively spacious two bedroom maisonette

Located within easy walking distance of the town centre

78 Magdala Terrace

Galashiels, TD1 2HX



Scan Here!



2 BED



1 BATH



ON STREET

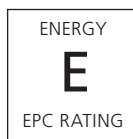

ENERGY

E

EPC RATING

78 Magdala Terrace



Bedrooms & Bathrooms

THE LOCATION

The name, Galashiels, is derived from shiels or shielings which means dwellings and is usually preceded by a place or personal name, hence Galashiels, which means dwellings by the Gala Water. Although Galashiels is a small town, there are plenty of activities available to enjoy, a short walk away you will find Gala Water Retail Park, where occupiers include M&S Simply Food, Next, New Look, Boots, Pets at Home and Clarks. The retail park sits adjacent to Tesco Extra and ASDA.

For those who enjoy leisure activities, Tweedbank Sports Centre and The Borders Sport and Leisure Centre will keep all members of the family entertained on a day out. Cyclists can join the 90-mile Tweed Cycle Way in Galashiels, while hikers can join the Southern Upland Way as it passes through.

Galashiels is home to a number of primary schools, one secondary school, Heriot Watt University and The Borders College. You'll find the Scottish Borders is easy to reach from every direction, with major routes from all directions touching its boundaries. Leave behind the motorways and ring roads and in little more than an hour by car from Edinburgh, Glasgow, Newcastle and Carlisle you will discover that driving is a pleasure. Traffic free roads and quiet country lanes reveal breath-taking vistas which change with the seasons.

The Borders Railway line is set to be up and running by summer 2015 with half hourly service at peak times over seven days of the week. The rail line will run from Tweedbank in the Scottish Borders to Midlothian, Edinburgh Waverley, connecting to the national and international rail network within an hour.

THE PROPERTY

Viewing is highly recommended for this spacious Maisonette. The property is accessed from the rear, making it a quiet and peaceful location, yet near to all amenities. The property briefly comprises, entrance hall with good storage, fitted kitchen, good sized lounge with views to Gala Hill. Upstairs there is a four piece part tiled bathroom with electric shower as well as two double bedrooms.

Externally there is a rear garden, an outhouse with original features, and a shed for added storage. The front garden is shared and there is ample on road parking.

The property further benefits from gas central heating, a combi-boiler with full service history and double glazed window units to ensure a cosy yet cost effective living environment for you.



Kitchen & Lounge



Ground Floor

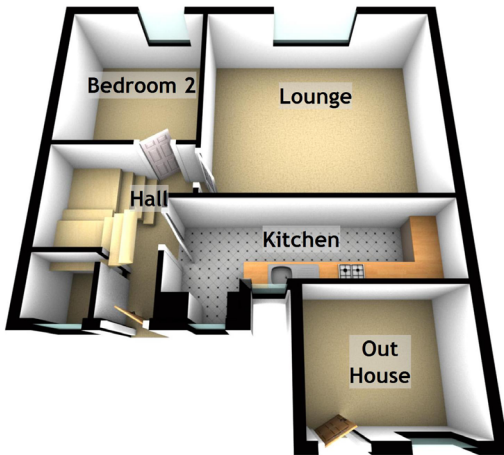

First Floor

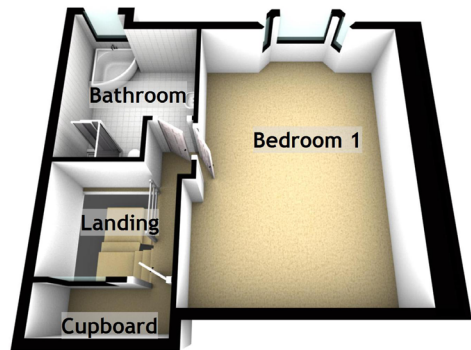

APPROXIMATE DIMENSIONS

(Taken from the widest point)

Lounge	4.16M (13'8") X 3.15M (10'4")
Kitchen	3.80M (12'5") X 1.49M (4'11")
Bedroom 1	4.34M (14'3") X 3.13M (10'3")
Bedroom 2	3.06M (10') X 2.75M (9')
Bathroom	3.06M (10') X 2.44M (8')
Out House	3.81M (12'6") X 2.41M (7'11")

EXTRAS

(Included in the sale)

All fitted carpets and floor coverings, curtains and blinds.



McEwan Fraser Legal

Solicitors & Estate Agents

Claremont House, 130 East Claremont Street

Edinburgh, EH7 4LB

Telephone: 0131 524 9797

Fax: 0131 556 5129

Email: info@mcewanfraserlegal.co.uk

www.mcewanfraserlegal.co.uk



Part Exchange

If you are interested in this property and have a property to sell, please call 0131 524 9797 or complete our online form to receive a Part Exchange value on your own property.

The copyright for all photographs, floorplans, graphics, written copy and images belongs to McEwan Fraser and use by others or transfer to third parties is forbidden without our express consent in writing.

Prospective purchasers are advised to have their interest noted through their estate agents as soon as possible in order that they may be informed in the event of an early closing date being set for the receipt of offers. These particulars do not form part of an offer and all statements contained herein are believed to be correct but are not guaranteed and any intended purchaser must satisfy themselves as to their accuracy. The dimensions provided may include, or exclude, recesses intrusions and fitted furniture. They have been chosen to indicate the general size and shape of each room. Any detailed measurements ought to be taken personally.



Text and description
KATY LEIGH
Surveyor



Professional photography
PHILIP STEWART
Photographer



Layout graphics and design
EAMONN MULLANE
Designer