



McEwan Fraser Legal

Solicitors & Estate Agents

01382 721 212

Flat A, 2 Forebank Terrace

DUNDEE, DD1 2PE

DUNDEE

DD1 2PE

Dundee is situated on the north bank of the Firth of Tay and bounded by the Sidlaw Hills, modern Dundee is known as the City of Discovery, a vibrant city with a rich history.

Its recent, extensive regeneration has created an attractive and dynamic location, boasting all the amenities and attractions you would expect from Scotland's fourth-largest city.

Dundee has two world-class universities, some excellent schools and a leading further education college, plus an excellent range of leisure facilities to cater for all the family.

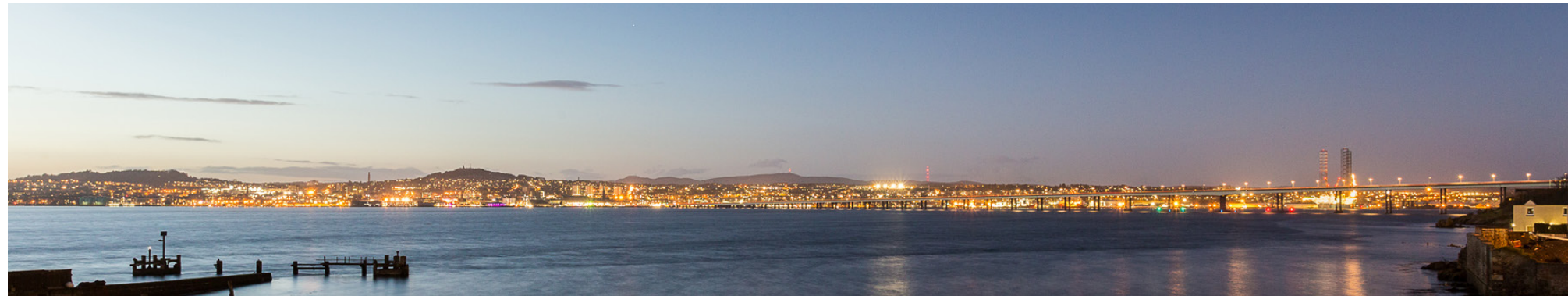

FLAT A, 2 FOREBANK TERRACE

DUNDEE, DD1 2PE

McEwan Fraser Legal is delighted to present this 2 double bedrooms ground floor flat in this impressive building. The property is in good condition with a modern kitchen and white bathroom suite. The ground floor flat has excellent transport links close by and walking distance of amenities, local school and city centre. Inside, the property comprises of:

- Large modern kitchen/breakfast room
- Spacious living/dining area
- 2 bedrooms which include one with fitted wardrobes
- 1 white modern bathrooms with power shower over
- Two Storage cupboard off the hallway with ample space
- Front and rear communal garden
- UPVC windows and gas fired central heating
- High ceilings with character
- Walking distance from the city centre
- Parking close by but not allocated

In addition to this, the property enjoys communal gardens to the front and rear. This is a great opportunity to acquire this lovely first-time buyers property or an ideal investment opportunity due to its proximity to the city centre.





SPECIFICATIONS & DETAILS

FLOOR PLAN, DIMENSIONS & MAP

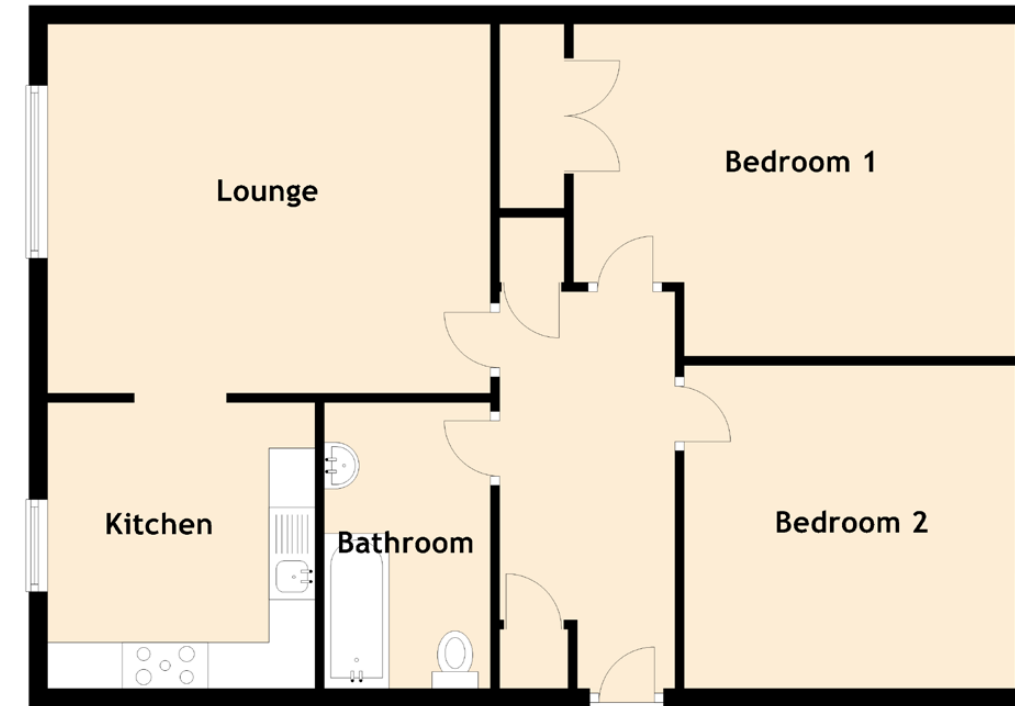

Approximate Dimensions
(Taken from the widest point)

Lounge	4.80m (15'9") x 4.00m (13'1")
Kitchen	3.10m (10'2") x 2.90m (9'6")
Bedroom 1	4.80m (15'9") x 3.60m (11'10")
Bedroom 2	3.60m (11'10") x 3.40m (11'2")
Bathroom	3.10m (10'2") x 1.80m (5'11")

Gross internal floor area (m²): 75m²

EPC Rating: D

Extras (Included in the sale): Floor coverings, blinds, light fittings and cooker are included in the sale.

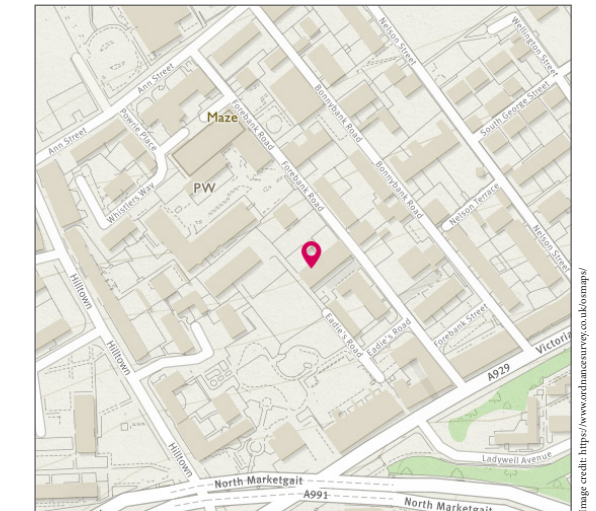

Image credit: <https://www.dummeasures.co.uk/maps/>



Solicitors & Estate Agents

Tel. 01382 721 212
www.mcewanfraserlegal.co.uk
info@mcewanfraserlegal.co.uk

Part
Exchange
Available

Disclaimer: The copyright for all photographs, floorplans, graphics, written copy and images belongs to McEwan Fraser Legal and use by others or transfer to third parties is forbidden without our express consent in writing. Prospective purchasers are advised to have their interest noted through their solicitor as soon as possible in order that they may be informed in the event of an early closing date being set for the receipt of offers. These particulars do not form part of any offer and all statements and photographs contained herein are for illustrative purposes and are not guaranteed or warranted. Buyers must satisfy themselves for the accuracy and authenticity of the brochure and should always visit the property to satisfy themselves of the property's suitability and obtain in writing via their solicitor what's included with the property including any land. The dimensions provided may include, or exclude, recesses intrusions and fitted furniture. Any measurements provided are for guide purposes only and have been taken by electronic device at the widest point. Any reference to alterations to, or use of, any part of the property does not mean that any necessary planning, building regulations or other consent has been obtained. A buyer must find out by inspection or in other ways that all information is correct. None of the appliances/services stated or shown in this brochure have been tested by ourselves and none are warranted by our seller or MFL.



Text and description
JAMES KEET
Surveyor



Professional photography
GRANT LAWRENCE
Photographer



Layout graphics and design
ALLY CLARK
Designer