



McEwan Fraser Legal

Solicitors & Estate Agents

01382 721 212

50 Blaikies Mews

ALEXANDER STREET, DUNDEE, ANGUS, DD3 7UN

Dundee

ANGUS, DD3 7UN

Located just off Dens Road. Dundee is situated on the north bank of the Firth of Tay and bounded by the Sidlaw Hills, modern Dundee is known as the 'City of Discovery', a vibrant city with a rich history. Its recent, extensive regeneration has created an attractive and dynamic location, boasting all the amenities and attractions you would expect from Scotland's fourth largest city. Dundee has two world-class universities, some excellent schools, and a leading further education college, plus an excellent range of leisure facilities to cater for all the family.

There is a mainline railway station, with services to the south and a regional airport with flights to London City, Belfast, and Birmingham. The A90 dual carriageway provides fast access to Perth and central Scotland, as well as to Aberdeen. Carnoustie, with its world famous golf course, is very easily reached. There are a number of other fine links courses in the area including Barry, Panmure, and Monifieth. St Andrews is also within easy driving distance. There is sailing on the Tay and pleasant sandy beaches along the coast. The Angus Glens lie to the north. Dundee and Abertay Universities are both located within close reach. The Technology Park and Ninewells Hospital and Medical School, the largest teaching Hospital of its kind in Europe are also easily accessible.





50 Blaikies Mews

ALEXANDER STREET, DUNDEE,
ANGUS, DD3 7UN

This delightful semi-detached home has been nicely maintained and presented to create a comfortable family home. Offering excellent value for money, this home offers spacious accommodation over two floors.

The entrance hallway offers access to all apartments. The living room is bright and airy by the grace of dual aspect to the front and side of the house. There is ample room for a dining table as well as the sofa. A door opens from here into the kitchen providing a good sense of flow. The kitchen provides ample units at both floor and wall level and includes a hob, built under oven and cooker hood. There is space for a table and chairs and a breakfast bar provides a nice spot for coffee. Once again, the dual aspect on either side helps the kitchen stay bright with natural light. A door opens to the side of the house and the little terrace.

An open tread, carpeted staircase rises to the bedrooms and bathroom. Both bedrooms have built-in storage. The bathroom is spacious with a bath and completes the accommodation.

Externally there is parking to the side and a patio terrace at the back door.





Specifications & Details

FLOOR PLAN, DIMENSIONS & MAP

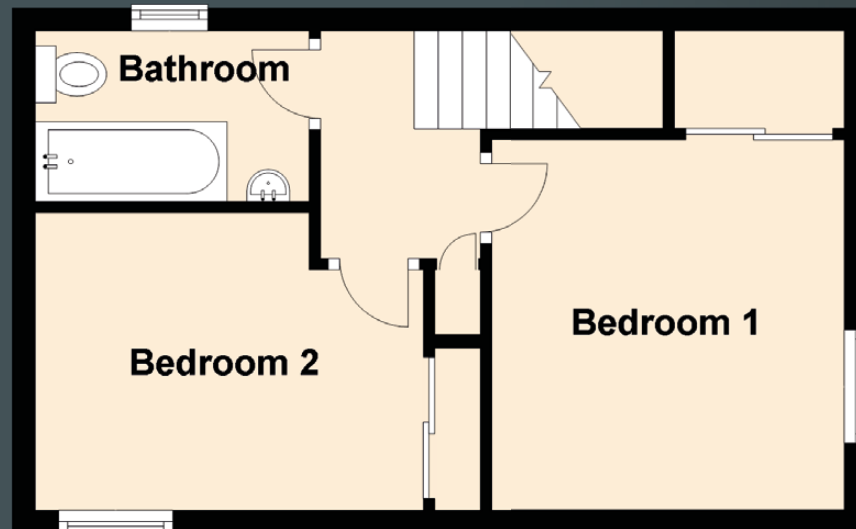
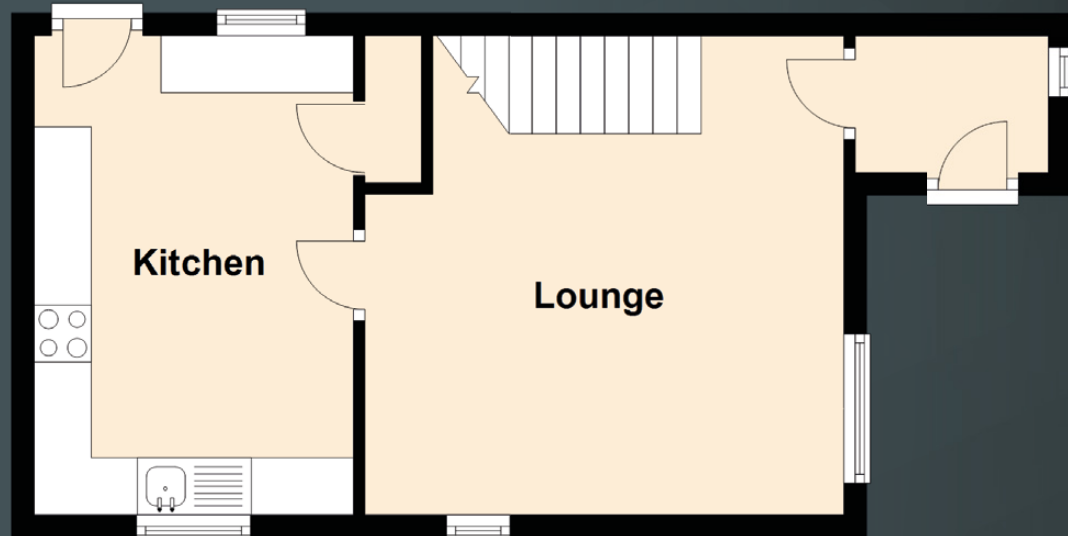

Approximate Dimensions (Taken from the widest point)

Lounge	4.20m (13'9") x 4.20m (13'9")
Kitchen	4.20m (13'9") x 2.80m (9'2")
Bedroom 1	3.20m (10'6") x 3.10m (10'2")
Bedroom 2	3.40m (11'2") x 2.60m (8'7")
Bathroom	2.40m (7'10") x 1.60m (5'3")

Gross internal floor area (m²): 63m² | EPC Rating: D

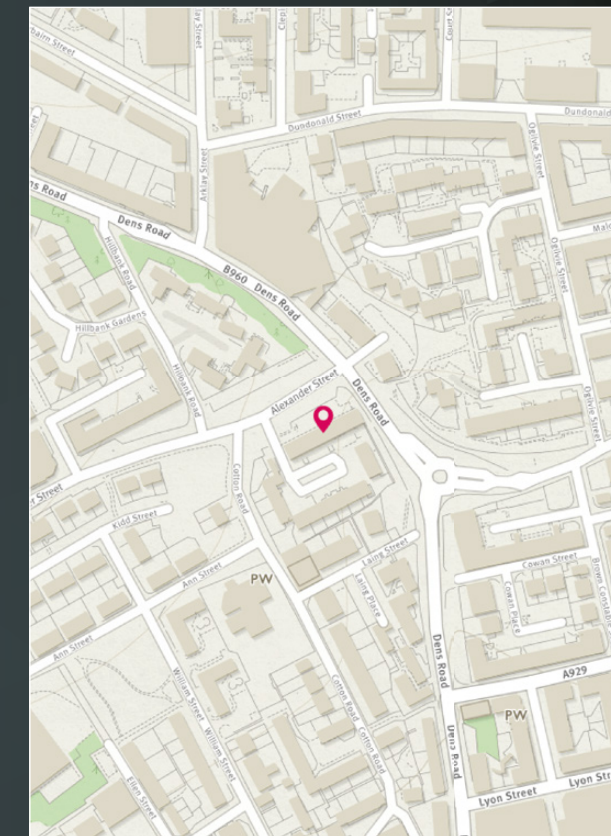



McEwan Fraser Legal
Solicitors & Estate Agents
Proud Club Sponsor

Part
Exchange
Available



Text and description
JAYNE SMITH
Surveyor



Professional photography
GRANT LAWRENCE
Photographer



Layout graphics and design
ALLY CLARK
Designer

Disclaimer: The copyright for all photographs, floorplans, graphics, written copy and images belongs to McEwan Fraser Legal and use by others or transfer to third parties is forbidden without our express consent in writing. Prospective purchasers are advised to have their interest noted through their solicitor as soon as possible in order that they may be informed in the event of an early closing date being set for the receipt of offers. These particulars do not form part of any offer and all statements and photographs contained herein are for illustrative purposes and are not guaranteed or warranted. Buyers must satisfy themselves for the accuracy and authenticity of the brochure and should always visit the property to satisfy themselves of the property's suitability and obtain in writing via their solicitor what's included with the property including any land. The dimensions provided may include, or exclude, recesses intrusions and fitted furniture. Any measurements provided are for guide purposes only and have been taken by electronic device at the widest point. Any reference to alterations to, or use of, any part of the property does not mean that any necessary planning, building regulations or other consent has been obtained. A buyer must find out by inspection or in other ways that all information is correct. None of the appliances/ services stated or shown in this brochure have been tested by ourselves and none are warranted by our seller or MFL.