



*SPACIOUS FOUR-BEDROOM  
MID-TERRACED FAMILY HOME*



0131 524 9797



[www.mcewanfraserlegal.co.uk](http://www.mcewanfraserlegal.co.uk)



[info@mcewanfraserlegal.co.uk](mailto:info@mcewanfraserlegal.co.uk)

McEwan Fraser Legal is delighted to present this four bedroom mid terraced family home in the heart of Edinburgh's popular residential area of Inverleith.

Inside, the property comprises of a spacious living area which offers a multitude of furniture configurations. The lounge also leads onto the conservatory which has been upgraded to be used all year round.









The fully equipped modern kitchen with integrated fan oven, induction hob and free-standing white goods. The kitchen is a welcoming, generously proportioned space.





The house has four bedrooms all of which range in size from the master bedroom with en suite shower room down to bedroom four which is a single bedroom.





**Bedroom 2**





**Bedroom 3**







**Bedroom 4**





There is a downstairs WC, family bathroom on the first floor which has a shower over the bath and is in excellent condition and finally there is an en suite three piece shower room in the master bedroom



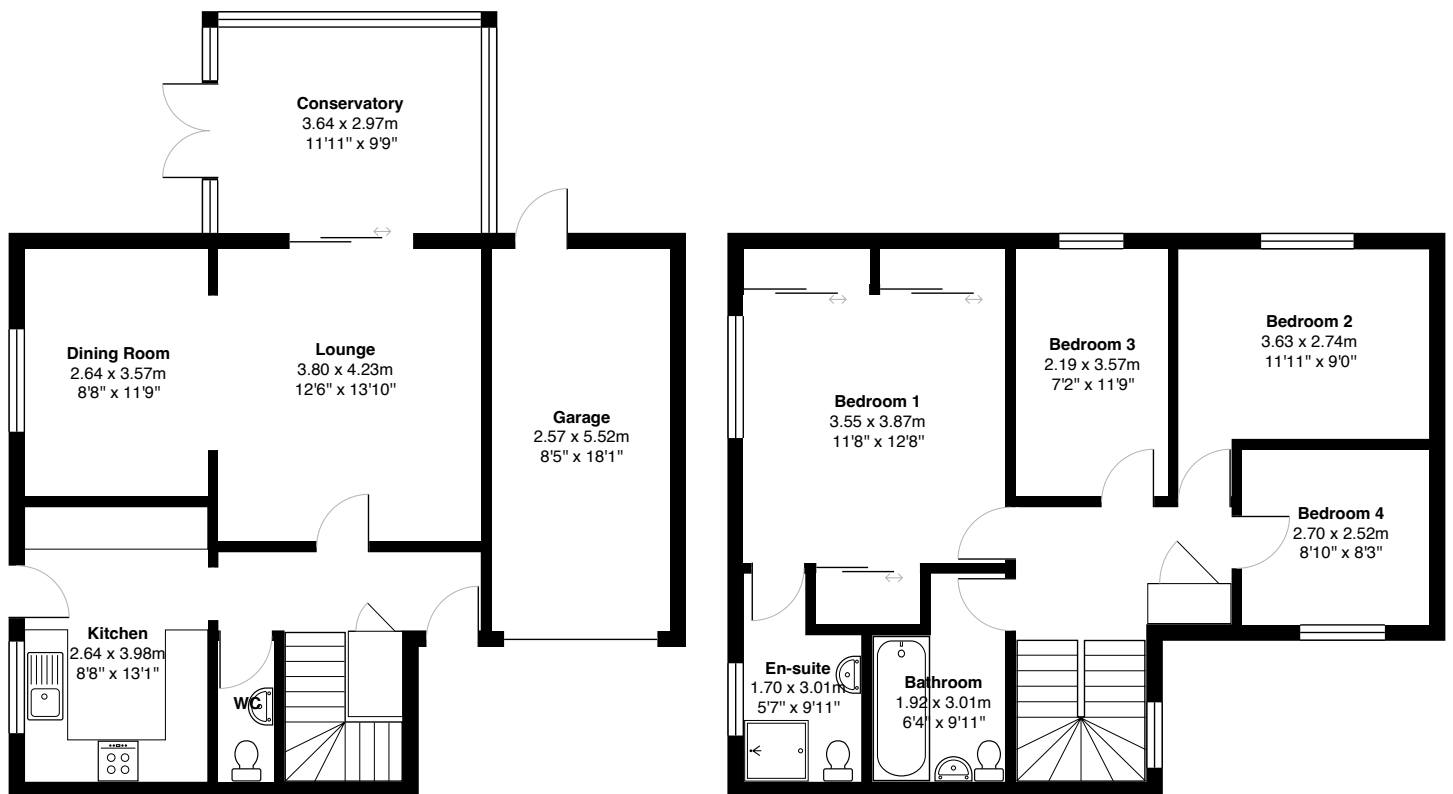

Gross internal floor area (m<sup>2</sup>): 122m<sup>2</sup>

EPC Rating: C





In addition to this, the property boasts a generous single garage with electric door, driveway, modern double glazing, gas central heating and solar panels on the roof, making for a warm and cost effective home, year round.







The Ferryfield development is a quiet cul de sac accessed off Ferry Road in the highly sought-after residential area of Inverleith. The area is well served by a host of excellent amenities which include a selection of everyday shops, a post office, medical centre and cafes all within easy walking distance. Regular public transport operates along Inverleith Row to the city centre and to surrounding areas.

Further amenities are available at nearby Comely Bank and Stockbridge which offers a Waitrose Supermarket. The Royal Botanic Gardens, Water of Leith and Inverleith Park are also close by and offer many pleasant walks.

## The Location

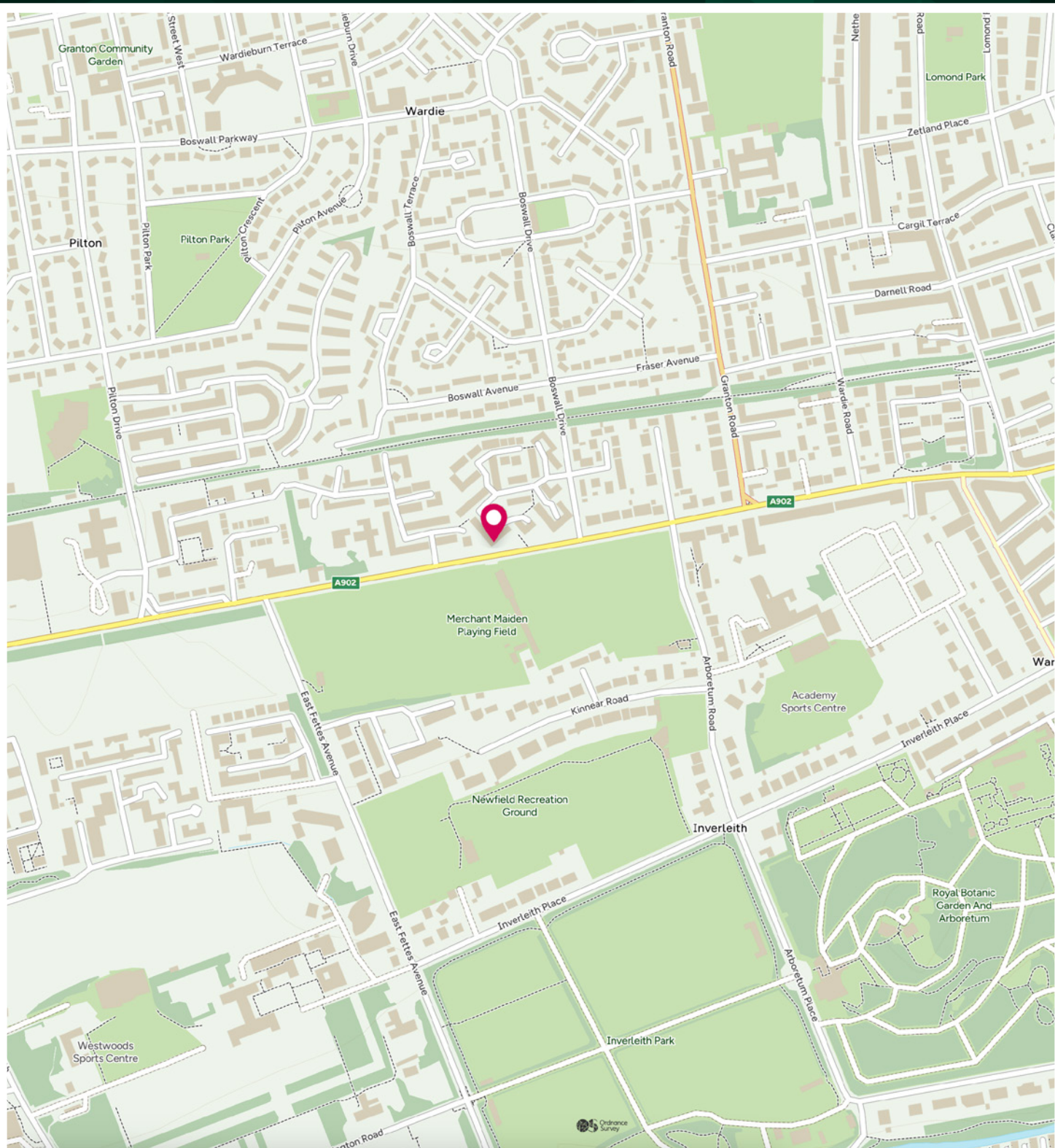

# McEwan Fraser Legal

Solicitors & Estate Agents

Tel. 0131 524 9797

[www.mcewanfraserlegal.co.uk](http://www.mcewanfraserlegal.co.uk)

[info@mcewanfraserlegal.co.uk](mailto:info@mcewanfraserlegal.co.uk)

Part  
Exchange  
Available



THE SUNDAY TIMES  
THE SUNDAY TIMES



Text and description  
**BEN STEWART CLARK**  
Area Sales Manager



Professional photography  
**MARK BRYCE**  
Photographer



Layout graphics and design  
**ALAN SUTHERLAND**  
Designer

**Disclaimer:** The copyright for all photographs, floorplans, graphics, written copy and images belongs to McEwan Fraser Legal and use by others or transfer to third parties is forbidden without our express consent in writing. Prospective purchasers are advised to have their interest noted through their solicitor as soon as possible in order that they may be informed in the event of an early closing date being set for the receipt of offers. These particulars do not form part of any offer and all statements and photographs contained herein are for illustrative purposes and are not guaranteed or warranted. Buyers must satisfy themselves for the accuracy and authenticity of the brochure and should always visit the property to satisfy themselves of the property's suitability and obtain in writing via their solicitor what's included with the property including any land. The dimensions provided may include, or exclude, recesses intrusions and fitted furniture. Any measurements provided are for guide purposes only and have been taken by electronic device at the widest point. Any reference to alterations to, or use of, any part of the property does not mean that any necessary planning, building regulations or other consent has been obtained. A buyer must find out by inspection or in other ways that all information is correct. None of the appliances/services stated or shown in this brochure have been tested by ourselves and none are warranted by our seller or MFL.