

21 Firbank Grove

EAST CALDER, WEST LOTHIAN, EH53 0DY



COMBINING MODERN UPGRADES WITH GENEROUS FAMILY LIVING, THIS IMPRESSIVE HOME IS PERFECTLY PLACED WITHIN A DESIRABLE RESIDENTIAL COMMUNITY



01506 537 100



www.mcewanfraserlegal.co.uk



info@mcewanfraserlegal.co.uk





McEwan Fraser Legal is delighted to present this attractive three-bedroom semi-detached family home, set within a sought-after residential location in the heart of Livingston. Offering generous living accommodation, stylish upgrades, and a beautifully maintained rear garden, this property is perfectly suited to families and professionals alike.

The home immediately impresses with its well-presented front garden, paved driveway, and welcoming entrance, creating excellent kerb appeal from the outset.

Internally, the property boasts a bright and spacious living room, enhanced by large windows that flood the space with natural light, while a charming gas fireplace provides a warm focal point. The living area flows seamlessly into the adjoining dining room, offering an ideal setting for both everyday family life and entertaining guests. From here, residents can enjoy attractive views over the rear garden.





The recently refurbished kitchen has been finished to a high standard and features a range of contemporary integrated appliances, generous worktop space, and ample storage. Multiple windows and a rear door ensure the room is filled with natural light, providing convenient access to the garden.



The upper level comprises three well-proportioned bedrooms, along with a family bathroom benefiting from a window for natural ventilation and daylight. Additional practical features include valuable under-stair storage and a partially converted garage, which offers flexible additional living accommodation while retaining useful storage space.





Bedroom 2





Bedroom 3





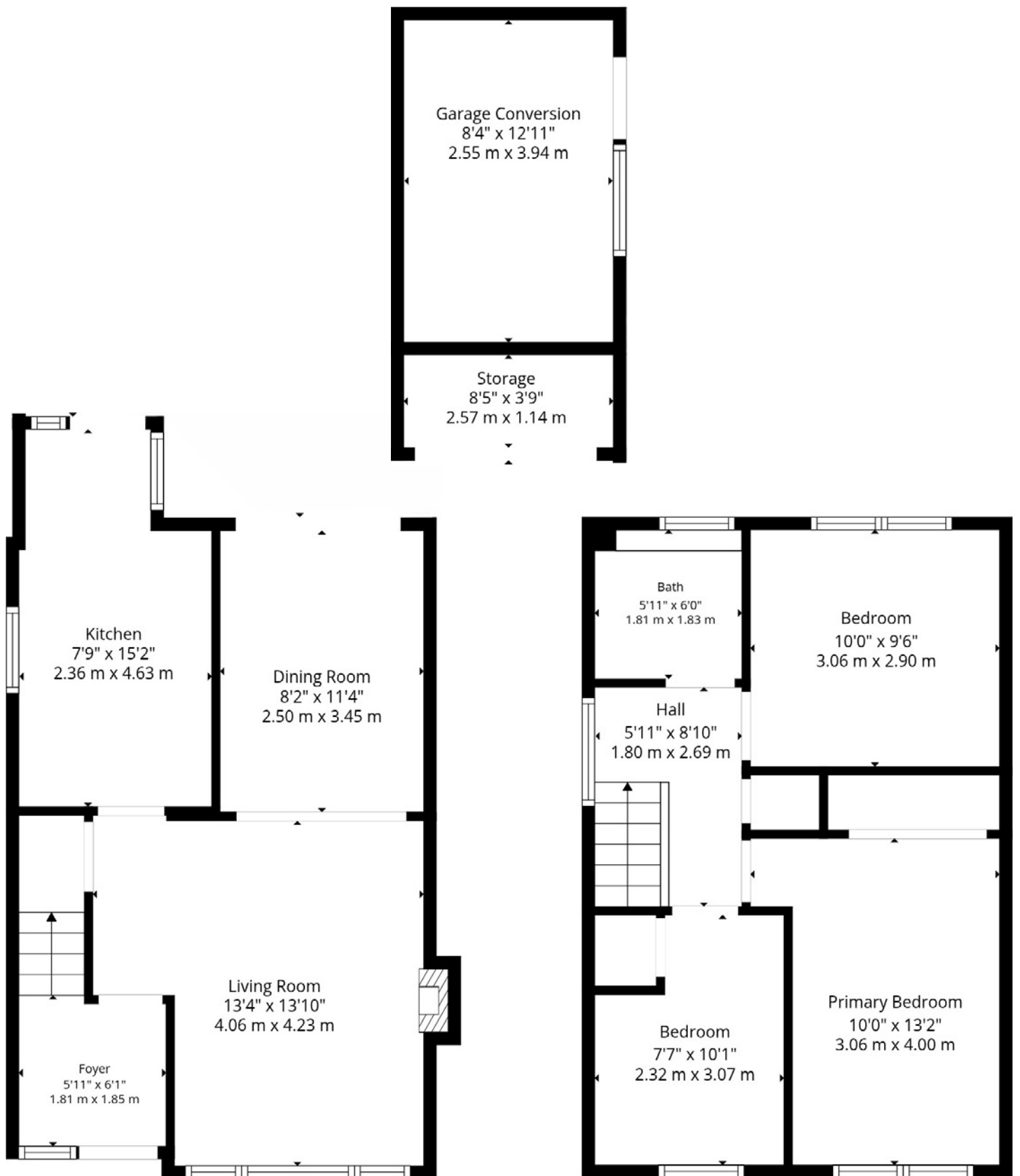

Gross internal floor area (m²): 81m²

EPC Rating: C



Externally, the well-maintained rear garden provides a private outdoor retreat. Further benefits include a combi boiler and an attic space, offering additional storage potential.







Firbank Grove enjoys a desirable position within the popular West Lothian village of East Calder, offering an excellent balance of peaceful residential living and outstanding connectivity. The area is particularly well regarded by families, benefiting from highly regarded local schooling, a range of everyday amenities, and an abundance of green spaces and walking routes nearby.

Residents are well served by a selection of local shops, cafés, supermarkets, and leisure facilities, while the extensive retail and entertainment options of Livingston are just a short drive away. The area also offers excellent transport links, with easy access to the M8 motorway providing convenient commuting to both Edinburgh and Glasgow. Nearby railway stations at Livingston South and Kirknewton offer regular services to Edinburgh city centre and beyond.

Combining a welcoming community atmosphere with superb accessibility, East Calder continues to be one of West Lothian's most sought-after locations for professionals, growing families, and those looking to enjoy a semi-rural lifestyle without compromising on convenience.

The Location

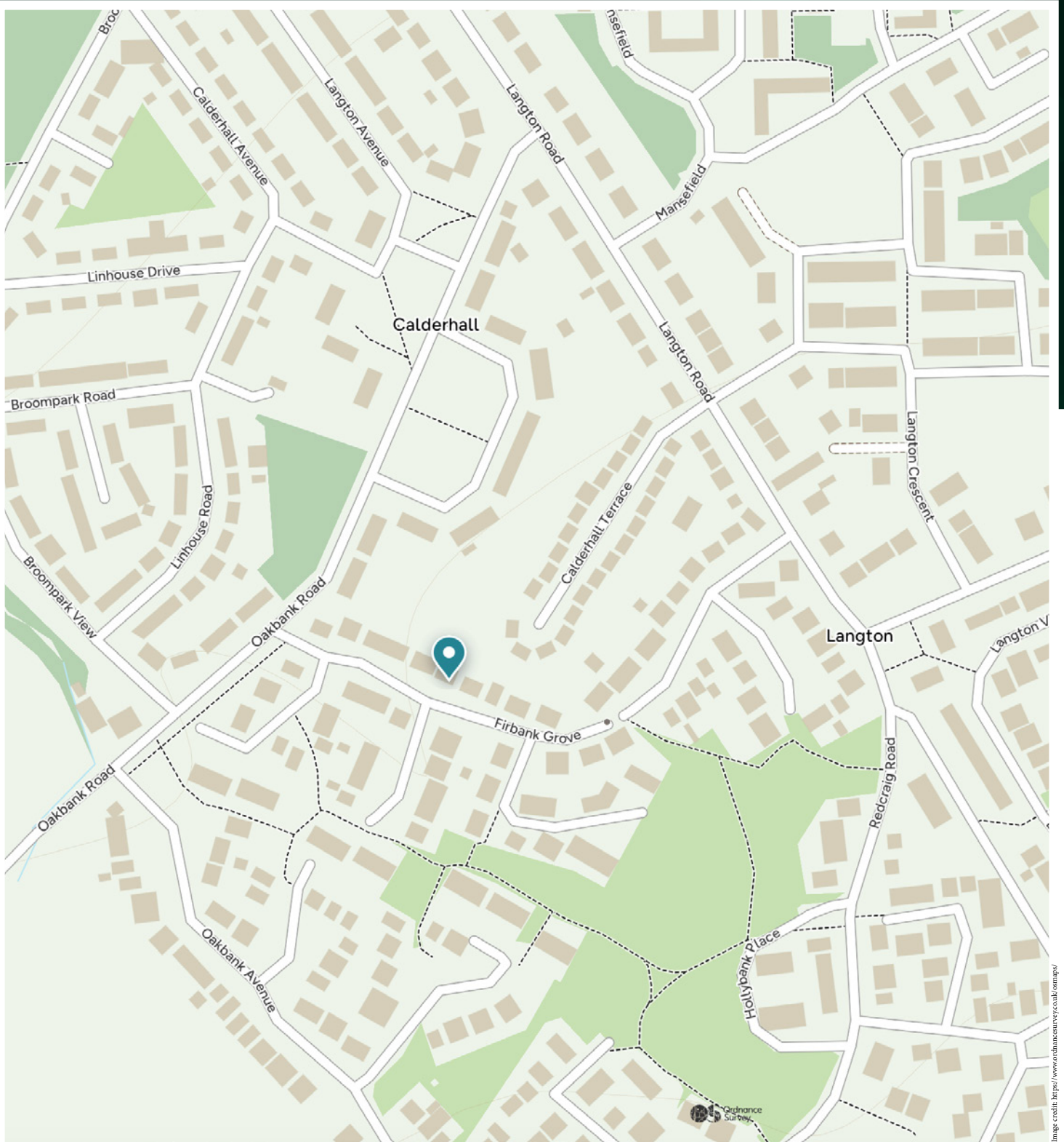

Image credit: <https://www.ordnancesurvey.co.uk/osmap/>

McEwan Fraser Legal

Solicitors & Estate Agents

Tel. 01506 537 100

www.mcewanfraserlegal.co.uk

info@mcewanfraserlegal.co.uk



Text and description
ZARA GROPELLIER
Surveyor



Layout graphics and design
ALAN SUTHERLAND
Designer

Disclaimer: The copyright for all photographs, floorplans, graphics, written copy and images belongs to McEwan Fraser Legal and use by others or transfer to third parties is forbidden without our express consent in writing. Prospective purchasers are advised to have their interest noted through their solicitor as soon as possible in order that they may be informed in the event of an early closing date being set for the receipt of offers. These particulars do not form part of any offer and all statements and photographs contained herein are for illustrative purposes and are not guaranteed or warranted. Buyers must satisfy themselves for the accuracy and authenticity of the brochure and should always visit the property to satisfy themselves of the property's suitability and obtain in writing via their solicitor what's included with the property including any land. The dimensions provided may include, or exclude, recesses intrusions and fitted furniture. Any measurements provided are for guide purposes only and have been taken by electronic device at the widest point. Any reference to alterations to, or use of, any part of the property does not mean that any necessary planning, building regulations or other consent has been obtained. A buyer must find out by inspection or in other ways that all information is correct. None of the appliances/services stated or shown in this brochure have been tested by ourselves and none are warranted by our seller or MFL.