



**McEwan Fraser Legal**

Solicitors & Estate Agents

01463 211 116

St. Clair Cottage

CASTLETOWN, THURSO, HIGHLAND, KW14 8UA



ST. CLAIR COTTAGE

CASTLETOWN, THURSO, HIGHLAND, KW14 8UA

The village of Castletown is located between Thurso (5 miles) and Wick (15 miles) and has a number of shops, restaurants and a hotel. The property is a stone's throw from the local primary school with senior pupils attending Thurso High School.

Thurso itself has many facilities including a health centre, dentist, shops, hotels, restaurants, supermarkets and a railway station with regular services to Inverness and connections to the rest of the UK. Wick Airport has daily flights to Edinburgh and Aberdeen where domestic and international flights are available. The University of the Highlands & Islands (UHI) offers many further education opportunities in both Wick & Thurso. Dunbar Hospital, Thurso and Caithness General Hospital located in Wick, both offer a large range of medical services to the surrounding area.

McEwan Fraser Legal is delighted to offer an excellent opportunity to purchase this spacious two-bedroom bungalow. The property does require an element of upgrading and improvement to bring it up to contemporary standards.

The accommodation consists of entrance hallway, lounge with open-fire, breakfasting kitchen (including fridge freezer, tumble dryer and washing machine), two bedrooms (one with en-suite shower), large conservatory and family bathroom. The property also benefits from oil-fired central heating and double-glazing.

The property is set in generous garden grounds which is mainly laid to lawn and is accessed via a private shared drive. This property would make a great first-time purchase, and given a bit of love and attention, a great home.



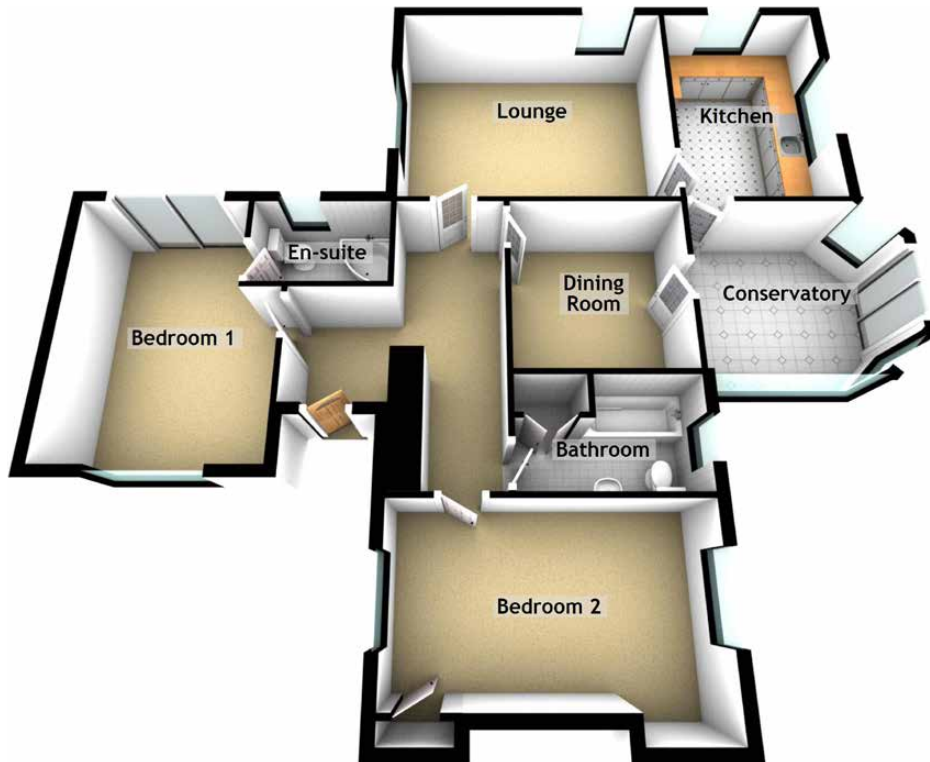

Approximate Dimensions
(Taken from the widest point)

Lounge	4.80m (15'9") x 4.00m (13'1")
Kitchen	4.00m (13'1") x 2.90m (9'6")
Dining Room	3.00m (9'10") x 2.90m (9'6")
Conservatory	3.50m (11'6") x 3.00m (9'10")
Bedroom 1	4.50m (14'9") x 3.50m (11'6")
Bedroom 2	4.80m (15'9") x 3.20m (10'6")
Bathroom	2.90m (9'6") x 1.80m (5'11")
En-suite	2.30m (7'7") x 1.50m (4'11")

Gross internal floor area (m²): 128m²

EPC Rating: F

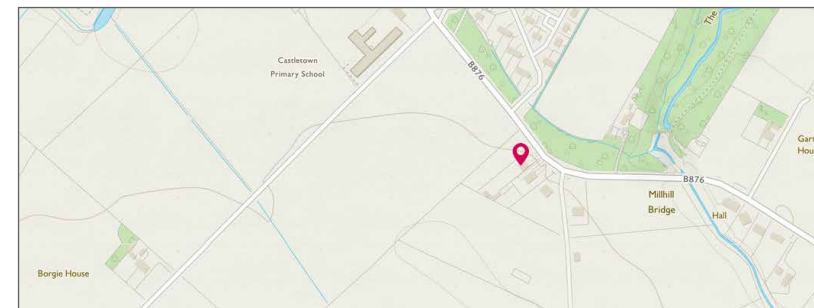

Image credit: <https://www.vonhannencourtesy.co.uk/company/>

McEwan Fraser Legal

Solicitors & Estate Agents

Tel. 01463 211 116
www.mcewanfraserlegal.co.uk
info@mcewanfraserlegal.co.uk

Part
Exchange
Available

Disclaimer : The copyright for all photographs, floorplans, graphics, written copy and images belongs to McEwan Fraser Legal and use by others or transfer to third parties is forbidden without our express consent in writing. Prospective purchasers are advised to have their interest noted through their solicitor as soon as possible in order that they may be informed in the event of an early closing date being set for the receipt of offers. These particulars do not form part of any offer and all statements and photographs contained herein are for illustrative purposes and are not guaranteed or warranted. Buyers must satisfy themselves for the accuracy and authenticity of the brochure and should always visit the property to satisfy themselves of the property's suitability and obtain in writing via their solicitor what's included with the property including any land. The dimensions provided may include, or exclude, recesses intrusions and fitted furniture. Any measurements provided are for guide purposes only and have been taken by electronic device at the widest point. Any reference to alterations to, or use of, any part of the property does not mean that any necessary planning, building regulations or other consent has been obtained. A buyer must find out by inspection or in other ways that all information is correct. None of the appliances/services stated or shown in this brochure have been tested by ourselves and none are warranted by our seller or MFL.



Text and description
THOMAS KISSOCK
Surveyor



Professional photography
SCOTT MARSHALL
Photographer



Layout graphics and design
ALAN SUTHERLAND
Designer