



  
**McEwan Fraser Legal**  
Solicitors & Estate Agents  
0131 524 9797

**2/6 Parliament Street**

THE SHORE, EDINBURGH, EH6 6EB



# THE SHORE

EDINBURGH, EH6 6EB

Situated on the mouth of the Water of Leith, The Shore has a distinctive character and history, with amenities and facilities amongst the best Edinburgh has to offer.

Having undergone a great deal of development, the shore has maintained its quaint charm which provides an elegant backdrop for some of the city's finest cafes, bars and restaurants and boasts the enviable reputation as north Edinburgh's cultural and social centre. Ideally situated for access to Ocean Terminal, ASDA superstore and the Kirkgate shopping centre there are a multitude of amenities within walking distance. Ocean Terminal offers a wide variety of high street shops which include, Debenhams, Marks and Spencer and Boots. There also includes an extensively sized gym, multi-screen cinema complex and further restaurants and cafes.

The Water of Leith provides an opportunity for a touch of nature in the city and leads to nearby Newhaven harbour which boasts stunning views onto the Firth of Forth and beyond. Additional amenities can be found in Leith Walk including a Tesco superstore, banks, building societies and post offices all within easy walking distance. Edinburgh city centre is easily accessible by car or public transport. Edinburgh Airport can be accessed via bus (there is a stop minutes from the property) or tram at York Place.

# 2/6 PARLIAMENT ST

THE SHORE, EDINBURGH, EH6 6EB

An excellent opportunity has arisen to acquire this desirable one bedroom mid-floor flat, making for an ideal first-time buyer or buy-to-let opportunity and located within the popular Leith/Shore area of Edinburgh. There are many bus services reaching out to different areas of the city making this property the ideal central base. Viewing of this property is highly recommended.

Internally this accommodation is in excellent decorative order, briefly consisting of an entrance hallway with a WC and separate shower room. You will also find a bright and spacious lounge/kitchen area with space for free standing appliances. This area is open plan and makes the most of the space on offer. In addition to this, you will find a bedroom which is a large, double in size and completes the property nicely.

This property also benefits from an entry door system, full double glazing making for a warm yet cost effective home all year round and free parking to the front of the property is also available.





# SPECIFICATIONS & DETAILS FLOOR PLAN, DIMENSIONS & MAP

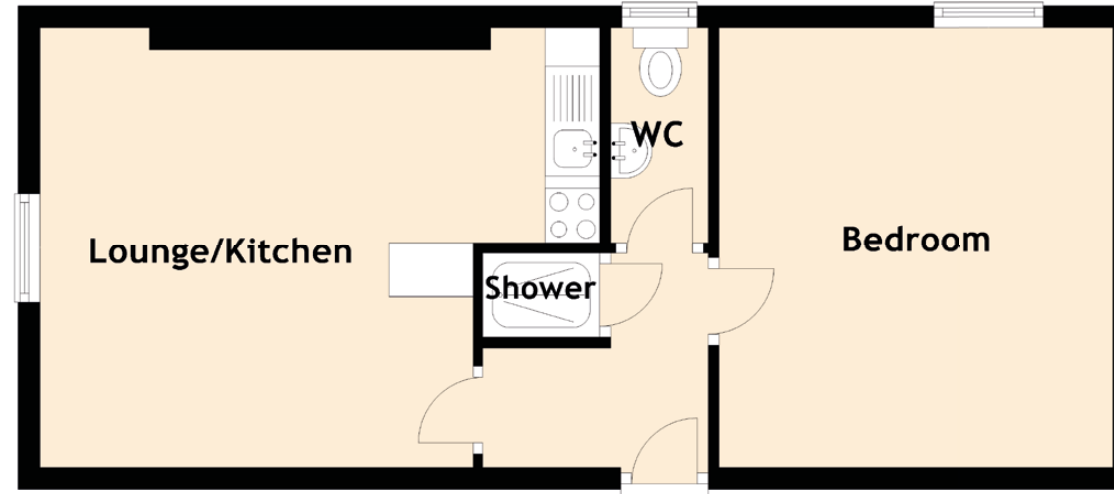

Approximate Dimensions  
(Taken from the widest point)

Lounge/Kitchen	5.13m (16'10") x 4.21m (13'10")
Bedroom	4.02m (13'2") x 3.60m (11'10")
Shower	1.18m (3'10") x 0.77m (2'6")
WC	1.96m (6'5") x 0.89m (2'11")

Gross internal floor area (m<sup>2</sup>): 42m<sup>2</sup>

EPC Rating: C

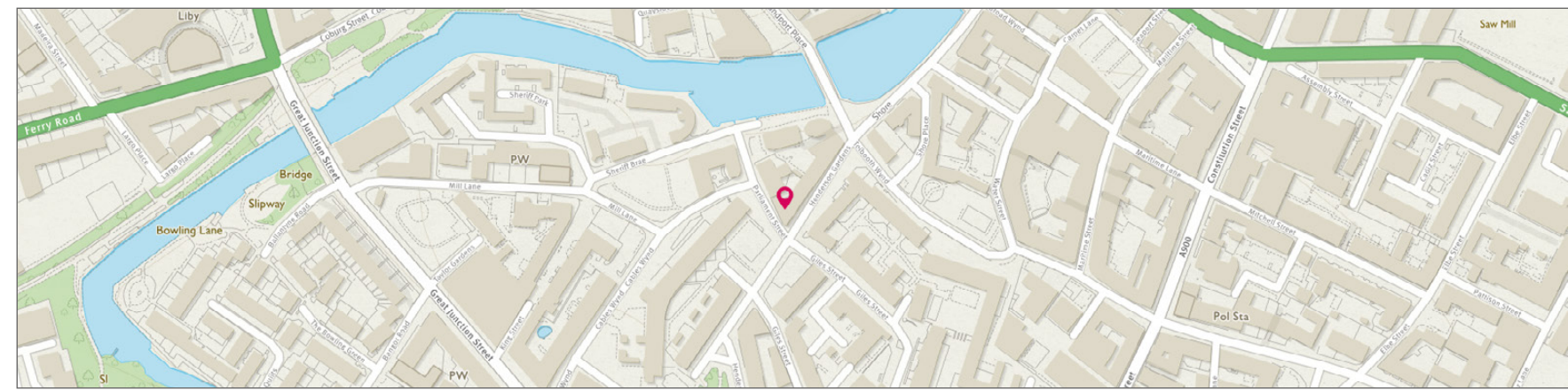

Image credit: <https://www.dunelm.com/>



  
**McEwan Fraser Legal**  
Solicitors & Estate Agents

Tel. 0131 524 9797  
www.mcewanfraserlegal.co.uk  
info@mcewanfraserlegal.co.uk

Part  
Exchange  
Available

**Disclaimer:** The copyright for all photographs, floorplans, graphics, written copy and images belongs to McEwan Fraser Legal and use by others or transfer to third parties is forbidden without our express consent in writing. Prospective purchasers are advised to have their interest noted through their solicitor as soon as possible in order that they may be informed in the event of an early closing date being set for the receipt of offers. These particulars do not form part of any offer and all statements and photographs contained herein are for illustrative purposes and are not guaranteed or warranted. Buyers must satisfy themselves for the accuracy and authenticity of the brochure and should always visit the property to satisfy themselves of the property's suitability and obtain in writing via their solicitor what's included with the property including any land. The dimensions provided may include, or exclude, recesses intrusions and fitted furniture. Any measurements provided are for guide purposes only and have been taken by electronic device at the widest point. Any reference to alterations to, or use of, any part of the property does not mean that any necessary planning, building regulations or other consent has been obtained. A buyer must find out by inspection or in other ways that all information is correct. None of the appliances/services stated or shown in this brochure have been tested by ourselves and none are warranted by our seller or MFL.



Text and description  
**BEN STEWART CLARK**  
Surveyor



Professional photography  
**AOIFE McDONALD**  
Photographer



Layout graphics and design  
**ALLY CLARK**  
Designer