

# 24/5 Durrar Drive

EDINBURGH, EH4 7JJ



*Rarely available two bedroom spacious second floor flat*



0131 524 9797



[www.mcewanfraserlegal.co.uk](http://www.mcewanfraserlegal.co.uk)



[info@mcewanfraserlegal.co.uk](mailto:info@mcewanfraserlegal.co.uk)



McEwan Fraser is delighted to present to the market this superb two-bedroom, second-floor, flat. The property is suitable for a first-time buyer, downsizer or buy-to-let investor. Internal viewing is highly recommended.

# THE LOUNGE



Accommodation comprises a welcoming entrance hall which gives access to all the accommodation including a spacious lounge with balcony, a fitted kitchen to the front of the property, a bathroom with three piece suite and over the bath electric shower and two double bedrooms. There is ample storage throughout the property, gas central heating, double glazing and two large storage cupboards externally.



# THE KITCHEN



# THE BATHROOM





# BEDROOM 1





# BEDROOM 2





# EXTERNALS





# FLOOR PLAN, DIMENSIONS & MAP

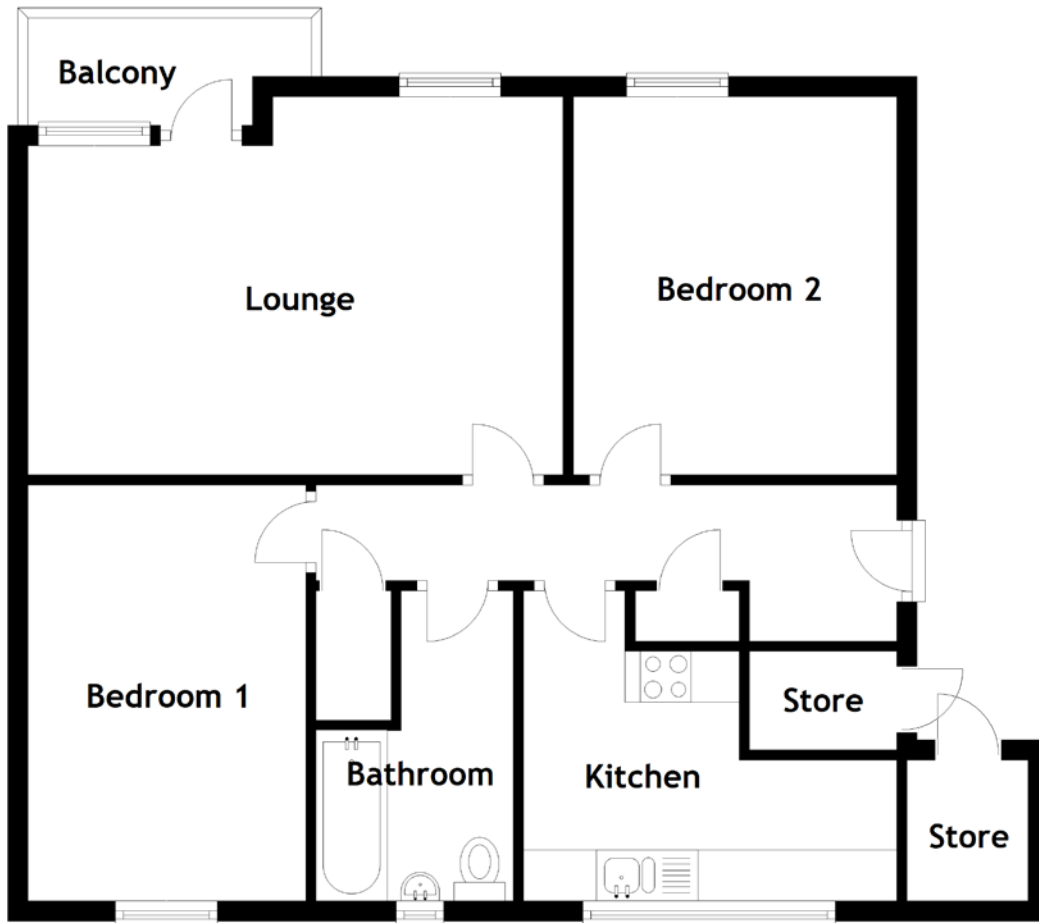

Approximate Dimensions (Taken from the widest point)

Lounge 5.26m (17'3") x 3.72m (12'2")  
 Kitchen 3.67m (12') x 3.05m (10')  
 Balcony 2.78m (9'2") x 1.16m (3'10")

Bedroom 1 4.09m (13'5") x 2.73m (8'11")  
 Bedroom 2 3.72m (12'2") x 3.15m (10'4")  
 Bathroom 3.05m (10') x 1.94m (6'4")

Gross internal floor area (m<sup>2</sup>): 71m<sup>2</sup> | EPC Rating: C

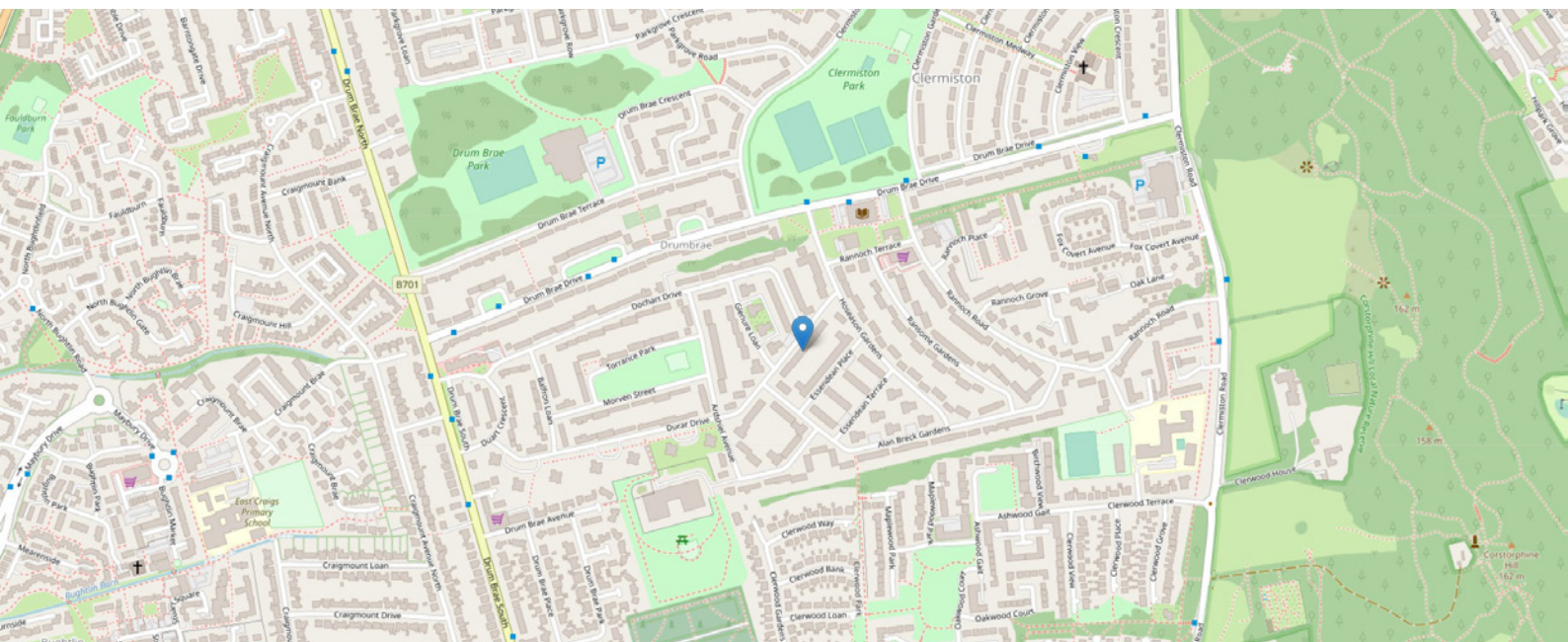



# THE LOCATION

Clermiston is a well-established residential district situated on the west side of Edinburgh. The area provides excellent local shops and amenities providing all the normal daily requirements. Drumbrae Leisure Centre is also within walking distance of the property. More extensive shopping facilities are available in Corstorphine, and this is just a five-minute drive away.







Corstorphine is considered to be one of Edinburgh's best-served shopping centres, and provides a wide choice of facilities as well as all the usual banking, building society and Post Office services. Queensferry Road leads to the Barnton Junction and this gives direct links to the west and north. Links to the major trunk routes in Scotland, the M8 and Glasgow and the M9 to the north are just a few minutes' drive away. There are also good bus links making the property in easy reach of many places including Princes St and The Gyle as well as a direct link to Edinburgh airport with the airport bus stopping across from the property. Local schools for the area include Clermiston and Fox Covert Primary Schools with The Royal High and Craigmount High School at secondary level.



# McEwan Fraser Legal

Solicitors & Estate Agents

Tel. 0131 524 9797

[www.mcewanfraserlegal.co.uk](http://www.mcewanfraserlegal.co.uk)

[info@mcewanfraserlegal.co.uk](mailto:info@mcewanfraserlegal.co.uk)



Text and description  
**CONNIE NUGENT**  
Area Sales Manager



Layout graphics and design  
**ALLY CLARK**  
Designer

**Disclaimer:** The copyright for all photographs, floorplans, graphics, written copy and images belongs to McEwan Fraser Legal and use by others or transfer to third parties is forbidden without our express consent in writing. Prospective purchasers are advised to have their interest noted through their solicitor as soon as possible in order that they may be informed in the event of an early closing date being set for the receipt of offers. These particulars do not form part of any offer and all statements and photographs contained herein are for illustrative purposes and are not guaranteed or warranted. Buyers must satisfy themselves for the accuracy and authenticity of the brochure and should always visit the property to satisfy themselves of the property's suitability and obtain in writing via their solicitor what's included with the property including any land. The dimensions provided may include, or exclude, recesses intrusions and fitted furniture. Any measurements provided are for guide purposes only and have been taken by electronic device at the widest point. Any reference to alterations to, or use of, any part of the property does not mean that any necessary planning, building regulations or other consent has been obtained. A buyer must find out by inspection or in other ways that all information is correct. None of the appliances/services stated or shown in this brochure have been tested by ourselves and none are warranted by our seller or MFL.