



  
**McEwan Fraser Legal**  
Solicitors & Estate Agents  
0141 404 5474

**Flat 4, 30 Ayr Street**  
GLASGOW, G21 4DG





## FLAT 4, 30 AYR STREET

Ayr Street is a great place to call home, with the main motorway links only 5 minutes drive away commuting by car to all parts of central Scotland is easily accessible There is a range of schools accessible within the area and plenty of options for daily household shopping within a short distance. Glasgow city centre is only 15 minutes away by public transport.

Part Exchange available. We are delighted to offer to the market this excellent two bedroom apartment, set in a quiet development in the popular area of Springburn.

The property is located in a quiet and secure position, with a great neighbourly spirit all around it, it's ideal for any first-time buyer or couples.

Accommodation consists of a bright and airy lounge/diner with large windows that flood the room with natural light. The kitchen is well appointed with a good range of modern light oak wood units with an electric cooker, hob and ample space for

a washing machine and fridge and freezer side by side. It's the perfect place for a chef to serve up a marvellous meal. The tiled bathroom is a good size and contains a white suite including a bath with an electric shower over it, ensuring there is always lots of instant hot water for long refreshing showers. There are two good sized bedrooms in this home, both of which are doubles with ample space for free standing furniture.

The home is kept warm, comfortable and secure via the double-glazing, electric convector heating and the secure door entry system. There is a communal utility back-court area and parking is to the rear and on-street to the front. The property has just recently been decorated leaving the new owners nothing to do except move in, sit down and start enjoying it. Early viewing is advised for 'canny' buy to let investors or first-time buyers looking for a great place to call home.



# FLOOR PLAN, DIMENSIONS & MAP

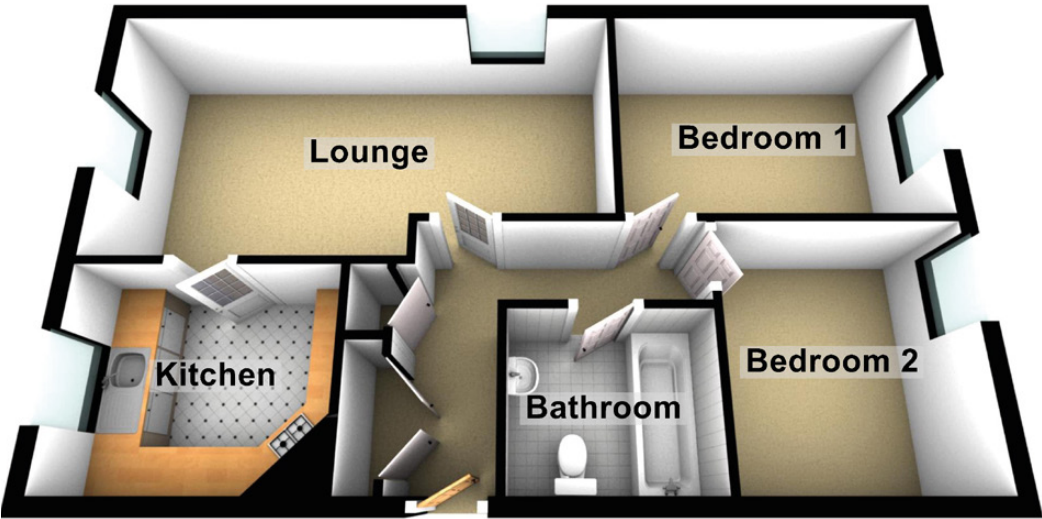

Approximate Dimensions (Taken from the widest point)

Lounge	5.90m (19'4") x 3.10m (10'2")
Kitchen	2.90m (9'6") x 2.40m (7'10")
Bedroom 1	3.70m (12'2") x 2.60m (8'6")
Bedroom 2	2.90m (9'6") x 2.70m (8'10")
Bathroom	2.20m (7'3") x 1.90m (6'3")

Gross internal floor area (m²): 55m² | EPC Rating: B

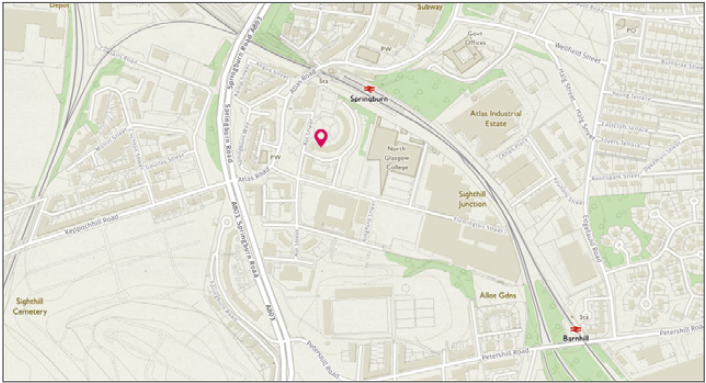

**McEwan Fraser Legal**  
Solicitors & Estate Agents

Tel. 0141 404 5474  
www.mcewanfraserlegal.co.uk  
info@mcewanfraserlegal.co.uk

Part  
Exchange  
Available

**Disclaimer :** The copyright for all photographs, floorplans, graphics, written copy and images belongs to McEwan Fraser Legal and use by others or transfer to third parties is forbidden without our express consent in writing. Prospective purchasers are advised to have their interest noted through their solicitor as soon as possible in order that they may be informed in the event of an early closing date being set for the receipt of offers. These particulars do not form part of any offer and all statements and photographs contained herein are for illustrative purposes and are not guaranteed or warranted. Buyers must satisfy themselves for the accuracy and authenticity of the brochure and should always visit the property to satisfy themselves of the property's suitability and obtain in writing via their solicitor what's included with the property including any land. The dimensions provided may include, or exclude, recesses intrusions and fitted furniture. Any measurements provided are for guide purposes only and have been taken by electronic device at the widest point. Any reference to alterations to, or use of, any part of the property does not mean that any necessary planning, building regulations or other consent has been obtained. A buyer must find out by inspection or in other ways that all information is correct. None of the appliances/services stated or shown in this brochure have been tested by ourselves and none are warranted by our seller or MFL.



Text and description  
**KEN MEISAK**  
Surveyor



Professional photography  
**GARY CORKELL**  
Photographer



Layout graphics and design  
**HAYLEY MATEAR**  
Designer