



McEwan Fraser Legal

Solicitors & Estate Agents

0141 404 5474

1/1 55 Greenhead Street

GLASGOW GREEN, GLASGOW, G40 1DG



Glasgow Green

GLASGOW, G40 1DG

This quiet, popular and beautifully designed Greenhead Street development is a selection of modern apartments overlooking Glasgow Green and the People's Palace. These lovely properties exude quality and are perfect for people who want space to live their lives. The location is perfect too, at the heart of a major regeneration initiative and only a short walk from Glasgow city centre.

Living here means residents are a mere ten minutes walk away from Glasgow city centre and some of the best shopping in the UK, not to mention outstanding nightlife as well. Closer still is the vibrant Merchant City, offering shops, restaurants, pubs and a range of great events such as the Merchant City Festival, The Jazz Festival and a farmer's market. On your doorstep, you will find more bars and restaurants as well as a gym, nursery and even a cafe with jazz music every Sunday. Glasgow Green regularly stages events such as fireworks displays, music concerts, pipe band championships and more. The People's Palace is also a hive of activity with everything from themed murder mystery evenings to exhibitions.





1/1 55 Greenhead Street

GLASGOW GREEN, GLASGOW, G40 1DG

We are delighted to offer to the market this stunning two-bedroom modern apartment, presented in absolute walk-in condition and set within a very popular, vibrant and close-to city-centre location. To say the area is on the up would be an understatement considering nearby flats have sold recently within 100 yards for over £300k.

The accommodation comprises of a bright and very spacious open plan lounge/diner, the proportions of which are excellent for a modern flat. The natural ambience of this room is evident, it just feels really peaceful and relaxed.

Galley style kitchens are always an easy and convenient space to work in and this one is very conveniently spaced out. The clean lines of the cherry wood units along with the gas hob and electric oven provide a fantastic place for any chef to serve up a marvellous meal. The kitchen area is completed with an integrated fridge freezer, washing machine and dishwasher.

There are two stylish and wonderfully bright double bedrooms in this apartment, both have built-in storage wardrobes and ample room for freestanding furniture. The master is ensuite and has a large standalone shower enclosure with a mains power shower.

The partially tiled bathroom is bright and fresh and contains a suite with a bath to soak away the cares of a long day at the office.

The handy storage cupboard off the hallway helps to ensure this apartment is always clutter-free and is kept warm and comfortable via the double glazing and gas central heating.

With city-centre living, security and convenience is always an important factor and this apartment caters well for it, with secure entry and un-allocated private parking.

From time to time a property appears on the market that is sure to be extremely popular, this is one such property as it ticks all the boxes for modern, easy living in a great close-to city-centre location. Given the close proximity to 'Glasgow Green', with all its festivals and events and all the bars, restaurants and cafes that the city centre has to offer only 10 minutes away, this is sure to be a very popular apartment. Early viewing is advised.





Specifications & Details

FLOOR PLAN, DIMENSIONS & MAP

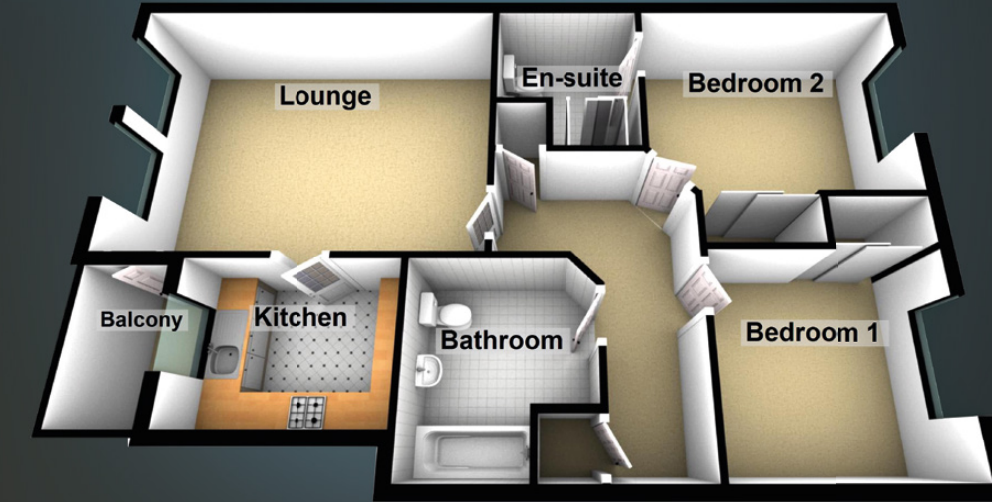

Approximate Dimensions (Taken from the widest point)

Lounge	5.30m (17'5") x 3.90m (12'10")
Balcony	2.20m (7'3") x 1.20m (3'11")
Bedroom 1	2.90m (9'6") x 2.20m (7'3")
Bedroom 2	3.11m (10'3") x 2.95m (9'8")
En-suite	2.30m (7'7") x 2.10m (6'11")
Bathroom	2.82m (9'3") x 2.50m (8'2")

Gross internal floor area (m²): 67m² | EPC Rating: B

Extras (Included in the sale): Furniture may be available by separate negotiation.

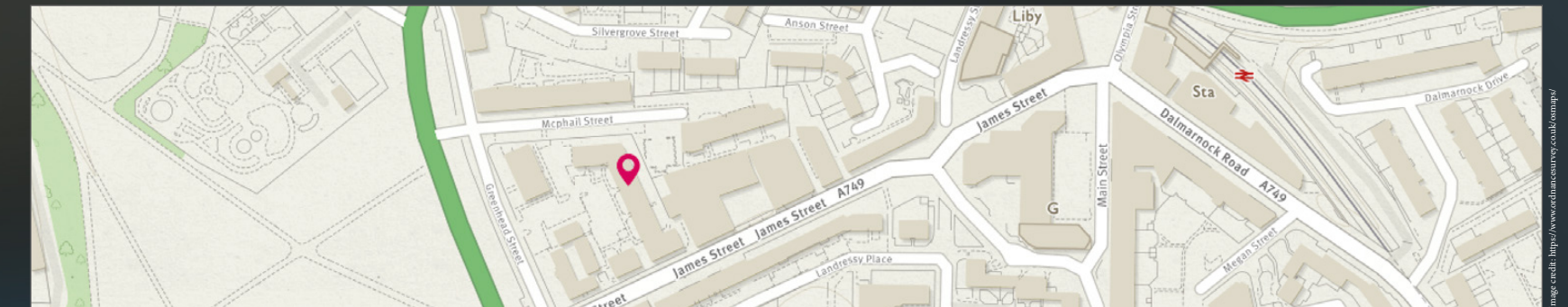

Image credit: <https://www.ordnancesurvey.co.uk/osmap/>



McEwan Fraser Legal
 Solicitors & Estate Agents

Tel. 0141 404 5474
 www.mcewanfraserlegal.co.uk
 info@mcewanfraserlegal.co.uk

**Part
 Exchange
 Available**

Disclaimer: The copyright for all photographs, floorplans, graphics, written copy and images belongs to McEwan Fraser Legal and use by others or transfer to third parties is forbidden without our express consent in writing. Prospective purchasers are advised to have their interest noted through their solicitor as soon as possible in order that they may be informed in the event of an early closing date being set for the receipt of offers. These particulars do not form part of any offer and all statements and photographs contained herein are for illustrative purposes and are not guaranteed or warranted. Buyers must satisfy themselves for the accuracy and authenticity of the brochure and should always visit the property to satisfy themselves of the property's suitability and obtain in writing via their solicitor what's included with the property including any land. The dimensions provided may include, or exclude, recesses intrusions and fitted furniture. Any measurements provided are for guide purposes only and have been taken by electronic device at the widest point. Any reference to alterations to, or use of, any part of the property does not mean that any necessary planning, building regulations or other consent has been obtained. A buyer must find out by inspection or in other ways that all information is correct. None of the appliances/services stated or shown in this brochure have been tested by ourselves and none are warranted by our seller or MFL.



Text and description
KEN MEISAK
 Surveyor



Professional photography
CRAIG DEMPSTER
 Photographer



Layout graphics and design
ALLY CLARK
 Designer