



**McEwan Fraser Legal**

Solicitors & Estate Agents

01506 537 100

## Midseat Cottage

1 EAST WHITBURN, BATHGATE, WEST LOTHIAN, EH47 8AA



## THE LOCATION

Situated approximately two miles from Whitburn Midseat Cottage provides the best in semi-rural living. Both Edinburgh and Glasgow are within very easy reach, as are Falkirk and Stirling, the Forth Bridge, and all points north. Fauldhouse Railway Station is a short drive away and from here, the trip into the very heart of Edinburgh to Waverley Station takes only a matter of twenty minutes. Local

amenities can be found in both Whitburn and Stonyburn. For more extensive shopping The Almondvale Regional Centre in Livingston provides every possible facility and service, along with the widest possible choice of shopping, all within an enclosed shopping precinct. Several shops trade on a seven-day basis. Various community high schools offer an impressive array of activities.



# MIDSEAT COTTAGE

The ideal purchaser would be those with equestrian interests, given all that it has to offer. Paddock, stables, boot room, ménage, grazing fields, outbuildings with power and light, garage and carport.

The property requires a level of modernisation internally but will easily provide for the larger family. The commercial grounds are also in need of some updating, but once up and running, this could truly be a worthy business/hobby area.

Access to the property is via the kitchen, complete with floor to ceiling units, electric hob, double oven, space for fridge freezer and ample space for a dining table. The dining room is currently being used as a family room – bright, airy and large enough for a family dining table for more informal dining with friends and family if desired. Access to the garden can also be found here. The front porch is the perfect place for unwinding and watching the world go by. The hallway provides ample storage. The lounge allows for a range of furniture configurations, is kept warm by a multi-burner stove and has French doors giving access to the garden. Just off the lounge is an office/study or a comfortable

fifth bedroom, which might suit those who require live/work arrangements. The fully tiled family bathroom comes with walk-in shower from mains, bath, wash hand basin and W/C. The bathroom also benefits from a large walk-in cupboard. There are two bedrooms on the ground floor, both bright and airy, both allowing for additional free-standing furniture. On the upper level, there are a further two bedrooms, both bright and airy and both allowing for free-standing furniture. There is a further room that could be adapted to a fifth bedroom but is currently being used as an upstairs lounge. The upstairs cloakroom completes the property internally.



*McEwan Fraser Legal are delighted to bring to the open market this four/ five bedroom detached property, with commercial workshops, surrounded by fantastic open countryside on a plot of circa 8 acres.*







# THE DETAILS

Approximate Dimensions (Taken from the widest point)

Lounge	6.38m (20'11") x 5.17m (17')
Sitting Room	5.50m (18'1") x 3.30m (10'10")
Kitchen	5.50m (18'1") x 3.87m (12'8")
Master Bedroom	5.93m (19'5") x 4.42m (14'6")
Bedroom 2	5.00m (16'5") x 3.30m (10'10")
Study	3.30m (10'10") x 2.48m (8'2")
Sun Room	3.64m (11'11") x 2.75m (9')
Bathroom	3.20m (10'6") x 2.78m (9'1")
Bedroom 3	3.90m (12'10") x 2.00m (6'7")
Bedroom 4	5.46m (17'11") x 3.56m (11'8")
Bedroom 5	4.00m (13'1") x 3.90m (12'10")
WC	1.60m (5'3") x 1.30m (4'3")

Gross internal floor area (m<sup>2</sup>): 245m<sup>2</sup> | EPC Rating: F



Externally the property has a spacious yard with workshops for industrial use. The yard is located to the rear of the cottage, enjoying a southerly outlook to open countryside and beyond. The paddock lies behind the yard and stretches northwards from the cottages towards



the Bickerton Burn. A bridle path runs along the eastern boundary of the property.

The property also benefits from oil fired heating and a mixture of single and double-glazed units.

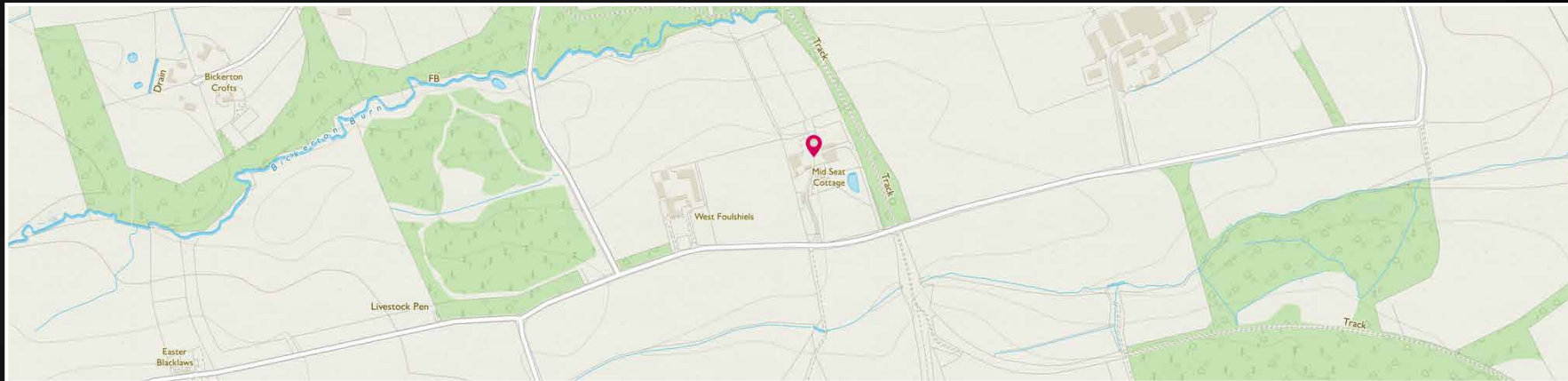
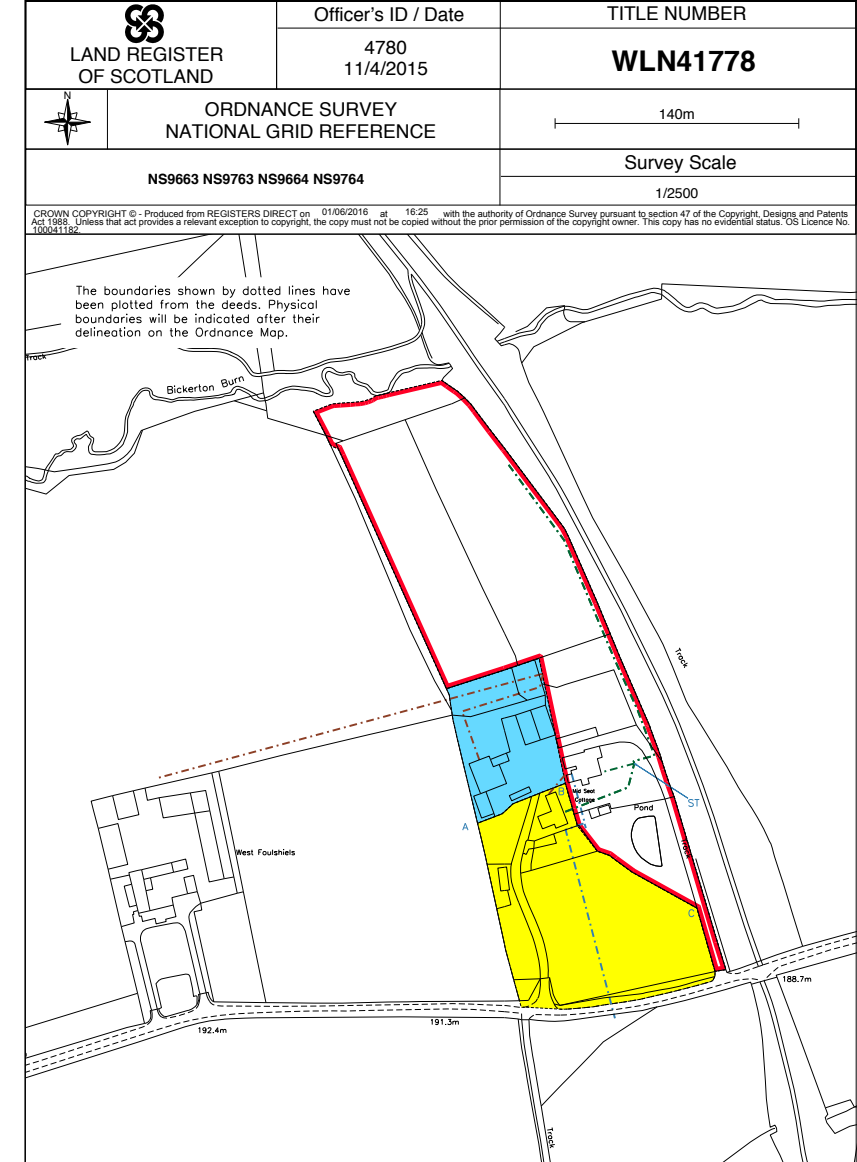



  
**McEwan Fraser Legal**  
 Solicitors & Estate Agents

Tel. 01506 537 100  
 www.mcewanfraserlegal.co.uk  
 info@mcewanfraserlegal.co.uk

**Part  
 Exchange  
 Available**

**Disclaimer:** The copyright for all photographs, floorplans, graphics, written copy and images belongs to McEwan Fraser Legal and use by others or transfer to third parties is forbidden without our express consent in writing. Prospective purchasers are advised to have their interest noted through their solicitor as soon as possible in order that they may be informed in the event of an early closing date being set for the receipt of offers. These particulars do not form part of any offer and all statements and photographs contained herein are for illustrative purposes and are not guaranteed or warranted. Buyers must satisfy themselves for the accuracy and authenticity of the brochure and should always visit the property to satisfy themselves of the property's suitability and obtain in writing via their solicitor what's included with the property including any land. The dimensions provided may include, or exclude, recesses intrusions and fitted furniture. Any measurements provided are for guide purposes only and have been taken by electronic device at the widest point. Any reference to alterations to, or use of, any part of the property does not mean that any necessary planning, building regulations or other consent has been obtained. A buyer must find out by inspection or in other ways that all information is correct. None of the appliances/services stated or shown in this brochure have been tested by ourselves and none are warranted by our seller or MFL.



Text and description  
**GRAEME NIMMO**  
 Surveyor



Professional photography  
**ROSS MCBRIDE**  
 Photographer



Layout graphics and design  
**ALAN SUTHERLAND**  
 Designer