

23 Chuckers Row

WALLYFORD, EAST LoTHIAN, EH21 8JP



*SPACIOUS TWO BEDROOM MID TERRACED HOUSE
FORMING PART OF A GOLDEN SHARED EQUITY SCHEME*



0131 524 9797



www.mcewanfraserlegal.co.uk



info@mcewanfraserlegal.co.uk



McEwan Fraser Legal
is delighted to present
this two-bedroom
mid-terraced house in
Wallyford, East Lothian.

Inside, the property
comprises a living area
which is bright and
spacious and offers
various possible furniture
configurations. There is
a fully equipped kitchen
which leads to the private,
landscaped rear garden.
The kitchen is fitted with
a gas hob, fan oven and
free-standing white goods.







There are two generous double bedrooms with built-in storage. The house has a main three-piece modern white bathroom suite on the first floor and a WC accessed off the side of the kitchen in the property. Making the most of all the space on offer.





Bedroom 2





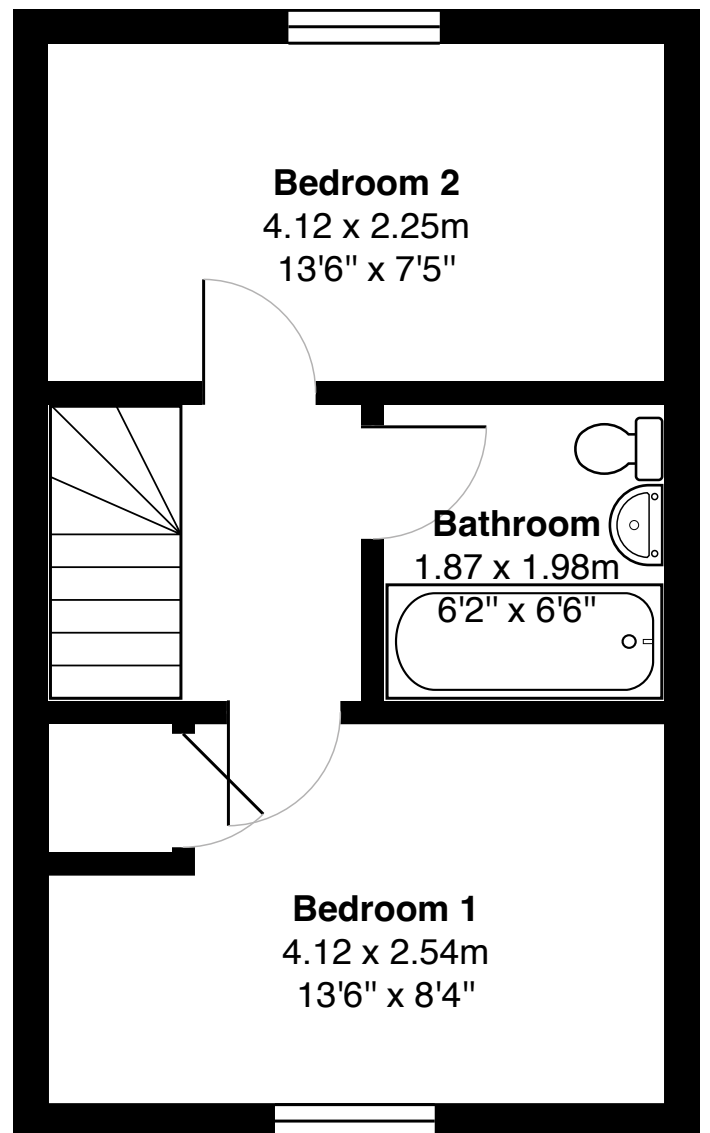
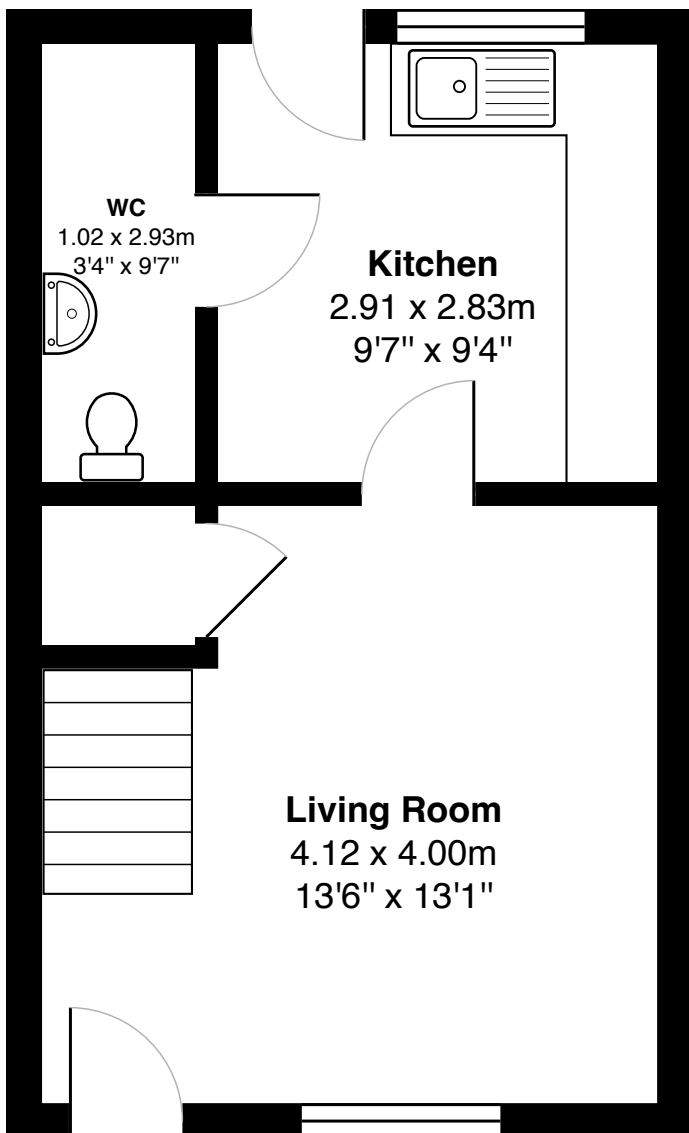

Gross internal floor area (m²): 56m²

EPC Rating: B



In addition to this, the property includes modern gas central heating, residents' parking and modern double glazing. This property is part of a shared equity scheme with Golden Share and is being sold at a reduced % of ownership. Enquire for more information.



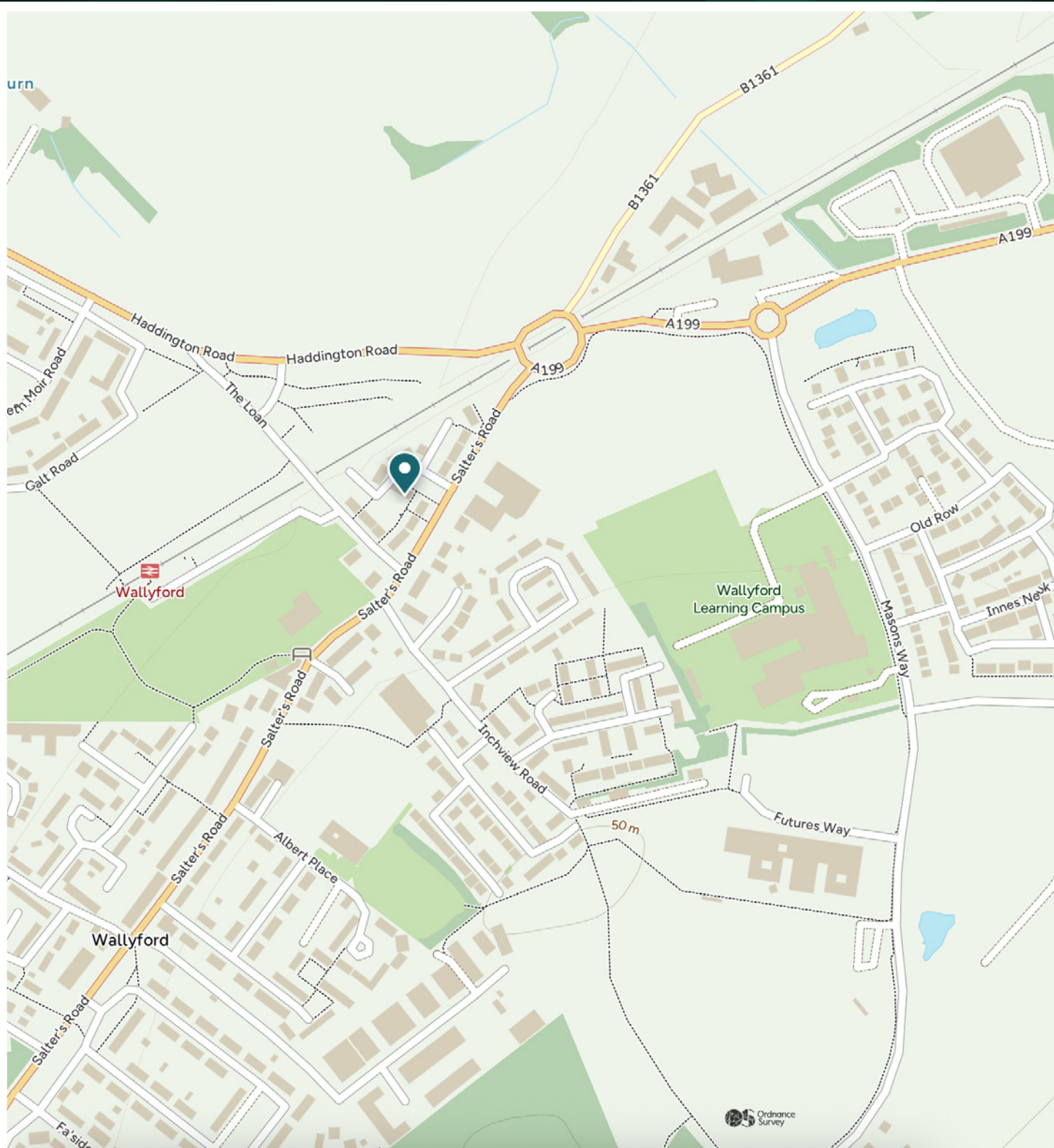

McEwan Fraser Legal

Solicitors & Estate Agents

Tel. 0131 524 9797

www.mcewanfraserlegal.co.uk

info@mcewanfraserlegal.co.uk

Part
Exchange
Available



THE SUNDAY TIMES
THE SUNDAY TIMES



Text and description
BEN STEWART CLARK
Area Sales Manager



Professional photography
MARK BRYCE
Photographer



Layout graphics and design
ALAN SUTHERLAND
Designer

Disclaimer: The copyright for all photographs, floorplans, graphics, written copy and images belongs to McEwan Fraser Legal and use by others or transfer to third parties is forbidden without our express consent in writing. Prospective purchasers are advised to have their interest noted through their solicitor as soon as possible in order that they may be informed in the event of an early closing date being set for the receipt of offers. These particulars do not form part of any offer and all statements and photographs contained herein are for illustrative purposes and are not guaranteed or warranted. Buyers must satisfy themselves for the accuracy and authenticity of the brochure and should always visit the property to satisfy themselves of the property's suitability and obtain in writing via their solicitor what's included with the property including any land. The dimensions provided may include, or exclude, recesses intrusions and fitted furniture. Any measurements provided are for guide purposes only and have been taken by electronic device at the widest point. Any reference to alterations to, or use of, any part of the property does not mean that any necessary planning, building regulations or other consent has been obtained. A buyer must find out by inspection or in other ways that all information is correct. None of the appliances/services stated or shown in this brochure have been tested by ourselves and none are warranted by our seller or MFL.