



**McEwan Fraser Legal**

Solicitors & Estate Agents

0131 524 9797

**14/6 The Gallolee**

EDINBURGH, EH13 9QJ

# The Location

EDINBURGH, EH13 9QJ

Colinton is considered to be one of Edinburgh's most popular areas and is situated on the south side of the city. The area displays a wide variety of property styles, with the majority of properties being upper and lower villas.

Colinton is well served by a number of local shops, and these will provide most daily requirements as well as Post Office and banking services. There are also a number of specialised shops, as well as restaurants and bars. There is a Morrisons and a Tesco, each just a short distance away.

Using one of the many and frequent bus services that pass through the district, the city centre can generally be reached in a matter of twenty to thirty minutes. Edinburgh's formal entertainment facilities tend to be highly concentrated in the city centre. Here you will find a variety of theatres, cinemas, all manner of restaurants bars, and buildings of historic with architectural interest.

Colinton is surrounded by a number of lovely public parks and golf courses. There are also delightful walks along Colinton Dell, the Water of Leith and the Braid Burn. Braid and Blackford Hills are within easy reach. The world-famous Hillend dry ski-slope is just a short drive away and next door to this are beautiful walks through the Pentland Hills, with panoramic views of the city.



# 14/6 The Gallolee

EDINBURGH, EH13 9QJ

An excellent opportunity has arisen to acquire this well-presented two-bedroom, second-floor flat, situated in a quiet residential area located on the south side of the city.

Internally the accommodation is in excellent decorative order and briefly consists of a welcoming entrance hallway which features an entry phone system for added security. The hallway also features a sliding wardrobe.

The living room features ample space for free-standing furniture while also providing space for both dining and entertaining. The fitted kitchen features many integrated appliances, including a hob, oven, extractor hood, dishwasher and fridge freezer.

There are two double bedrooms, with the master bedroom featuring built-in mirrored wardrobes. Finally, there is the three-piece family bathroom with an electric shower over the bath. The property further benefits from double-glazed windows and electric heating throughout.

Externally the the communal landscaped gardens complete the surrounding grounds.

This development and location have great appeal and would, therefore, be an ideal property for any city professional or premium Buy-To-Let investor.

Early viewing is highly recommended for this property will appeal to a variety of buyers.





# Specifications & Details

FLOOR PLAN, DIMENSIONS & MAP

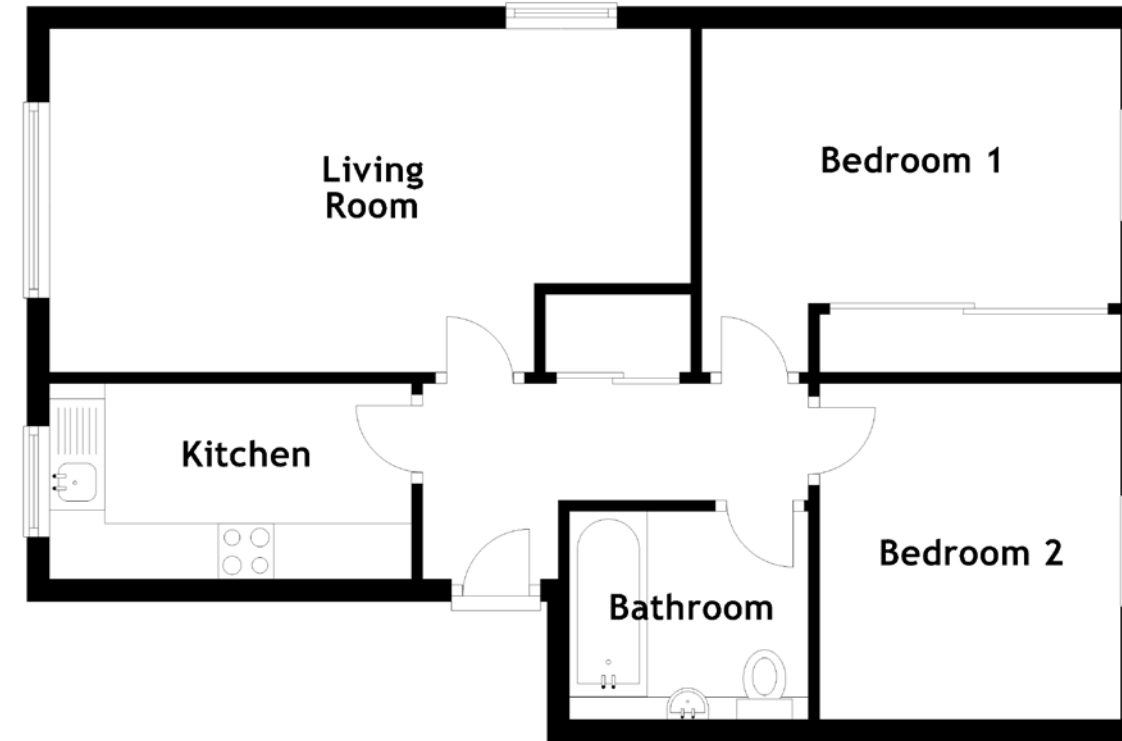

Approximate Dimensions  
(Taken from the widest point)

Living Room	5.77m (18'11") x 3.09m (10'2")
Kitchen	3.26m (10'8") x 1.76m (5'9")
Bedroom 1	3.77m (12'4") x 3.09m (10'2")
Bedroom 2	3.02m (9'11") x 2.71m (8'11")
Bathroom	2.15m (7'1") x 1.87m (6'2")

Gross internal floor area (m<sup>2</sup>): 54m<sup>2</sup>  
EPC Rating: C

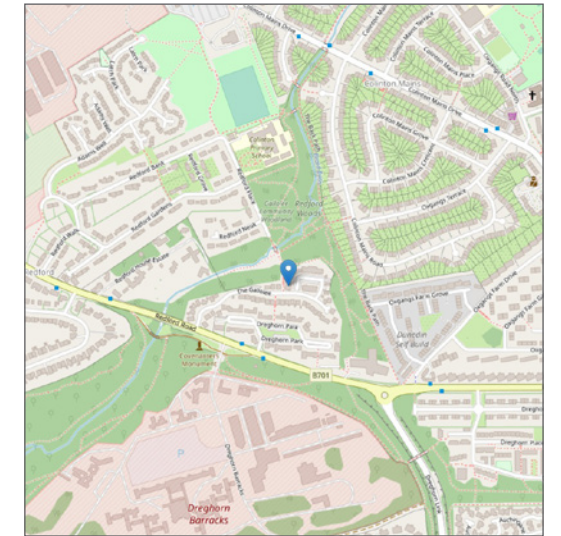



View from bedroom 2

# McEwan Fraser Legal

Solicitors & Estate Agents

Tel. 0131 524 9797  
www.mcewanfraserlegal.co.uk  
info@mcewanfraserlegal.co.uk

Part  
Exchange  
Available

**Disclaimer:** The copyright for all photographs, floorplans, graphics, written copy and images belongs to McEwan Fraser Legal and use by others or transfer to third parties is forbidden without our express consent in writing. Prospective purchasers are advised to have their interest noted through their solicitor as soon as possible in order that they may be informed in the event of an early closing date being set for the receipt of offers. These particulars do not form part of any offer and all statements and photographs contained herein are for illustrative purposes and are not guaranteed or warranted. Buyers must satisfy themselves for the accuracy and authenticity of the brochure and should always visit the property to satisfy themselves of the property's suitability and obtain in writing via their solicitor what's included with the property including any land. The dimensions provided may include, or exclude, recesses intrusions and fitted furniture. Any measurements provided are for guide purposes only and have been taken by electronic device at the widest point. Any reference to alterations to, or use of, any part of the property does not mean that any necessary planning, building regulations or other consent has been obtained. A buyer must find out by inspection or in other ways that all information is correct. None of the appliances/services stated or shown in this brochure have been tested by ourselves and none are warranted by our seller or MFL.



Text and description  
**ANDREW DARCY**  
Surveyor



Layout graphics and design  
**ALLY CLARK**  
Designer