

33 Manse Road

HOPEMAN, MORAYSHIRE, IV30 5TA



*BEAUTIFULLY PRESENTED 2-BEDROOM
SEMI-DETACHED BUNGALOW*



01542 280 444



www.mcewanfraserlegal.co.uk



info@mcewanfraserlegal.co.uk





Set in the heart of the highly sought-after coastal village of Hopeman, Moray, this beautifully presented 2-bedroom semi-detached bungalow for sale offers stylish, move-in-ready living. This new build bungalow in Hopeman (2025) has been built to a high specification by Tulloch of Cummingston and is ideal for buyers seeking a modern home near the Moray coast.

Perfectly positioned in a desirable residential area, this modern bungalow in Hopeman is ideal for downsizers, first-time buyers, retirees, or those looking for a coastal property in Moray, Scotland, within easy reach of local amenities, beaches and scenic walks.

Step inside this bungalow to discover a bright and spacious lounge, flooded with natural light, creating a warm and relaxing living space.



The modern fitted kitchen with garden access offers excellent storage and worktop space, ideal for everyday living, dining and entertaining, with direct access to the rear garden.





The property further comprises this well-laid-out 2-bedroom bungalow with driveway in Hopeman:

- Two well-proportioned bedrooms
- Contemporary shower room
- Private driveway with parking for two vehicles





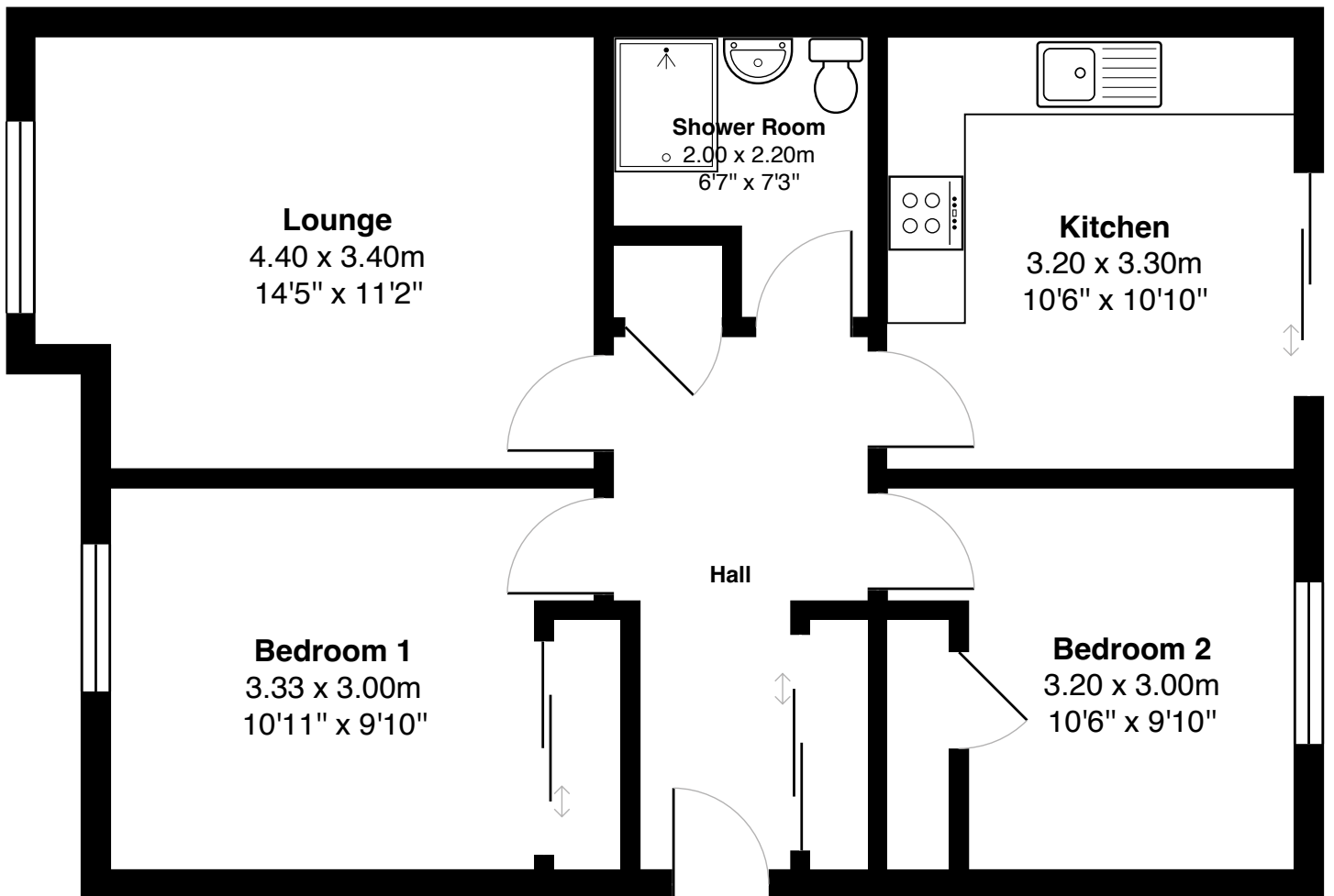

Gross internal floor area (m²): 61m²

EPC Rating: C



Externally, this property for sale in Hopeman benefits from a private rear garden space, ideal for outdoor seating, low-maintenance landscaping or family use.

Combining modern comfort with a fantastic village location close to shops, schools, transport links and the stunning Moray coastline, this is a superb opportunity to acquire a turnkey bungalow in Hopeman, perfect as a main residence, retirement property or coastal home in Scotland.

Early viewing is highly recommended to fully appreciate all that this property has to offer.

The Property



Located on the beautiful shores of the Moray Firth, the popular coastal village of Hopeman is one of Moray's most sought-after seaside locations, known for its stunning beaches, welcoming community and relaxed pace of life.

The village enjoys a picturesque harbour and two sandy beaches, including Hopeman East Beach, recognised in the Good Beach Guide, making it ideal for families, coastal walks and water sports. Hopeman also benefits from a well-regarded links course at Hopeman Golf Club, popular with both locals and visitors.

Everyday amenities are well catered for within the village, including local shops, a Post Office and primary schooling, while a wider range of facilities can be found in the nearby cathedral city of Elgin, just a short drive away, offering supermarkets, restaurants, leisure facilities and secondary education. The city of Inverness is also within easy reach, providing excellent transport links including rail and airport connections.

Surrounded by the wider Moray coastline, famous for its fishing villages and scenic beauty, and within reach of the Cairngorms National Park, Hopeman offers an exceptional balance of coastal living and accessibility, making it an ideal location for a range of buyers.





McEwan Fraser Legal

Solicitors & Estate Agents

Tel. 01542 280 444

www.mcewanfraserlegal.co.uk

info@mcewanfraserlegal.co.uk



Text and description
CRAIG PETERS
Surveyor



Layout graphics and design
ALAN SUTHERLAND
Designer

Disclaimer: The copyright for all photographs, floorplans, graphics, written copy and images belongs to McEwan Fraser Legal and use by others or transfer to third parties is forbidden without our express consent in writing. Prospective purchasers are advised to have their interest noted through their solicitor as soon as possible in order that they may be informed in the event of an early closing date being set for the receipt of offers. These particulars do not form part of any offer and all statements and photographs contained herein are for illustrative purposes and are not guaranteed or warranted. Buyers must satisfy themselves for the accuracy and authenticity of the brochure and should always visit the property to satisfy themselves of the property's suitability and obtain in writing via their solicitor what's included with the property including any land. The dimensions provided may include, or exclude, recesses intrusions and fitted furniture. Any measurements provided are for guide purposes only and have been taken by electronic device at the widest point. Any reference to alterations to, or use of, any part of the property does not mean that any necessary planning, building regulations or other consent has been obtained. A buyer must find out by inspection or in other ways that all information is correct. None of the appliances/services stated or shown in this brochure have been tested by ourselves and none are warranted by our seller or MFL.