



McEwan Fraser Legal
Solicitors & Estate Agents
0141 404 5474

166 Hardridge Road
GLASGOW, G52 1RJ

166 HARDRIDGE ROAD

We are delighted to bring to the market this lovely three bedroom semi detached home, set in the popular family-friendly development of Maxwell Gate. The development is already well known for its neighbourly spirit and some of the traditional values that make a street a real community are alive here; everybody actually knows each other and the streets are safe for the children to play out in peace.

This lovely home makes a perfect place to raise a family and is presented in good condition.

The accommodation boasts a bright and spacious lounge, which given its shape would suit a range of furniture configurations. The kitchen/diner is perfect for the home, finished in a lovely range of light oak wood fitted units, with an electric oven, gas hob, and integrated fridge freezer. It all helps to make it a great space for the chef to serve up the family favourites. The dining area benefits from lots of natural light that floods in from the

patio doors and which lead out beautifully to the rear garden and decked area. The downstairs WC is a handy feature for any busy family home.

The tiled bathroom is both bright and fresh, finished in a white suite. There are three good sized bedrooms in this lovely home, all have ample space for free-standing furniture.

The home is kept warm and comfortable via the double glazing and gas central heating. The garden space is also a real feature, low maintenance, secure, and child-friendly. On sunnier days the large tiered deck area offers a great place to relax, unwind and enjoy a glass of wine at the end of a hard day.

This home would make an ideal buy for any young couple or family, alternatively it would make a solid investment property for any smart Buy-To-Let investor. Early viewing is strongly advised for anyone looking for a great family property.



PROPERTY SPECIFICATIONS

Approximate Dimensions (Taken from the widest point)

Lounge	4.20m (13'9") x 3.70m (12'2")
Kitchen/ Dining Room	5.70m (18'8") x 2.60m (8'6")
Bedroom 1	3.58m (11'9") x 3.20m (10'6")
Bedroom 2	3.60m (11'10") x 2.10m (6'11")
Bedroom 3	2.64m (8'8") x 2.00m (6'7")
Bathroom	2.10m (6'11") x 2.00m (6'7")
WC	1.50m (4'11") x 1.02m (3'4")

Gross internal floor area (m²)

85m²

EPC Rating

C

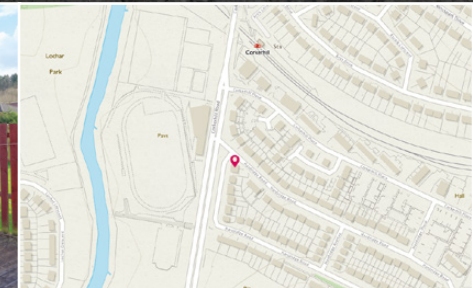
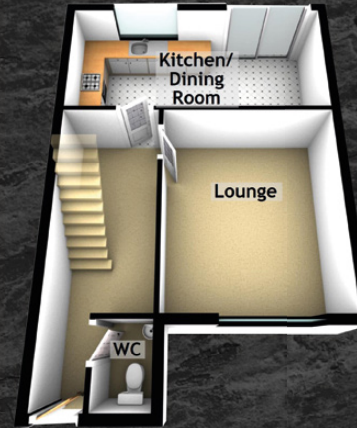

McEwan Fraser Legal
Solicitors & Estate Agents

Tel. 0141 404 5474
www.mcewanfraserlegal.co.uk
info@mcewanfraserlegal.co.uk

Part
Exchange
Available

Disclaimer : The copyright for all photographs, floorplans, graphics, written copy and images belongs to McEwan Fraser Legal and use by others or transfer to third parties is forbidden without our express consent in writing. Prospective purchasers are advised to have their interest noted through their solicitor as soon as possible in order that they may be informed in the event of an early closing date being set for the receipt of offers. These particulars do not form part of any offer and all statements and photographs contained herein are for illustrative purposes and are not guaranteed or warranted. Buyers must satisfy themselves for the accuracy and authenticity of the brochure and should always visit the property to satisfy themselves of the property's suitability and obtain in writing via their solicitor what's included with the property including any land. The dimensions provided may include, or exclude, recesses intrusions and fitted furniture. Any measurements provided are for guide purposes only and have been taken by electronic device at the widest point. Any reference to alterations to, or use of, any part of the property does not mean that any necessary planning, building regulations or other consent has been obtained. A buyer must find out by inspection or in other ways that all information is correct. None of the appliances/services stated or shown in this brochure have been tested by ourselves and none are warranted by our seller or MFL.



Text and description
KEN MEISAK
Surveyor



Professional photography
CRAIG DEMPSTER
Photographer



Layout graphics and design
BEN DAYKIN
Designer

Image credit: <http://www.outlinecurry.co.uk/comps/>