



McEwan Fraser Legal

Solicitors & Estate Agents

01698 537 177

25 Champion Road

MOTHERWELL, NORTH LANARKSHIRE, ML1 1DR

The large and bustling town of Motherwell in North Lanarkshire, with its population of approximately 59,000, has come a long way from simply being the steel-producing powerhouse of Scotland. Today with its state of the art Motherwell College and its well-renowned schools it is a great place to call home.

Centrally based, with excellent bus, rail and motorway links to the M74 and the M8 it truly is a prime location for living, commuting and enjoying life. Strathclyde Country park and Chatlerault are very close at hand for relaxing walks and a short car journey on the motorway takes you to the heart of some of Scotland best shopping centres.

MOTHERWELL, NORTH LANARKSHIRE, MLI IDR

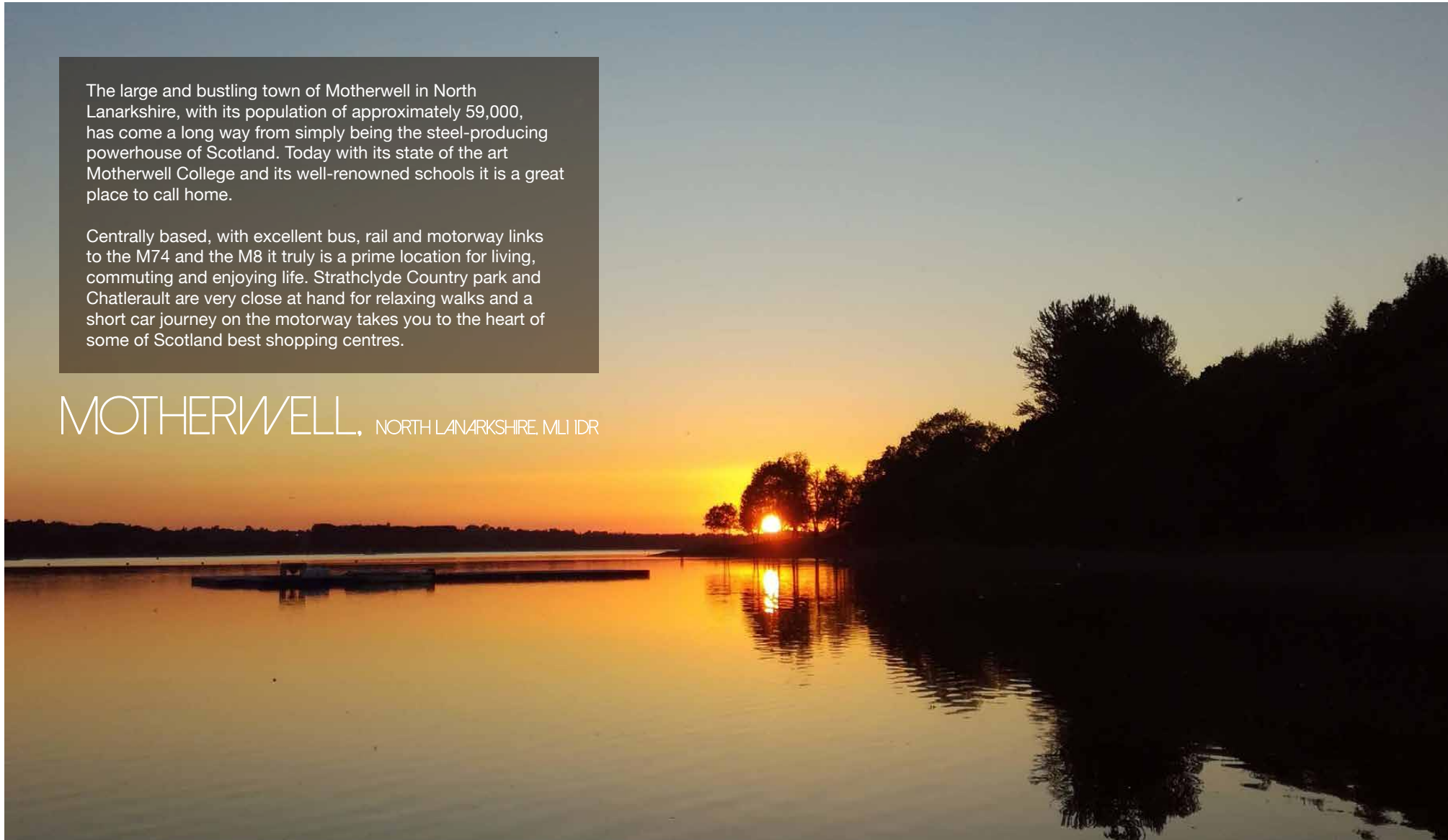

McEwan Fraser is delighted to present this fantastic two double bedroom mid terraced house to the market. An ideal starter home, the property is presented in excellent internal order and internal viewing is highly recommended.

Accommodation is focused towards a striking reception room. Neutrally decorated and boasting laminate flooring, there is ample space for a full suite and plenty of additional furniture. The lounge leads into a modern dining kitchen. There is a full range of base and wall mounted units with plenty of prep and storage space. Gas hob and electric oven are integrated and there is space for further free standing appliances. Climbing the stairs, there are two well presented double bedroom which both include integrated wardrobes. Internal accommodation is completed by a modern bathroom which is fully tiled and boasts a three-piece suite with shower over bath. For extra warmth and comfort, there is gas central heating and double glazing throughout.

Externally, there is parking to the front and a good-sized rear garden which is part patio and part lawn.

25 CAMPION ROAD





SPECIFICATIONS & DETAILS

FLOOR PLAN, DIMENSIONS & MAP

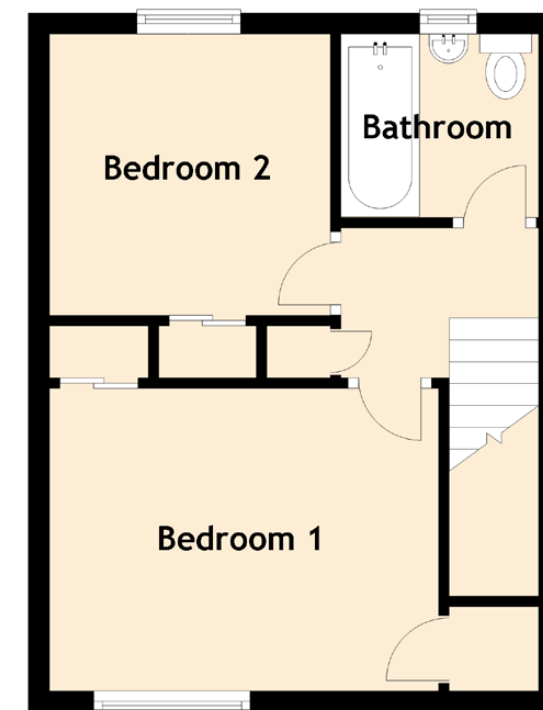
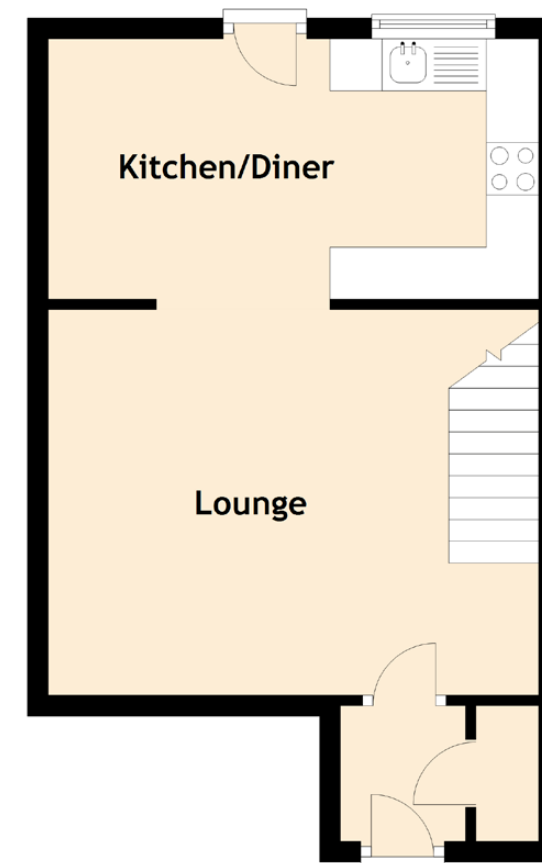

Approximate Dimensions (Taken from the widest point)

| | |
|---------------|-------------------------------|
| Lounge | 4.70m (15'5") x 3.70m (12'2") |
| Kitchen/Diner | 4.70m (15'5") x 2.50m (8'2") |
| Bedroom 1 | 3.74m (12'3") x 2.90m (9'6") |
| Bedroom 2 | 2.70m (8'10") x 2.70m (8'10") |
| Bathroom | 1.90m (6'3") x 1.90m (6'3") |

Gross internal floor area (m²): 63m² | EPC Rating: C

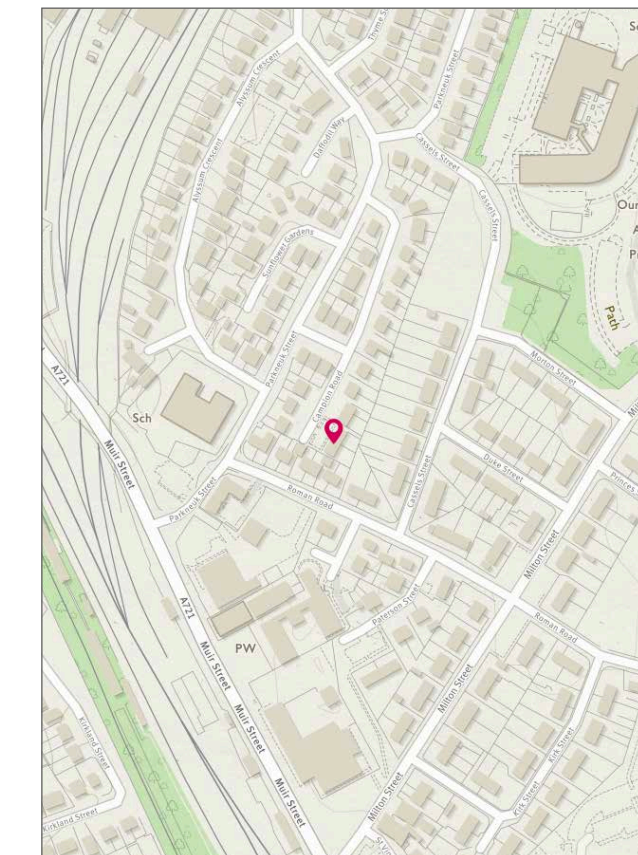



McEwan Fraser Legal
Solicitors & Estate Agents

Tel. 01698 537 177
www.mcewanfraserlegal.co.uk
info@mcewanfraserlegal.co.uk

Part
Exchange
Available

Disclaimer: The copyright for all photographs, floorplans, graphics, written copy and images belongs to McEwan Fraser Legal and use by others or transfer to third parties is forbidden without our express consent in writing. Prospective purchasers are advised to have their interest noted through their solicitor as soon as possible in order that they may be informed in the event of an early closing date being set for the receipt of offers. These particulars do not form part of any offer and all statements and photographs contained herein are for illustrative purposes and are not guaranteed or warranted. Buyers must satisfy themselves for the accuracy and authenticity of the brochure and should always visit the property to satisfy themselves of the property's suitability and obtain in writing via their solicitor what's included with the property including any land. The dimensions provided may include, or exclude, recesses intrusions and fitted furniture. Any measurements provided are for guide purposes only and have been taken by electronic device at the widest point. Any reference to alterations to, or use of, any part of the property does not mean that any necessary planning, building regulations or other consent has been obtained. A buyer must find out by inspection or in other ways that all information is correct. None of the appliances/services stated or shown in this brochure have been tested by ourselves and none are warranted by our seller or MFL.



Text and description
MICHAEL MCMULLAN
Surveyor



Professional photography
CRAIG DEMPSTER
Photographer



Layout graphics and design
ALLY CLARK
Designer

