



McEwan Fraser Legal

Solicitors & Estate Agents

0131 524 9797

2F2, 1 Largo Place

EDINBURGH, EH6 4AG

LOCATION

EDINBURGH, EH6 4AG

Many would consider Edinburgh's Leith area to be one of the City's most up and coming areas. It is an established, independent community which is very much self-contained.

There is an excellent choice of places to eat and drink, several places of entertainment and a bright lively atmosphere. In addition, Leith has its own amenities with several surgeries and a choice of dentists. The Shore area of Leith, which is situated on either side of the Water of Leith as it approaches the sea, has become a particularly fashionable area. Nearby Ocean Terminal also has a number of high street retailers, restaurants and even a cinema.

From here, it is also a simple matter of a walk into the City Centre, with the option of using one of the many and frequent bus services that use this route. Leith is also perfectly located for ease of travel to many parts of the city and beyond. Ferry Road gives access to the west as well as routes out to the east. In both these directions, there are direct links with the City Bypass.



2F2, 1 LARGO PLACE

EDINBURGH, EH6 4AG

... A FANTASTIC PROJECT ...”

McEwan Fraser Legal is delighted to present this generous one bedroom second floor flat to the market.

The property requires significant internal upgrading and could easily be reconfigured as a two-bedroom apartment inline the other properties in the building (subject to necessary consents).

Current accommodation comprises en-suite bedroom, lounge and dining room with recessed kitchen.

This is a fantastic project and viewing is highly recommended.





SPECIFICATIONS & DETAILS

FLOOR PLAN, DIMENSIONS & MAP

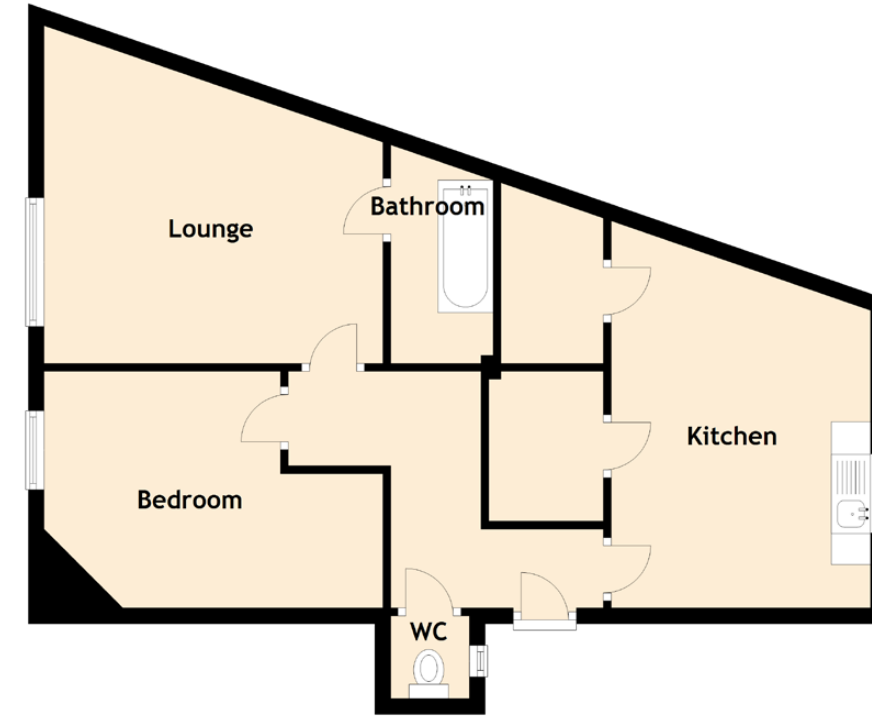

Approximate Dimensions
(Taken from the widest point)

Lounge	4.30m (14'1") x 4.30m (14'1")
Kitchen	4.21m (13'10") x 3.30m (10'10")
Bedroom	4.30m (14'1") x 3.00m (9'10")
Bathroom	2.80m (9'2") x 1.30m (4'3")
WC	1.05m (3'5") x 1.00m (3'3")

Gross internal floor area (m²): 56m²

EPC Rating: D

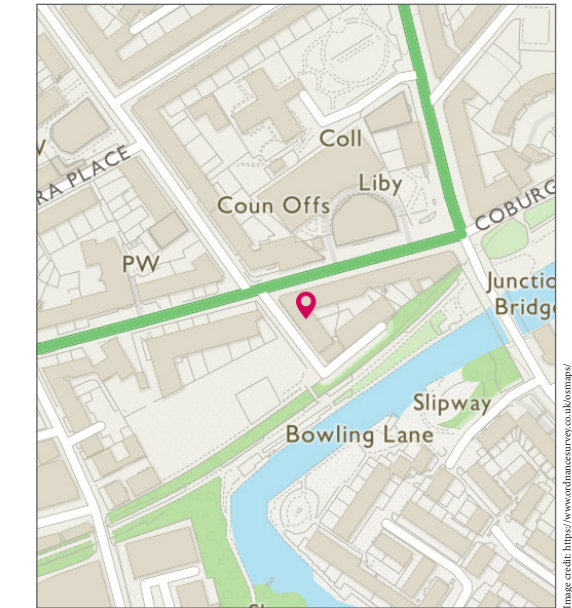

Image credit: <https://www.dummeasures.co.uk/maps/>



McEwan Fraser Legal
Solicitors & Estate Agents

Tel. 0131 524 9797
www.mcewanfraserlegal.co.uk
info@mcewanfraserlegal.co.uk

**Part
Exchange
Available**

Disclaimer: The copyright for all photographs, floorplans, graphics, written copy and images belongs to McEwan Fraser Legal and use by others or transfer to third parties is forbidden without our express consent in writing. Prospective purchasers are advised to have their interest noted through their solicitor as soon as possible in order that they may be informed in the event of an early closing date being set for the receipt of offers. These particulars do not form part of any offer and all statements and photographs contained herein are for illustrative purposes and are not guaranteed or warranted. Buyers must satisfy themselves for the accuracy and authenticity of the brochure and should always visit the property to satisfy themselves of the property's suitability and obtain in writing via their solicitor what's included with the property including any land. The dimensions provided may include, or exclude, recesses intrusions and fitted furniture. Any measurements provided are for guide purposes only and have been taken by electronic device at the widest point. Any reference to alterations to, or use of, any part of the property does not mean that any necessary planning, building regulations or other consent has been obtained. A buyer must find out by inspection or in other ways that all information is correct. None of the appliances/services stated or shown in this brochure have been tested by ourselves and none are warranted by our seller or MFL.



Text and description
MICHAEL MCMULLAN
Surveyor



Professional photography
CRAIG DEMPSTER
Photographer



Layout graphics and design
ALLY CLARK
Designer