

# The Stores

THE HARBOUR, BURGHEAD, ELGIN, IV30 5UJ



*Former workshop and stores site, now presenting a highly desirable residential development prospect (with the correct consents) in the heart of Burghead*



01542 280 444



[www.mcewanfraserlegal.co.uk](http://www.mcewanfraserlegal.co.uk)



[info@mcewanfraserlegal.co.uk](mailto:info@mcewanfraserlegal.co.uk)



McEwan Fraser Legal is delighted to present an exceptional opportunity to acquire a former workshop and stores site, now presenting a highly desirable residential development prospect (with the correct consents) in the heart of Burghead.

Perfectly positioned right on the harbour, this unique plot enjoys uninterrupted, panoramic views across the harbour and out to the stunning Moray Firth. The setting offers a rare combination of coastal charm, tranquillity, and strong development potential.

# THE SITE



Previously used for workshop and storage purposes, the site is now ideally suited for redevelopment, subject to the appropriate consents. With its enviable waterfront location and spectacular outlook, this plot lends itself perfectly to a bespoke residential scheme, whether a luxury single dwelling or an exclusive development project.

Burghead is a sought-after coastal village, rich in history and character, with local amenities and a growing appeal among those seeking scenic living by the sea.



### Key Features:

- Prime harbour front location
- Exceptional views over Burghead Harbour and the Moray Firth
- Former workshop and stores site
- Strong residential development potential (subject to planning consents)
- Rare coastal plot in a desirable village setting

Opportunities of this nature and position are seldom available. Early interest is highly recommended.

# FLOOR PLAN & DIMENSIONS

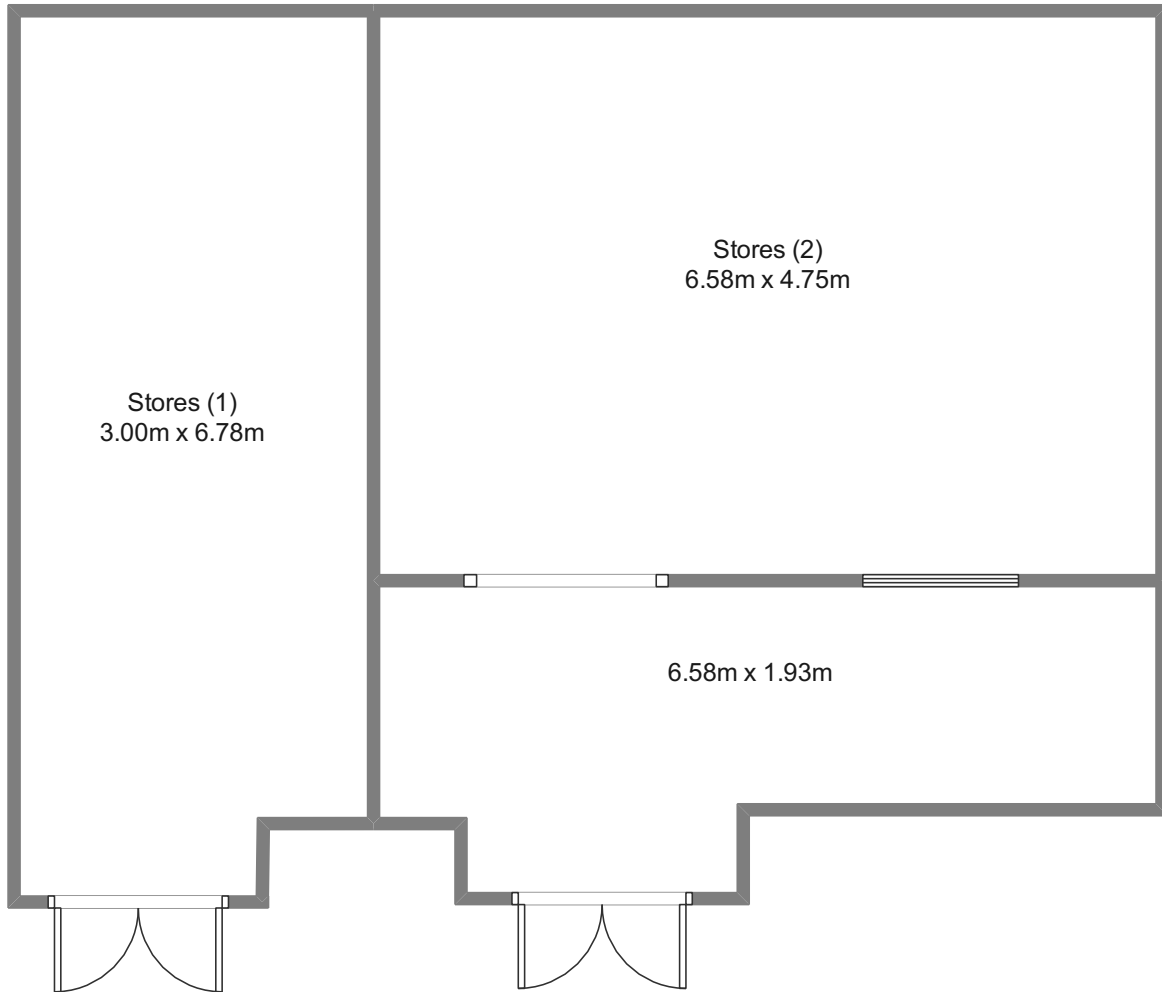

Approximate Dimensions (Taken from the widest point)

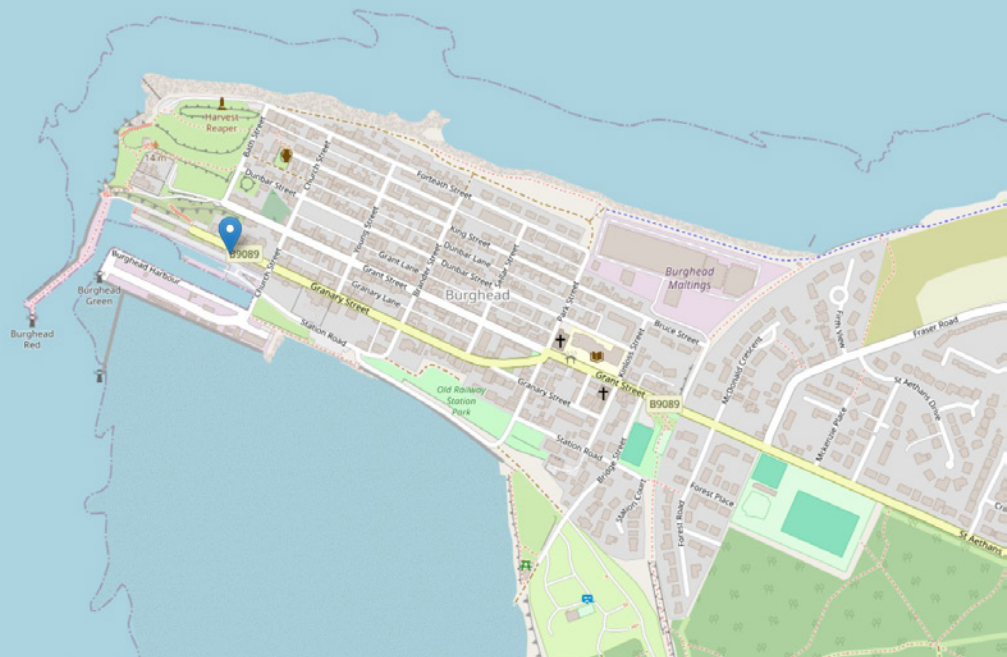

# THE LOCATION

Burghead Harbour, located in the historic coastal village of Burghead, is one of the most distinctive and picturesque waterfront settings along Scotland's northeast coast. Steeped in maritime heritage, the harbour remains an active and characterful focal point of the village, offering an authentic coastal atmosphere with a strong sense of community.





Positioned on a promontory extending into the Moray Firth, the harbour benefits from far-reaching sea views and spectacular sunsets across the water. The area is well known for its wildlife, including frequent dolphin sightings, adding to its appeal as a tranquil yet engaging seaside location.

Burghead itself offers a selection of local amenities, including shops, cafés, and traditional pubs, while the larger town of Elgin is just a short drive away, providing a wider range of services, schooling, and transport links.

Combining natural beauty, rich history, and a peaceful coastal lifestyle, Burghead Harbour represents a highly desirable location for residential living or development.



**McEwan Fraser Legal**

Solicitors & Estate Agents

Tel. 01542 280 444

[www.mcewanfraserlegal.co.uk](http://www.mcewanfraserlegal.co.uk)

[info@mcewanfraserlegal.co.uk](mailto:info@mcewanfraserlegal.co.uk)

Part  
Exchange  
Available



Text and description  
**CONNIE NUGENT**  
Commercial Valuer



Layout graphics and design  
**ALLY CLARK**  
Designer

**Disclaimer:** The copyright for all photographs, floorplans, graphics, written copy and images belongs to McEwan Fraser Legal and use by others or transfer to third parties is forbidden without our express consent in writing. Prospective purchasers are advised to have their interest noted through their solicitor as soon as possible in order that they may be informed in the event of an early closing date being set for the receipt of offers. These particulars do not form part of any offer and all statements and photographs contained herein are for illustrative purposes and are not guaranteed or warranted. Buyers must satisfy themselves for the accuracy and authenticity of the brochure and should always visit the property to satisfy themselves of the property's suitability and obtain in writing via their solicitor what's included with the property including any land. The dimensions provided may include, or exclude, recesses intrusions and fitted furniture. Any measurements provided are for guide purposes only and have been taken by electronic device at the widest point. Any reference to alterations to, or use of, any part of the property does not mean that any necessary planning, building regulations or other consent has been obtained. A buyer must find out by inspection or in other ways that all information is correct. None of the appliances/services stated or shown in this brochure have been tested by ourselves and none are warranted by our seller or MFL.