

Fairview, 32 Seafield Street

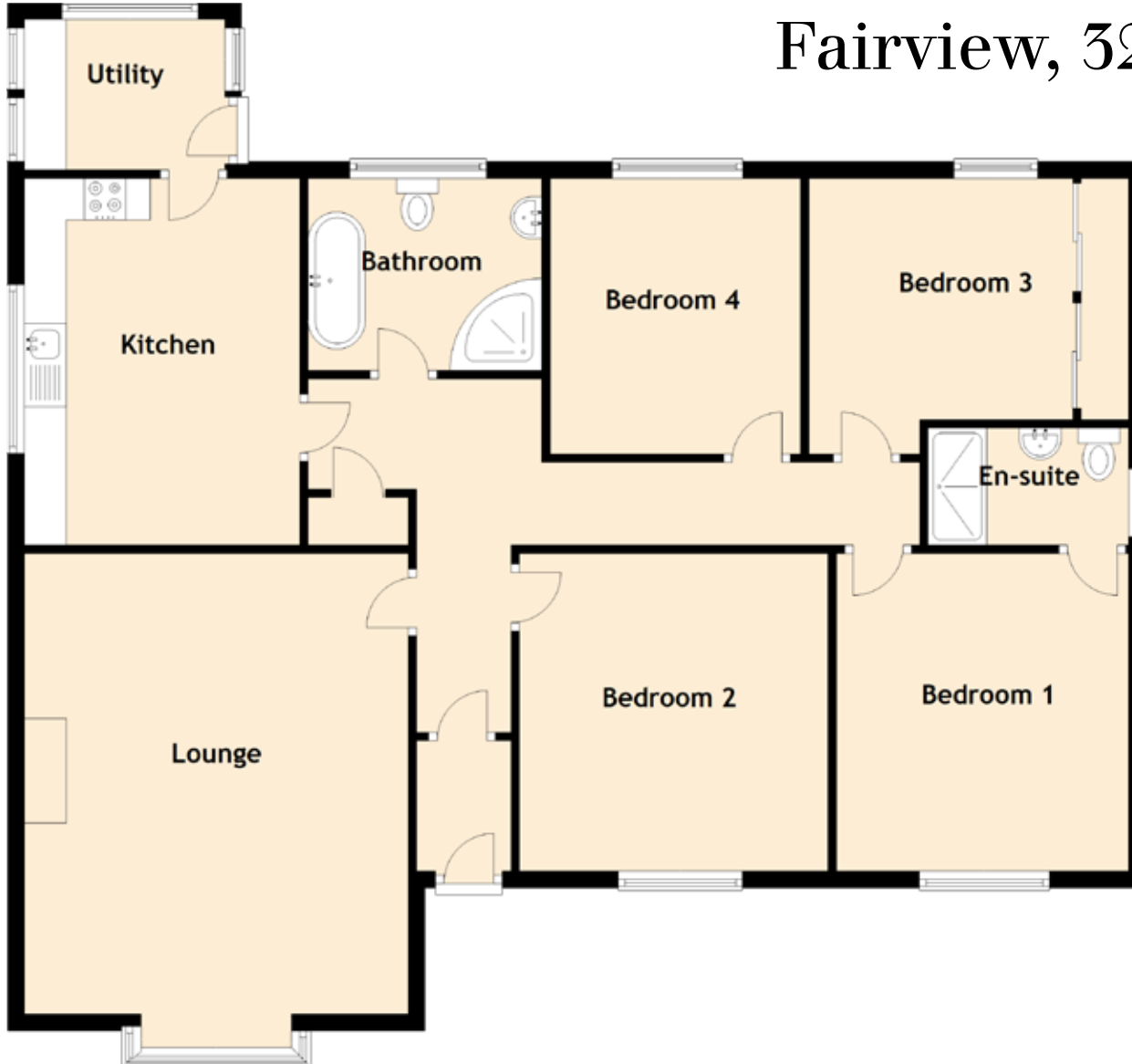

Approximate Dimensions
(Taken from the widest point)

Lounge	5.51m (18'1") x 4.60m (15'1")
Kitchen	4.40m (14'5") x 3.30m (10'10")
Utility	2.40m (7'10") x 1.80m (5'11")
Bedroom 1	3.80m (12'6") x 3.50m (11'6")
En-suite	2.40m (7'10") x 1.40m (4'7")
Bedroom 2	3.80m (12'6") x 3.70m (12'2")
Bedroom 3	2.80m (9'2") x 2.50m (8'2")
Bedroom 4	3.30m (10'10") x 3.00m (9'10")
Bathroom	2.80m (9'2") x 2.30m (7'7")

Gross internal floor area (m²): 135m²

EPC Rating: D