

Flat 15, 28 Simpson Loan

QUARTERMILE, EDINBURGH, EH3 9GG

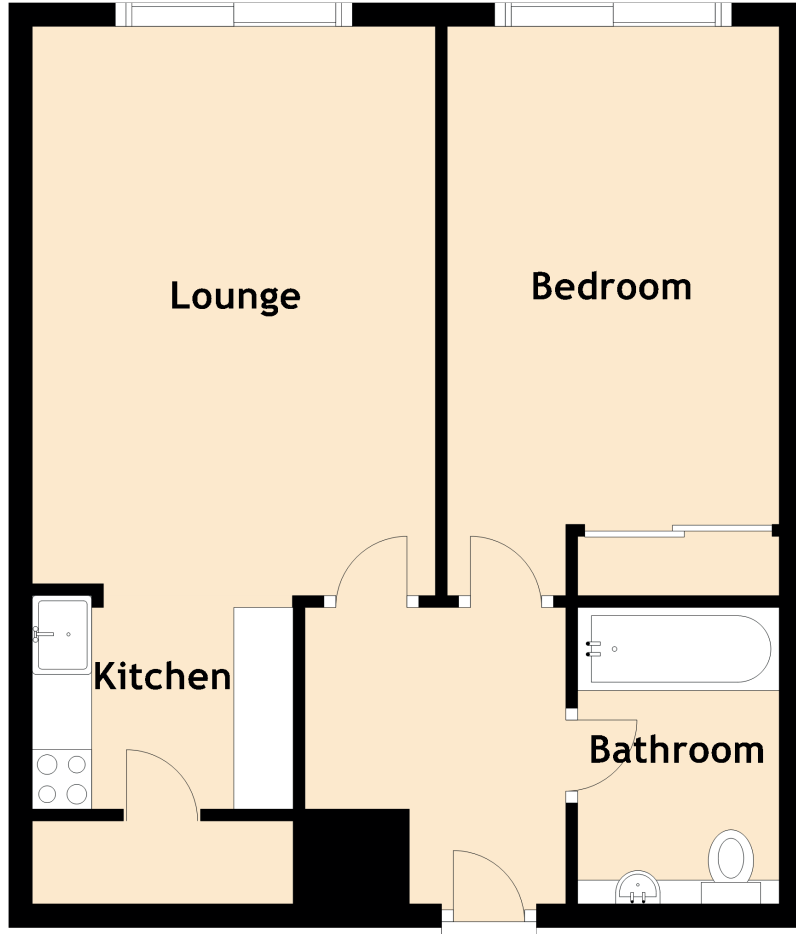

Approximate Dimensions (Taken from the widest point)

Lounge	4.80m (15'9") x 3.40m (11'2")
Kitchen	2.20m (7'3") x 1.80m (5'11")
Bedroom	4.80m (15'9") x 2.80m (9'2")
Bathroom	2.50m (8'2") x 1.70m (5'7")