

FLOOR PLAN, DIMENSIONS & MAP

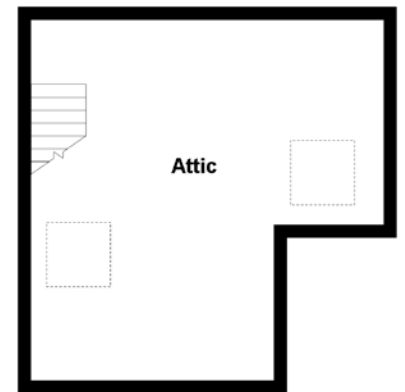
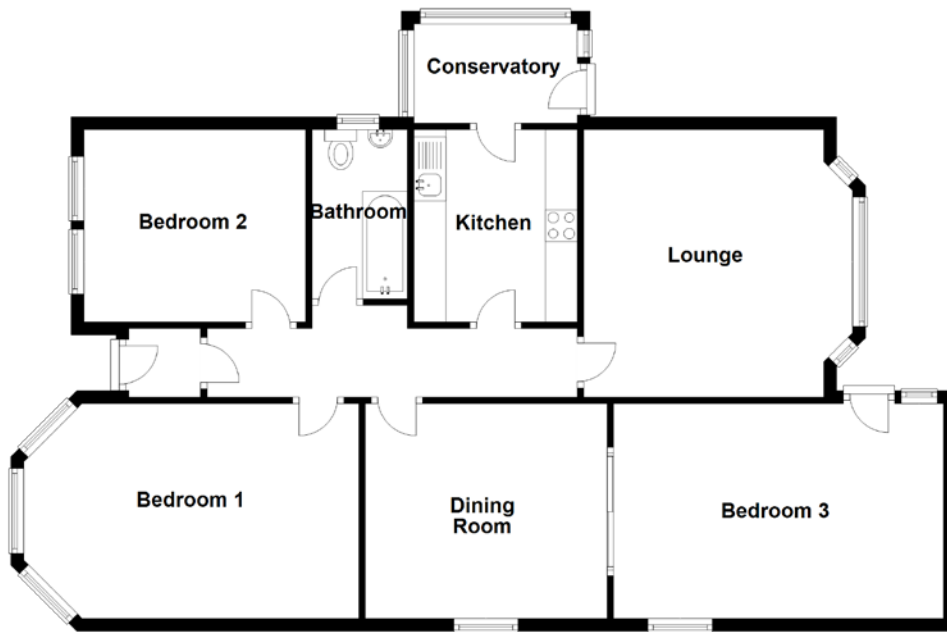

Approximate Dimensions (Taken from the widest point)

Lounge	4.54m (14'11") x 4.20m (13'9")
Kitchen	3.20m (10'6") x 2.55m (8'4")
Conservatory	2.50m (8'2") x 1.55m (5'1")
Dining Room	3.78m (12'5") x 3.64m (11'11")
Bedroom 1	5.23m (17'2") x 3.45m (11'4")

Bedroom 2	3.46m (11'4") x 3.00m (9'10")
Bedroom 3	5.15m (16'11") x 3.35m (11')
Bathroom	2.64m (8'8") x 1.49m (4'11")
Attic	5.62m (18'5") x 5.51m (18'1")

Gross internal floor area (m²): 104m²
EPC Rating: D

