

15J Fraser Place

ABERDEEN, AB25 3YA

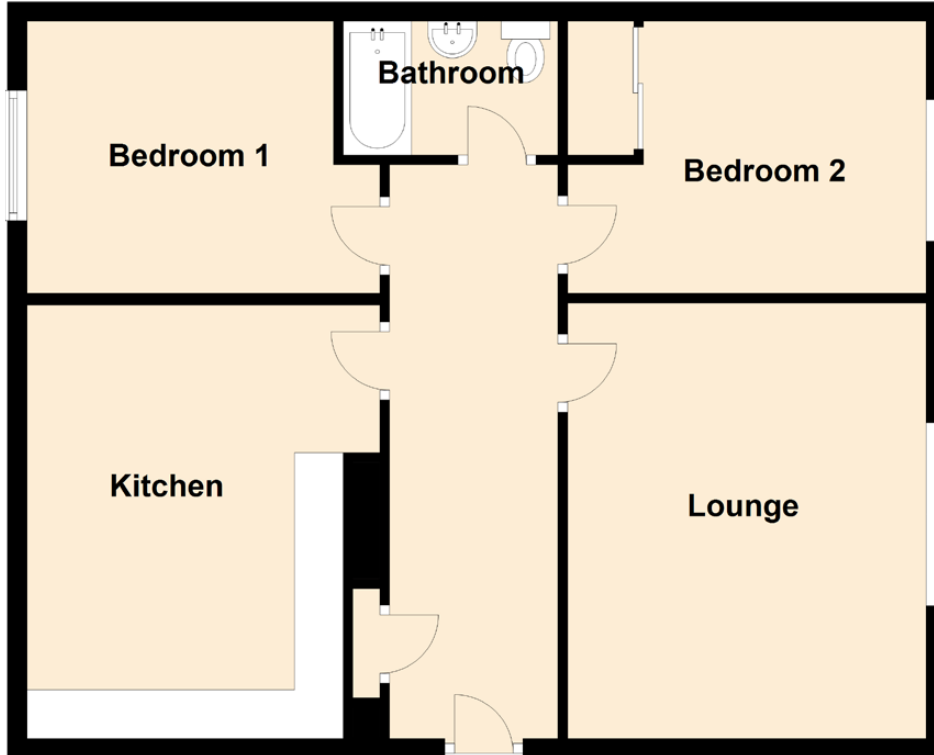

Approximate Dimensions (Taken from the widest point)

Lounge	3.70m (12'2") x 3.67m (12')
Kitchen	3.83m (12'7") x 3.42m (11'3")
Bedroom 1	3.42m (11'3") x 3.14m (10'4")
Bedroom 2	3.67m (12') x 3.00m (9'10")
Bathroom	2.20m (7'3") x 1.37m (4'6")

Gross internal floor area (m²): 62m² | EPC Rating: D