

# 8 Rhinds Place

BALLIESTON, GLASGOW, G69 7NE

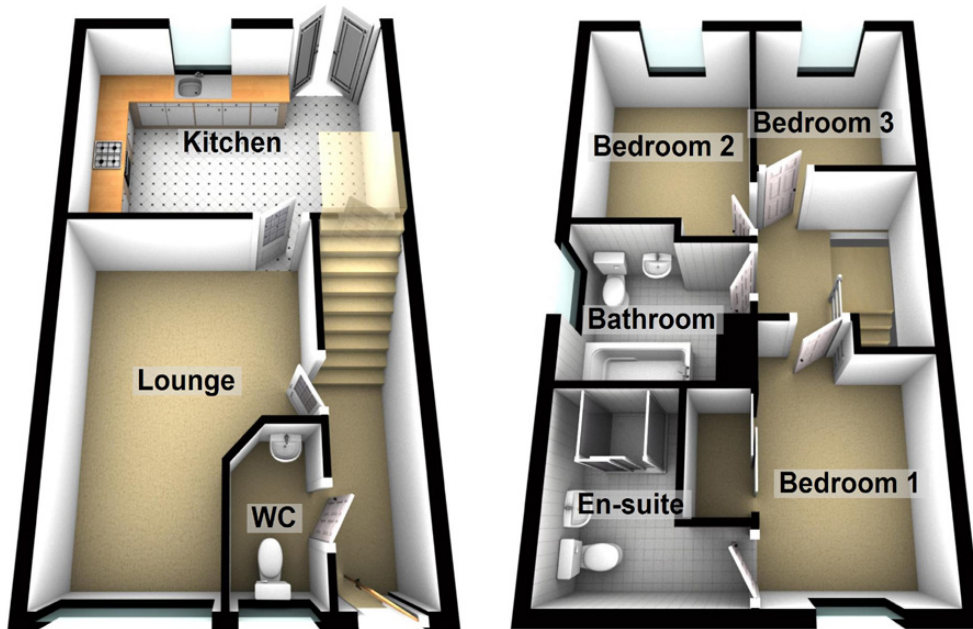

Approximate Dimensions (Taken from the widest point)

Lounge	4.70m (15'5") x 3.70m (12'2")
Kitchen	4.70m (15'5") x 3.10m (10'2")
WC	2.10m (6'11") x 1.20m (3'11")
Bedroom 1	3.26m (10'8") x 2.30m (7'7")
En-suite	2.40m (7'10") x 1.70m (5'7")
Bedroom 2	3.10m (10'2") x 2.50m (8'2")
Bedroom 3	2.30m (7'7") x 2.30m (7'7")
Bathroom	2.40m (7'10") x 2.10m (6'11")