

1/2, 298 Possil Road

GLASGOW, G4 9SX

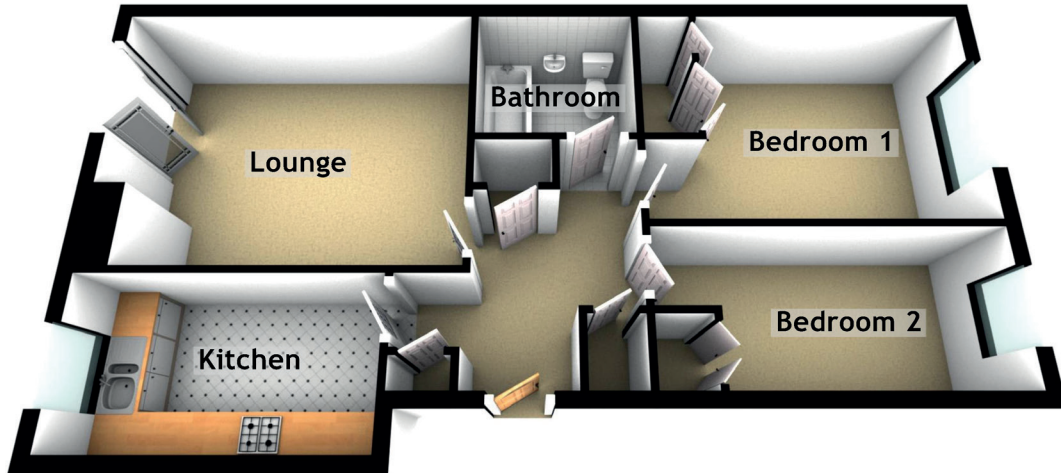

Approximate Dimensions
(Taken from the widest point)

Lounge	4.70m (15'5") x 3.60m (11'10")
Kitchen	3.77m (12'5") x 2.10m (6'11")
Bedroom 1	4.40m (14'5") x 3.00m (9'10")
Bedroom 2	4.40m (14'5") x 2.00m (6'7")
Bathroom	2.10m (6'11") x 1.80m (5'11")