

Specifications

Approximate Dimensions (Taken from the widest point)

Lounge	7.17m (23'6") x 5.22m (17'2")
Kitchen	4.13m (13'7") x 3.79m (12'5")
Utility	3.17m (10'5") x 1.99m (6'6")
Dining Room	4.45m (14'7") x 3.79m (12'5")
Sun Room	6.54m (21'5") x 3.60m (11'10")
Bedroom 1	5.24m (17'2") x 3.34m (10'11")
En-suite	1.75m (5'9") x 1.75m (5'9")
Bedroom 2	6.43m (21'1") x 3.77m (12'4")
En-suite	3.75m (12'4") x 1.98m (6'6")
Bedroom 3	5.39m (17'8") x 2.70m (8'10")
Bedroom 4	3.17m (10'5") x 2.15m (7'1")
Bedroom 5	3.69m (12'1") x 3.20m (10'6")
Bathroom	2.54m (8'4") x 1.52m (5')
Pool	10.30m (33'10") x 6.00m (19'8")

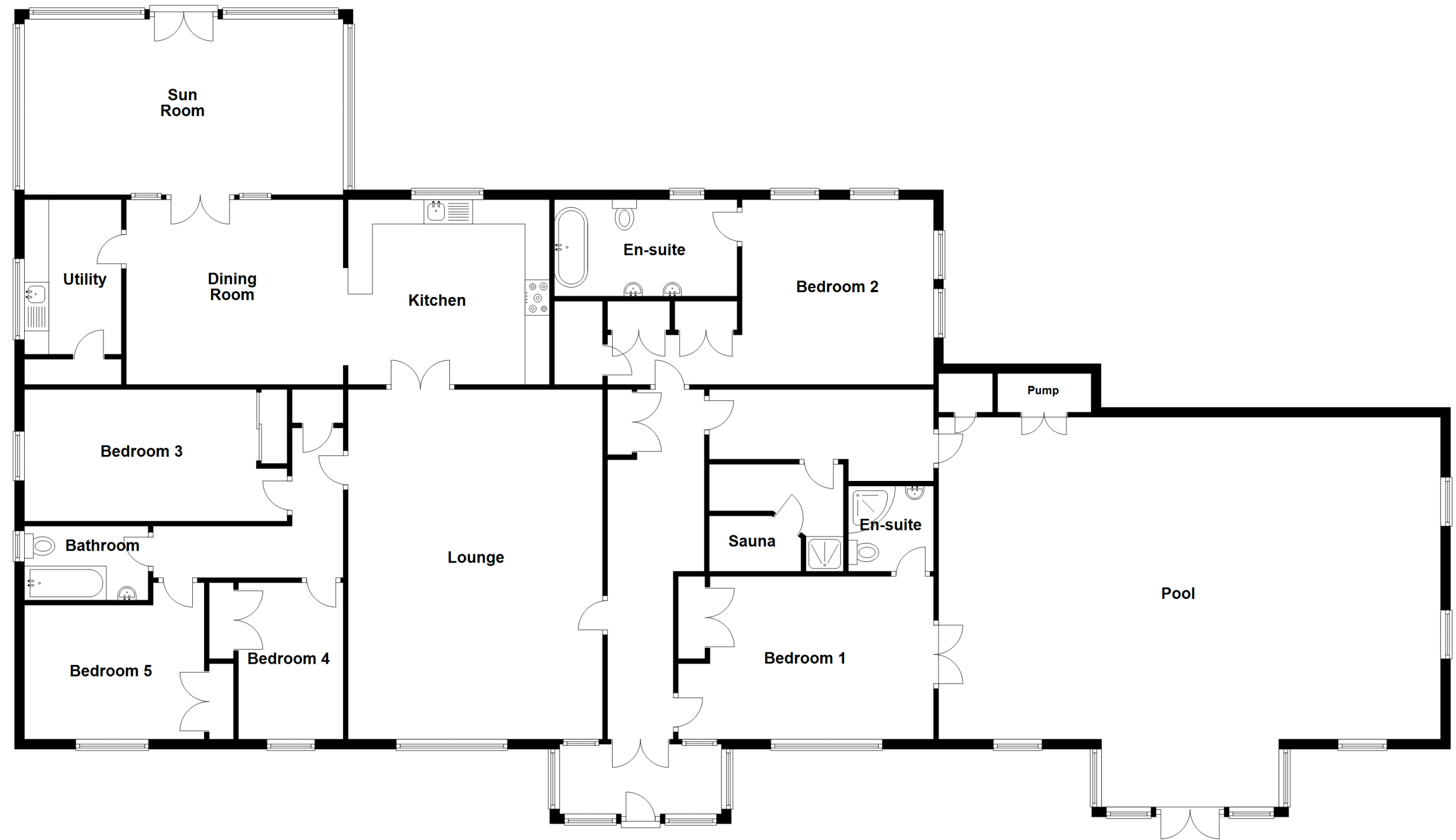

Specifications

Approximate Dimensions (Taken from the widest point)

Office	3.11m (10'2") x 2.35m (7'9")
Treatment Room 1	4.20m (13'9") x 2.20m (7'3")
Treatment Room 2	4.20m (13'9") x 2.20m (7'3")
Treatment Room 3	4.20m (13'9") x 2.20m (7'3")
Bedroom	7.32m (24') x 4.68m (15'4")
En-suite	4.22m (13'10") x 1.79m (5'10")

