

# FLOOR PLAN, DIMENSIONS & MAP

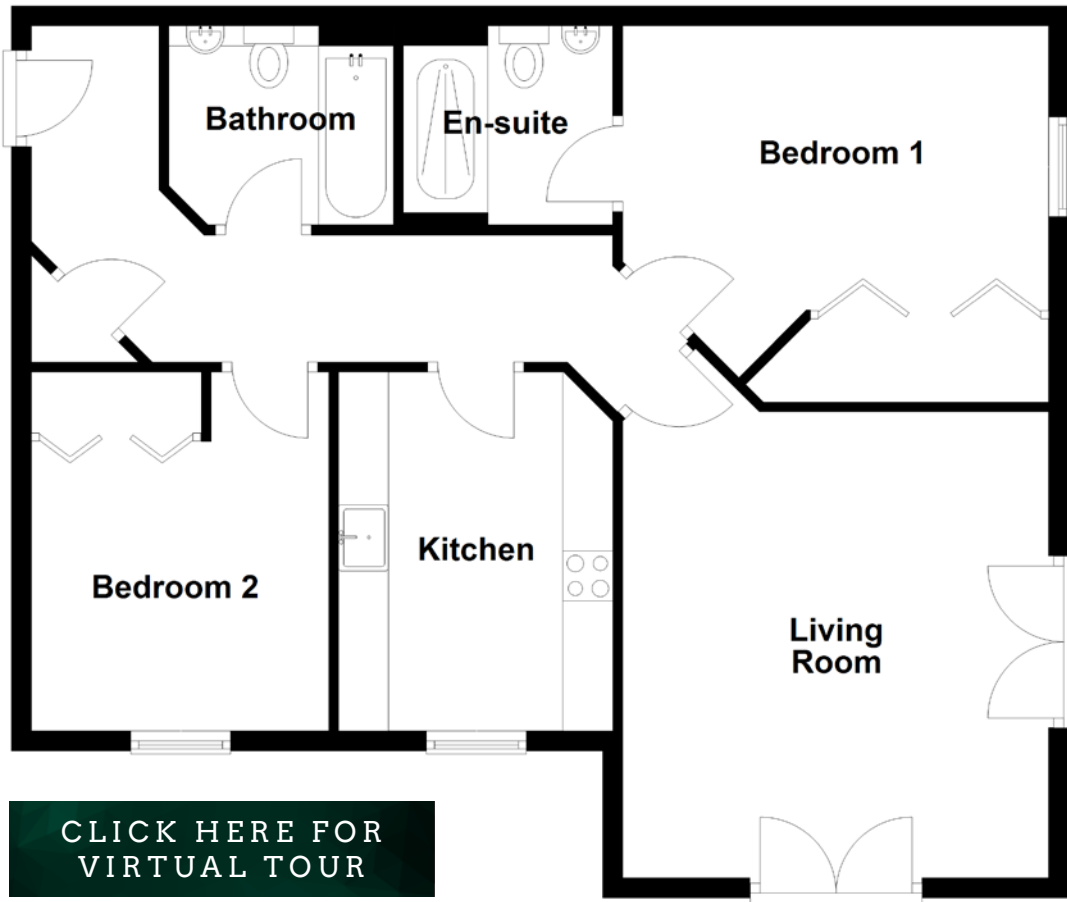

Approximate Dimensions (Taken from the widest point)

Living Room      4.68m (15'4") x 4.30m (14'1")  
 Kitchen      3.60m (11'10") x 2.75m (9')  
 Bathroom      2.25m (7'5") x 2.00m (6'7")

Bedroom 1      4.27m (14') x 3.54m (11'8")  
 En-suite      2.10m (6'11") x 2.00m (6'7")  
 Bedroom 2      3.60m (11'10") x 2.98m (9'9")

Gross internal floor area (m<sup>2</sup>): 85m<sup>2</sup> | EPC Rating: B

