

# 50 Blaikies Mews

ALEXANDER STREET, DUNDEE, ANGUS, DD3 7UN

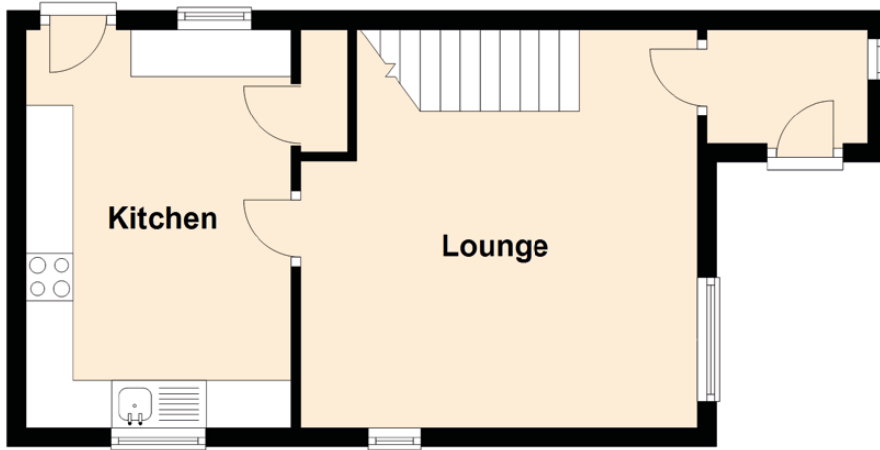

Approximate Dimensions (Taken from the widest point)

Lounge	4.20m (13'9") x 4.20m (13'9")
Kitchen	4.20m (13'9") x 2.80m (9'2")
Bedroom 1	3.20m (10'6") x 3.10m (10'2")
Bedroom 2	3.40m (11'2") x 2.60m (8'7")
Bathroom	2.40m (7'10") x 1.60m (5'3")

Gross internal floor area (m<sup>2</sup>): 63m<sup>2</sup>

