

Floor Plan & Dimensions

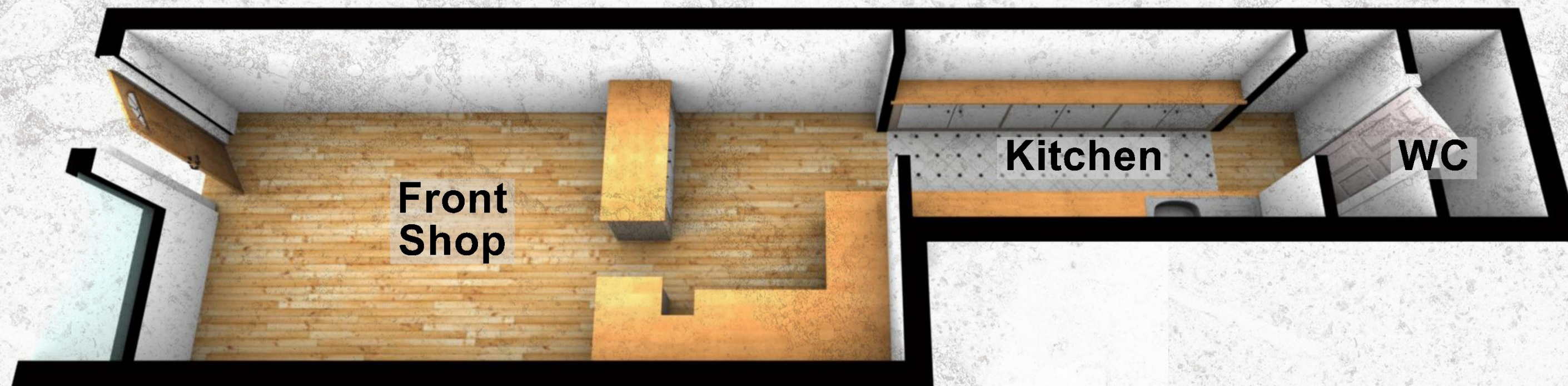

Approximate Dimensions
(Taken from the widest point)

Front Shop	6.25m (20'6") x 2.70m (8'10")
Kitchen	3.15m (10'4") x 1.60m (5'3")
WC	1.60m (5'3") x 0.75m (2'6")

Extras (Included in the sale): Rent is
currently £700 pcm

