

FLOOR PLAN, DIMENSIONS & MAP

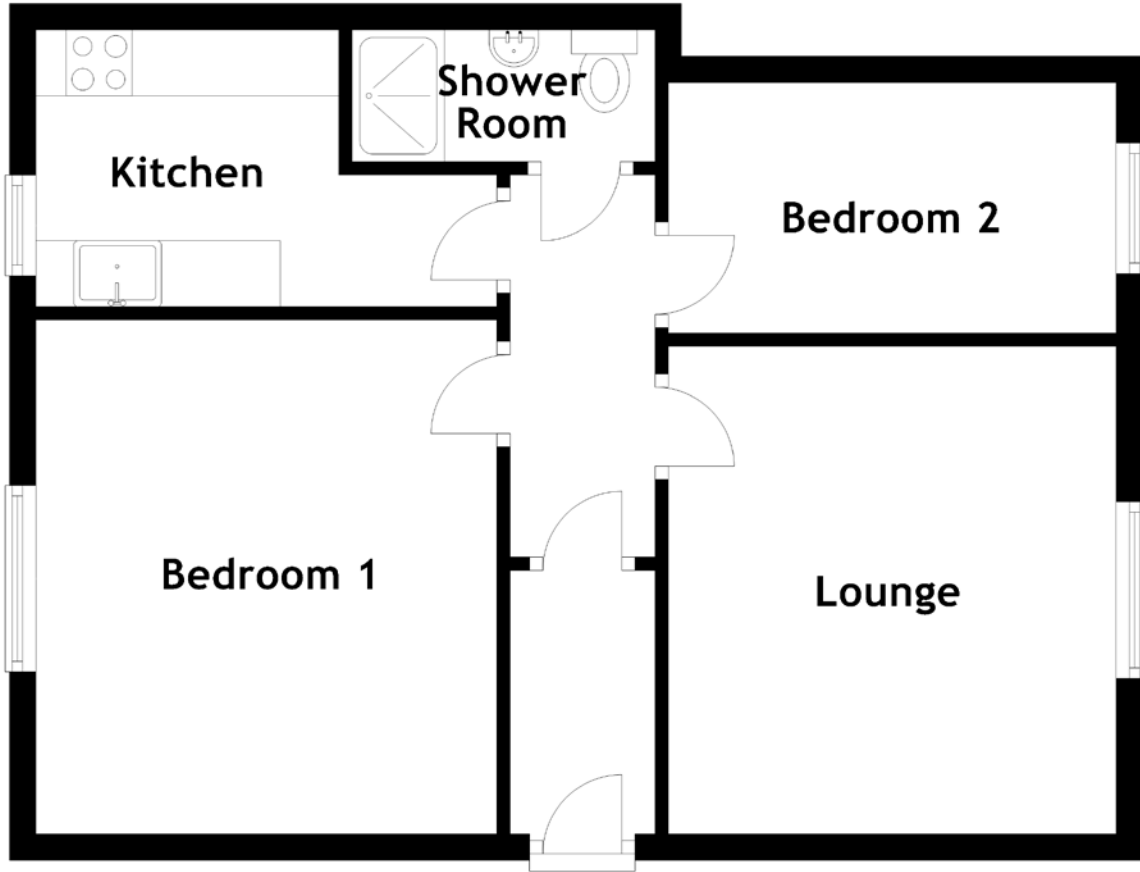

Approximate Dimensions (Taken from the widest point)

Lounge 3.70m (12'2") x 3.40m (11'2")
 Kitchen 2.30m (7'7") x 2.10m (6'11")
 Shower Room 2.30m (7'7") x 1.00m (3'3")

Bedroom 1 3.60m (11'10") x 3.50m (11'6")
 Bedroom 2 3.90m (12'10") x 1.90m (6'3")

Gross internal floor area (m²): 86m²
 EPC Rating: B

