

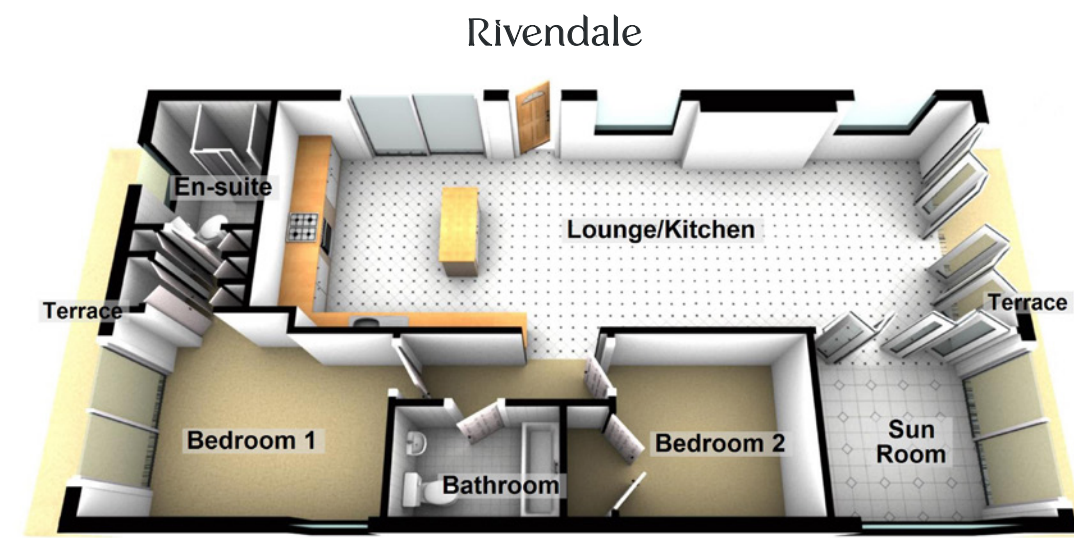

The Rivendale & Lyndale Park Homes



Floor Plans & Dimensions

**Approximate Dimensions
(Taken from the widest point)**

Lounge/Kitchen	10.50m (34'5") x 3.60m (11'10")
Sun Room	2.80m (9'2") x 2.40m (7'10")
Bedroom 1	3.80m (12'6") x 2.70m (8'10")
En-suite	2.05m (6'9") x 1.70m (5'7")
Bedroom 2	2.60m (8'6") x 2.35m (7'9")
Bathroom	2.15m (7'1") x 1.40m (4'7")
Terrace	6.10m (20') x 1.40m (4'7")
Terrace	6.10m (20') x 1.05m (3'5")

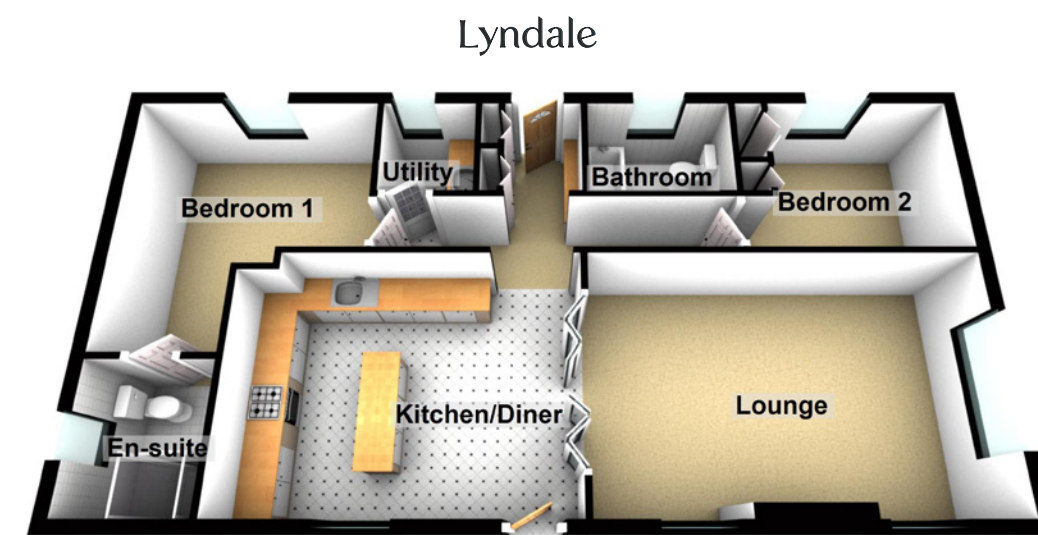

**Approximate Dimensions
(Taken from the widest point)**

Lounge	5.50m (18'1") x 3.60m (11'10")
Kitchen/Diner	4.80m (15'9") x 3.60m (11'10")
Utility	1.50m (4'11") x 1.50m (4'11")
Bedroom 1	3.95m (13') x 3.60m (11'10")
En-suite	2.05m (6'9") x 1.75m (5'9")
Bedroom 2	3.20m (10'6") x 2.40m (7'10")
Bathroom	2.15m (7'1") x 1.50m (4'11")



The Lampport & Norwood Park Homes

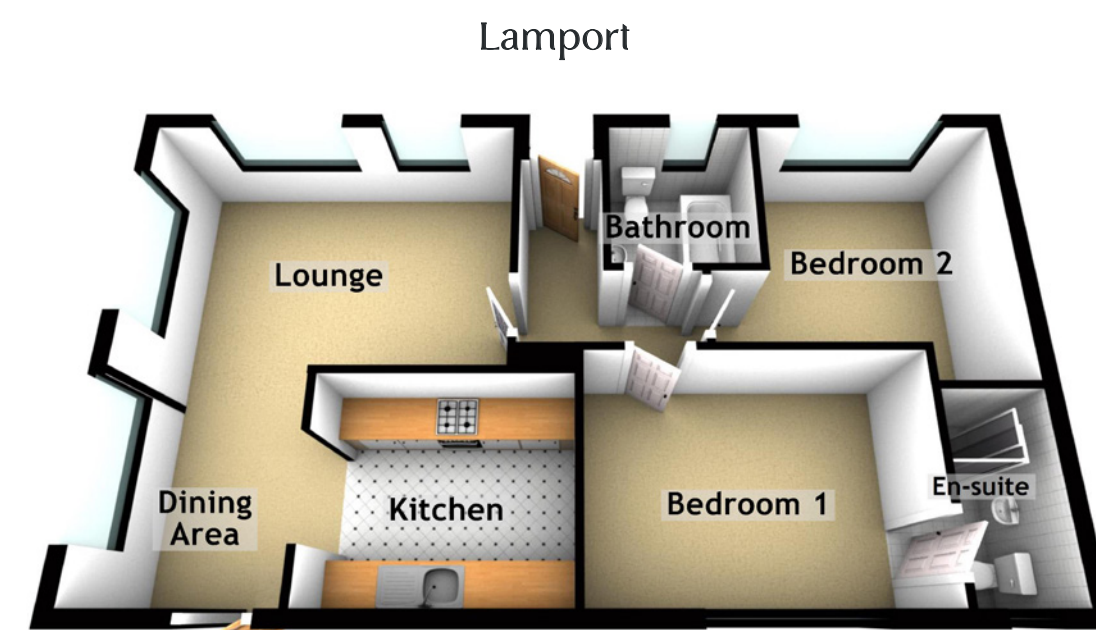

Floor Plans & Dimensions

**Approximate Dimensions
(Taken from the widest point)**

Lounge	4.46m (14'8") x 3.18m (10'5")
Dining Area	2.50m (8'2") x 2.25m (7'5")
Kitchen	2.87m (9'5") x 2.50m (8'2")
Bedroom 1	3.85m (12'8") x 2.78m (9'1")
En-suite	2.32m (7'7") x 1.14m (3'9")
Bedroom 2	3.60m (11'10") x 2.92m (9'7")
Bathroom	1.91m (6'3") x 1.76m (5'9")

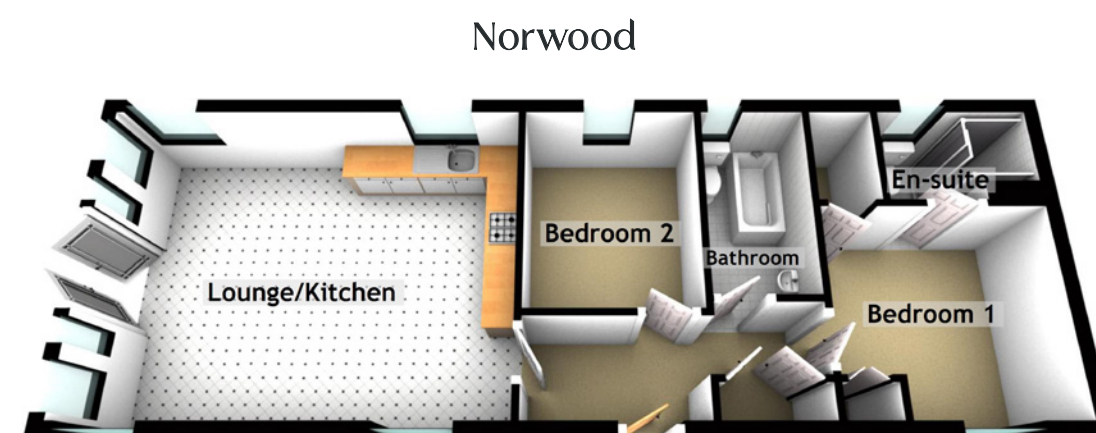

**Approximate Dimensions
(Taken from the widest point)**

Lounge/Kitchen	5.62m (18'5") x 4.25m (13'11")
Bedroom 1	3.00m (9'10") x 2.82m (9'3")
En-suite	2.05m (6'9") x 1.35m (4'5")
Bedroom 2	2.84m (9'4") x 1.83m (6')
Bathroom	2.66m (8'9") x 1.41m (4'8")