

FLOOR PLAN, DIMENSIONS & MAP

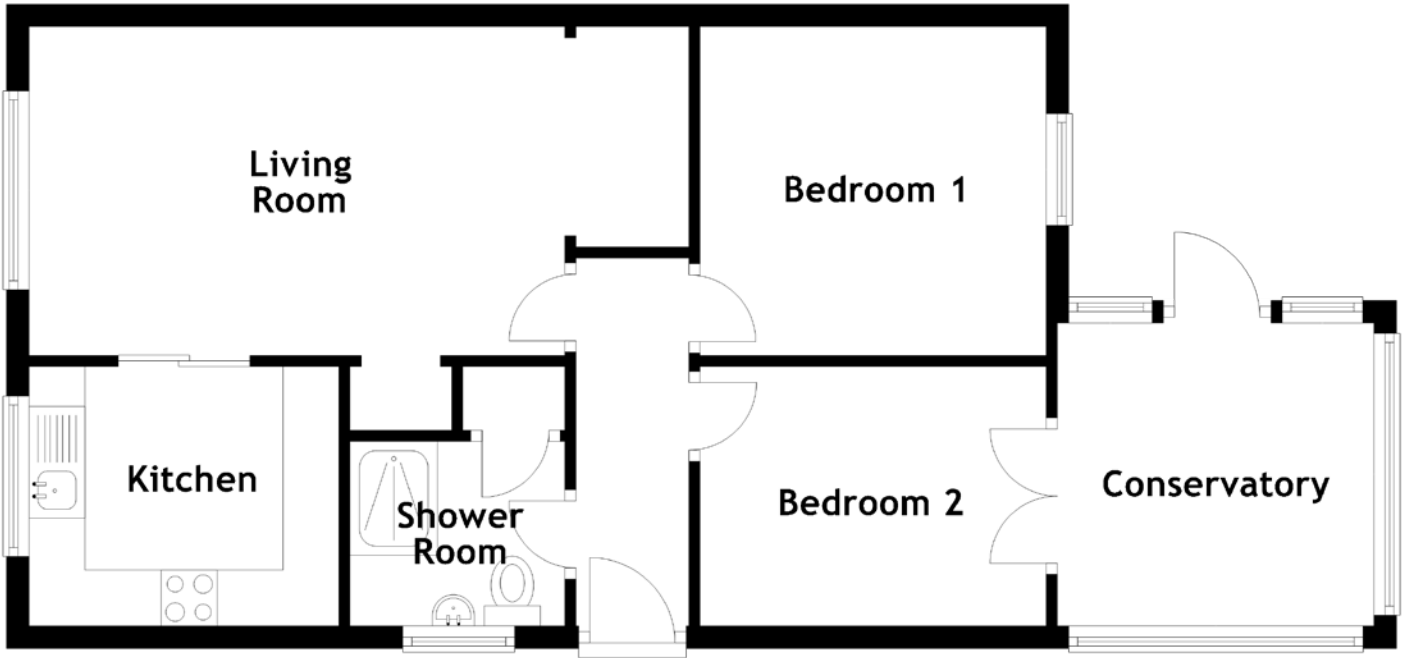

Approximate Dimensions
(Taken from the widest point)

Living Room 4.79m (15'9") x 2.94m (9'8")
 Kitchen 2.77m (9'1") x 2.32m (7'7")
 Shower Room 1.95m (6'5") x 1.65m (5'5")

Bedroom 1 3.09m (10'2") x 3.02m (9'11")
 Bedroom 2 3.09m (10'2") x 2.29m (7'6")
 Conservatory 2.83m (9'3") x 2.71m (8'11")

Gross internal floor area (m²): 54m²
 EPC Rating: D

