

Flat 1 Harbour Buildings

PORTMAHOMACK, TAIN, HIGHLAND, IV20 1YG

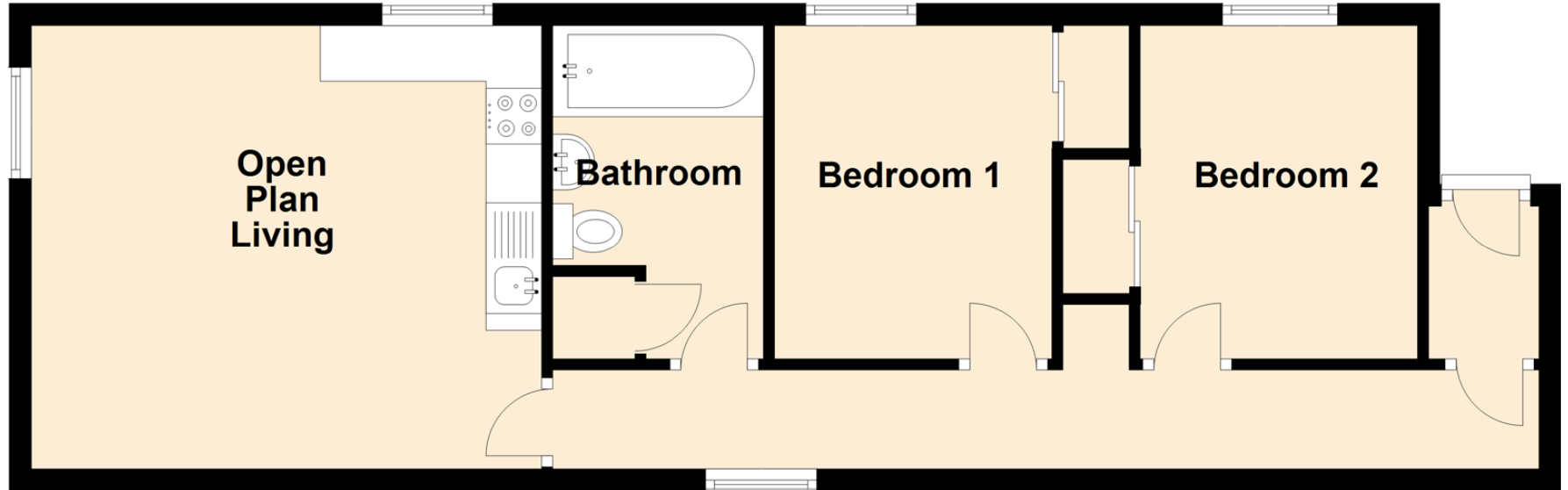

Approximate Dimensions (Taken from the widest point)

Open Plan Living	4.60m (15'1") x 3.99m (13'1")
Bedroom 1	3.00m (9'10") x 2.50m (8'2")
Bedroom 2	3.00m (9'10") x 2.50m (8'2")
Bathroom	3.00m (9'10") x 1.90m (6'3")

Gross internal floor area (m²): 51m² | EPC Rating: E