

112 Picktillum Place

KITTYBREWSTER, ABERDEEN, AB25 3AW

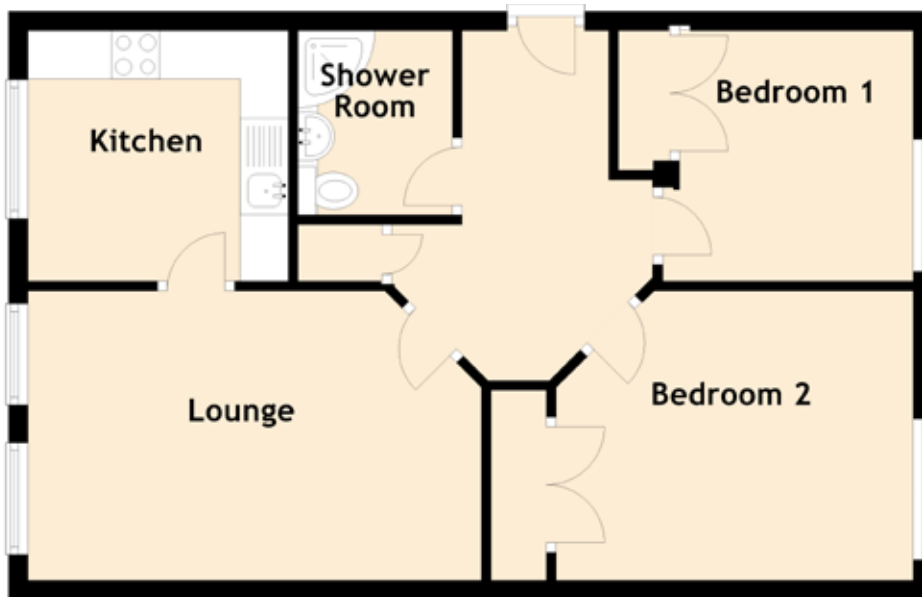

Approximate Dimensions (Taken from the widest point)

Lounge	4.70m (15'5") x 3.00m (9'10")
Kitchen	2.70m (8'10") x 2.20m (7'3")
Bedroom 1	2.80m (9'2") x 2.00m (6'7")
Bedroom 2	3.40m (11'2") x 3.00m (9'10")
Shower Room	1.90m (6'3") x 1.60m (5'3")

Gross internal floor area (m²): 53m² | EPC Rating: C