

26 Mountstuart Avenue

LANARKSHIRE, SOUTH LANARKSHIRE, ML11 9NR

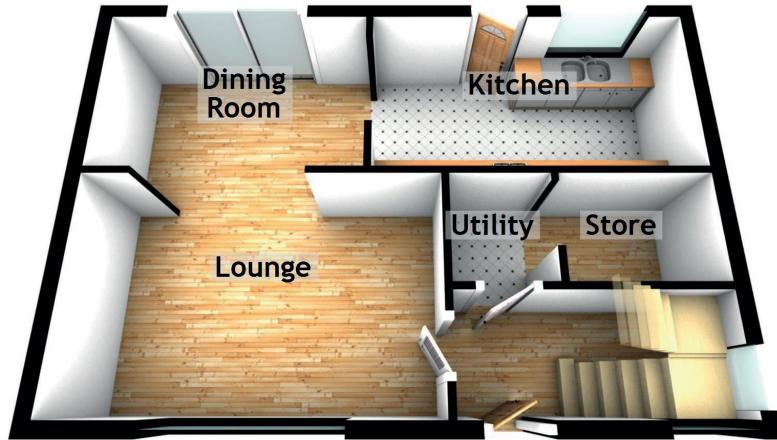

Approximate Dimensions (Taken from the widest point)

Ground Floor

Lounge	4.61m (15'1") x 2.99m (9'10")
Dining Room	3.61m (11'10") x 2.33m (7'8")
Kitchen	4.36m (14'4") x 2.33m (7'8")
Utility	1.42m (4'8") x 1.30m (4'3")
Store	1.96m (6'5") x 1.42m (4'8")

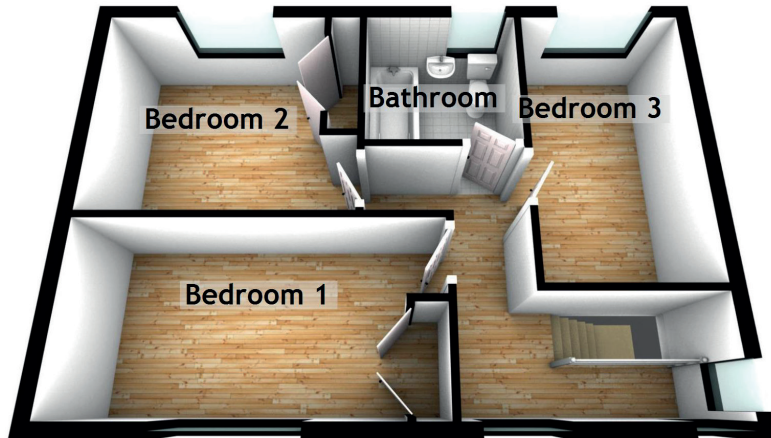

First Floor

Bedroom 1	4.67m (15'4") x 2.40m (7'10")
Bedroom 2	3.54m (11'7") x 2.93m (9'7")
Bedroom 3	3.55m (11'8") x 2.21m (7'3")
Bathroom	2.09m (6'10") x 1.94m (6'4")