

# Flat 1/1 3 Maclean Street

KINNING PARK, GLASGOW, G51 1TB

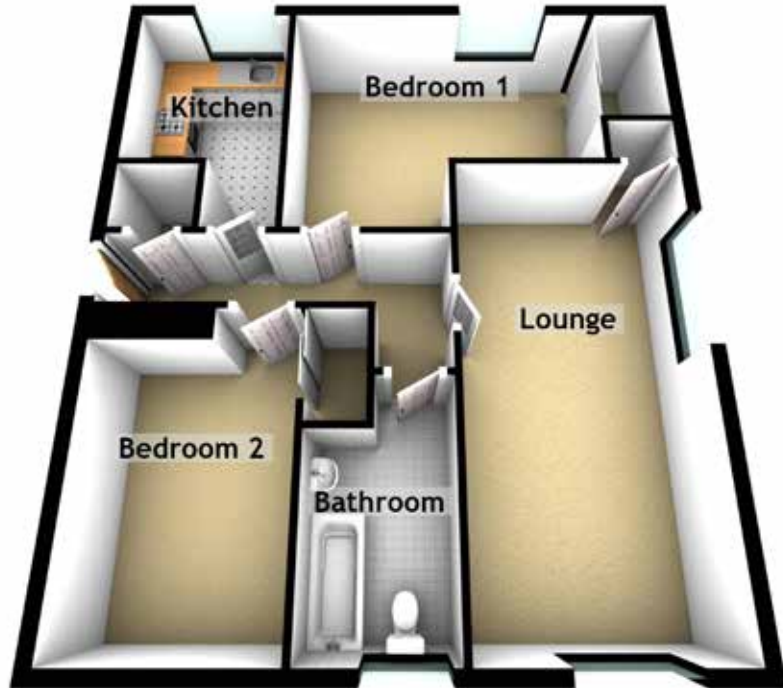

Approximate Dimensions (Taken from the widest point)

Lounge	6.80m (22'4") x 3.50m (11'6")
Kitchen	2.60m (8'6") x 1.90m (6'3")
Bedroom 1	4.52m (14'10") x 2.60m (8'6")
Bedroom 2	4.20m (13'9") x 2.70m (8'10")
Bathroom	3.30m (10'10") x 1.50m (4'11")