

5/4, 23 Oswald Street

GLASGOW, G1 4PE

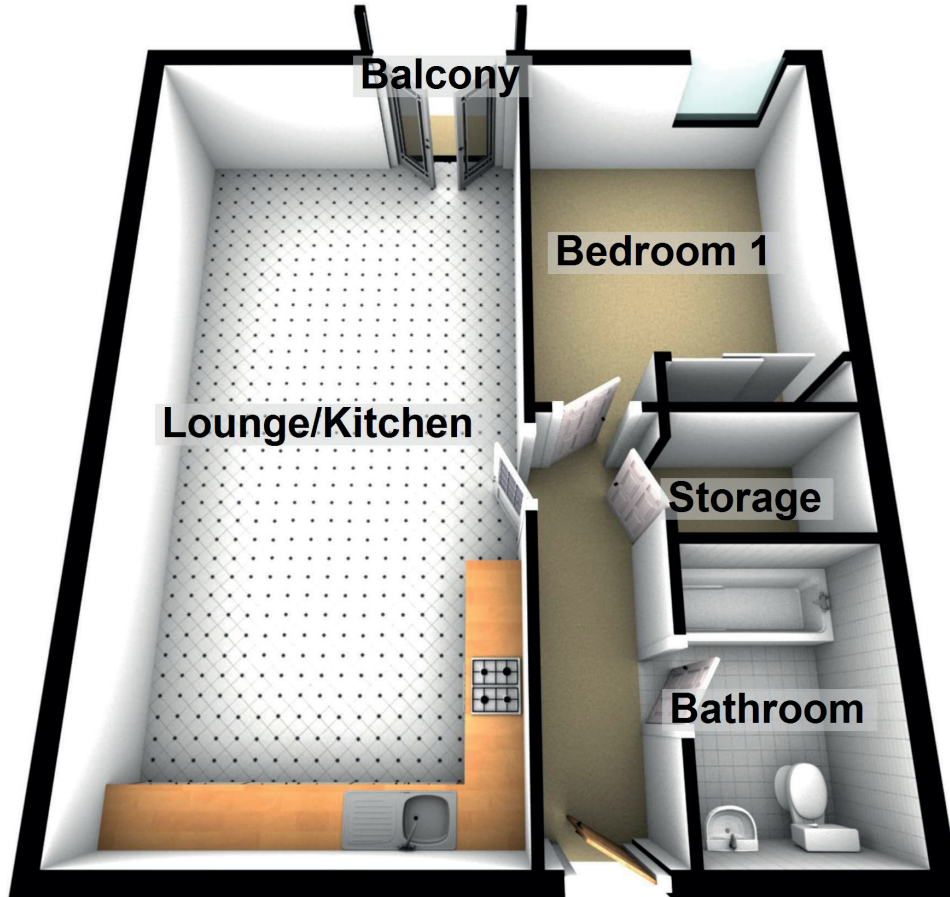

Approximate Dimensions (Taken from the widest point)

Lounge/Kitchen	7.60m (24'11") x 3.70m (12'2")
Bedroom 1	3.80m (12'6") x 2.90m (9'6")
Bathroom	2.50m (8'2") x 1.70m (5'7")