

# FLOOR PLAN, DIMENSIONS & MAP

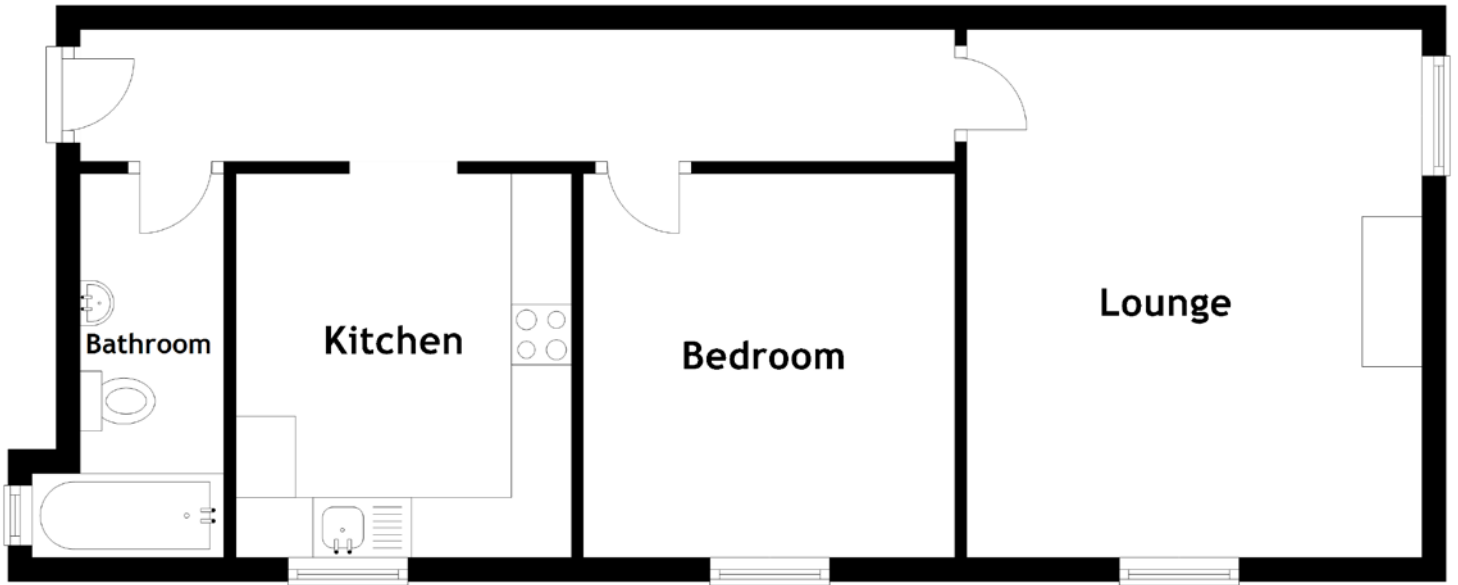

Approximate Dimensions  
(Taken from the widest point)

Bedroom 3.20m (10'6") x 3.10m (10'2")  
Bathroom 3.20m (10'6") x 1.20m (3'11")

Lounge 4.40m (14'5") x 3.80m (12'6")  
Kitchen 3.20m (10'6") x 2.80m (9'2")

Gross internal floor area (m<sup>2</sup>): 50m<sup>2</sup>  
EPC Rating: E

