

FLOOR PLAN, DIMENSIONS & MAP

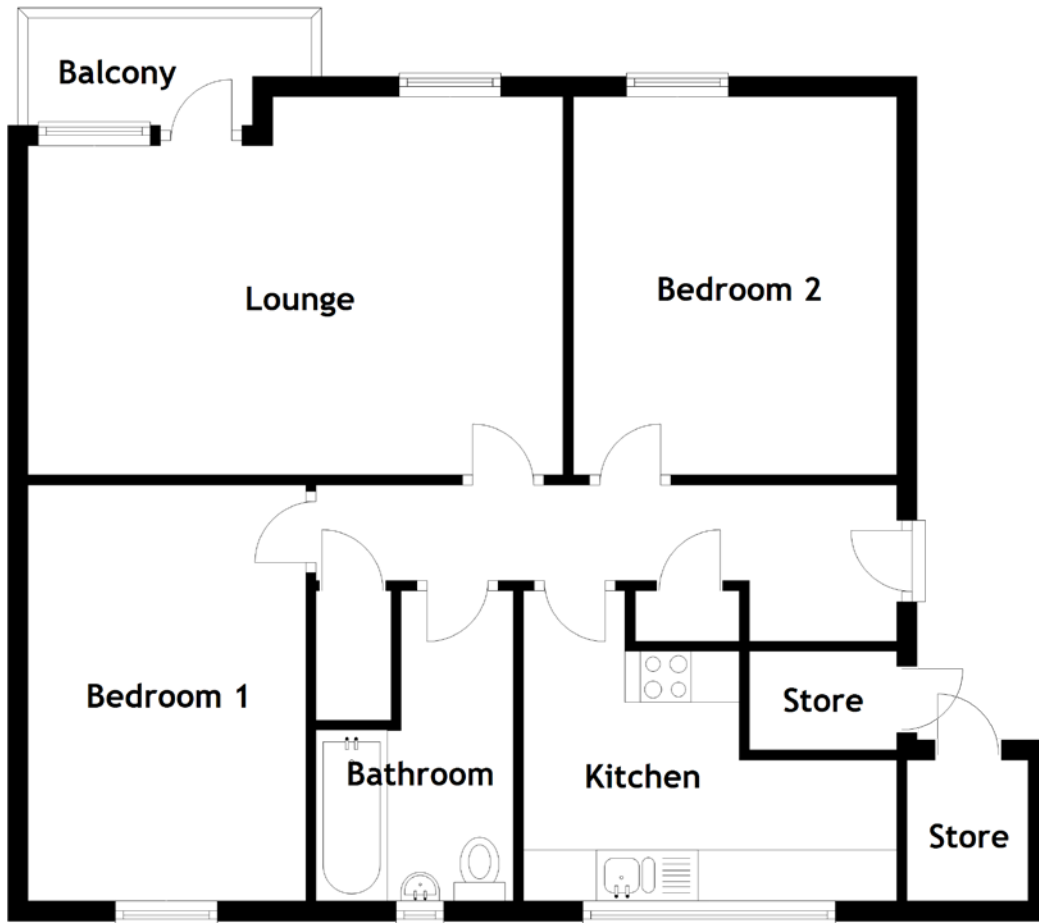

Approximate Dimensions (Taken from the widest point)

Lounge 5.26m (17'3") x 3.72m (12'2")
 Kitchen 3.67m (12') x 3.05m (10')
 Balcony 2.78m (9'2") x 1.16m (3'10")

Bedroom 1 4.09m (13'5") x 2.73m (8'11")
 Bedroom 2 3.72m (12'2") x 3.15m (10'4")
 Bathroom 3.05m (10') x 1.94m (6'4")

Gross internal floor area (m²): 71m² | EPC Rating: C

