

# 38 Bittern Court

DUNFERMLINE, KY11 8HF

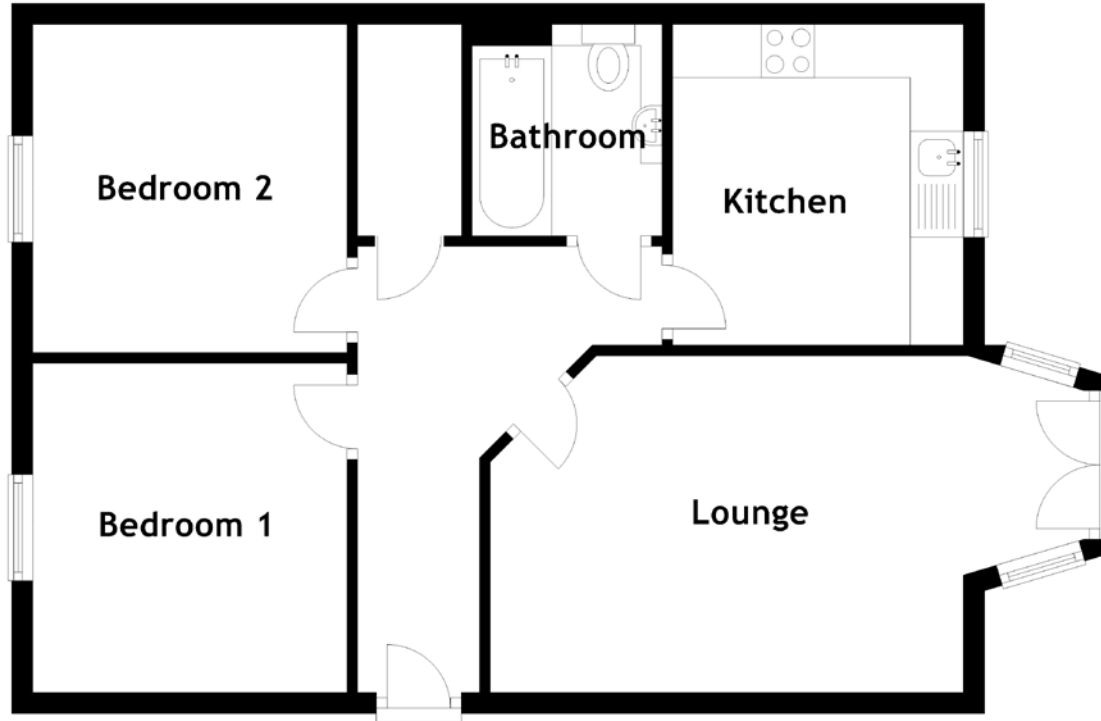

Approximate Dimensions  
(Taken from the widest point)

Lounge	5.60m (18'4") x 3.17m (10'5")
Kitchen	3.02m (9'11") x 2.74m (9')
Bedroom 1	3.10m (10'2") x 2.96m (9'9")
Bedroom 2	3.09m (10'2") x 2.96m (9'9")
Bathroom	1.99m (6'6") x 1.79m (5'10")

Gross internal floor area (m<sup>2</sup>): 56m<sup>2</sup>

EPC Rating: B