

# Flat 4, 30 Ayr Street

GLASGOW, G21 4DG

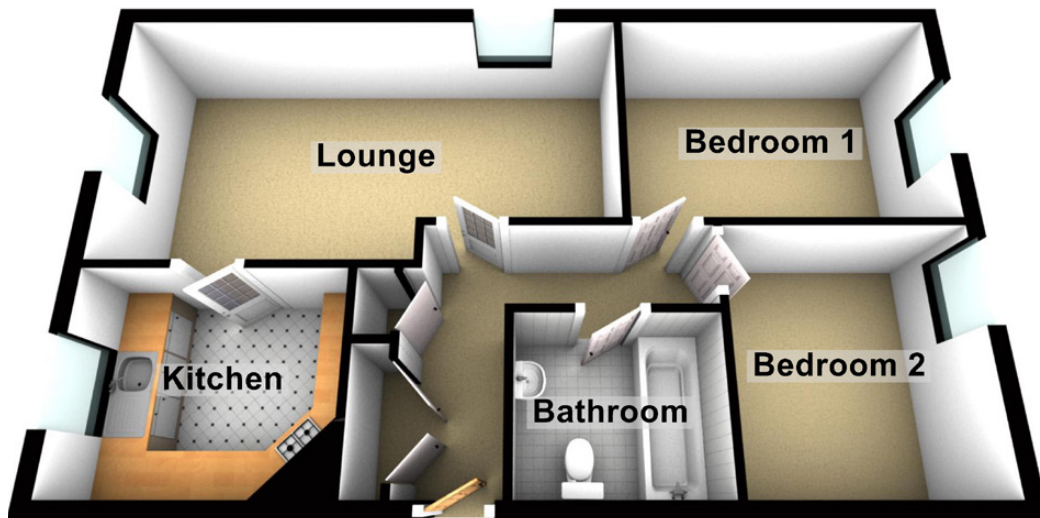

Approximate Dimensions (Taken from the widest point)

Lounge	5.90m (19'4") x 3.10m (10'2")
Kitchen	2.90m (9'6") x 2.40m (7'10")
Bedroom 1	3.70m (12'2") x 2.60m (8'6")
Bedroom 2	2.90m (9'6") x 2.70m (8'10")
Bathroom	2.20m (7'3") x 1.90m (6'3")