

33C Baldovan Terrace

DUNDEE, ANGUS, DD4 6NH

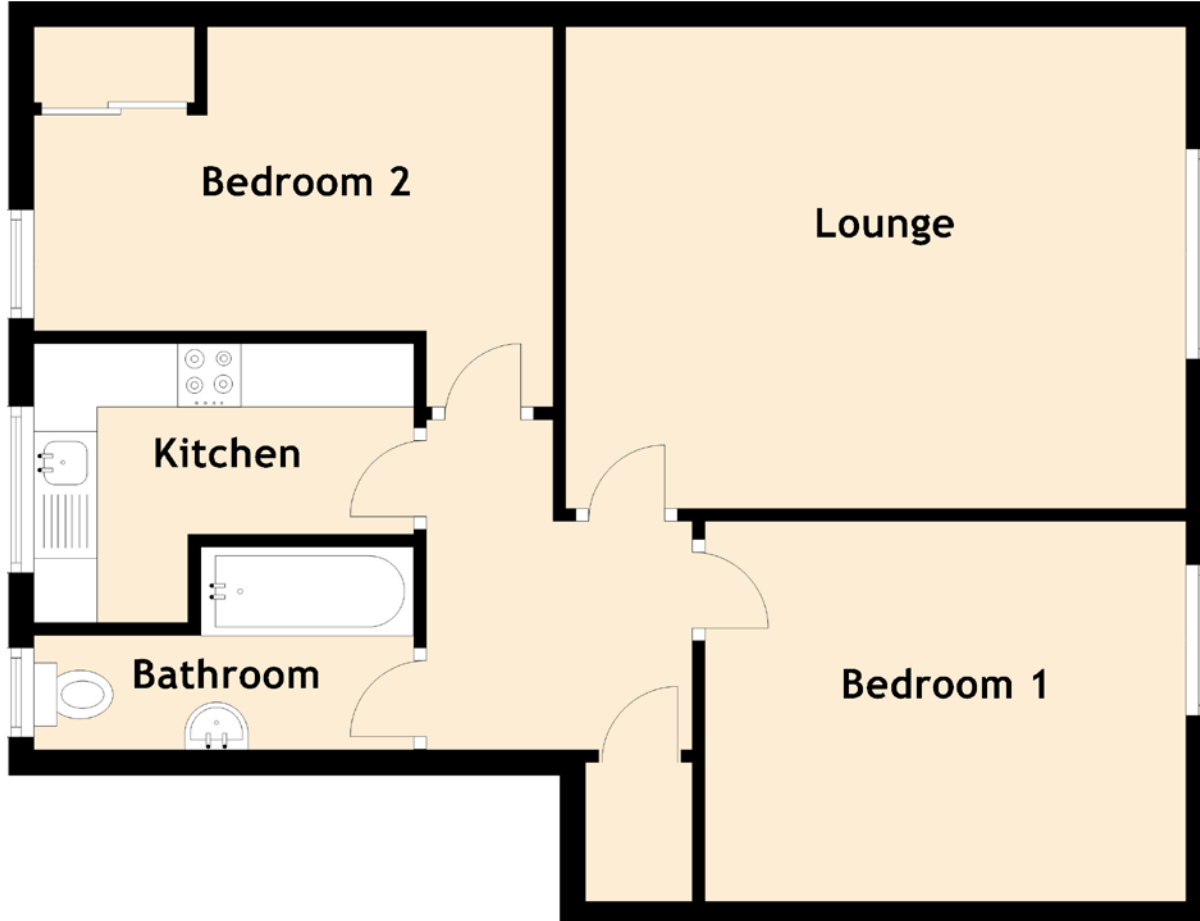

Approximate Dimensions
(Taken from the widest point)

Lounge	4.90m (16'1") x 3.80m (12'6")
Kitchen	3.00m (9'10") x 2.20m (7'3")
Bedroom 1	3.80m (12'6") x 3.00m (9'10")
Bedroom 2	4.10m (13'5") x 3.00m (9'10")
Bathroom	3.20m (10'6") x 1.60m (5'3")

Gross internal floor area (m²): 60m²

EPC Rating: C