

# FLOOR PLAN, DIMENSIONS & MAP

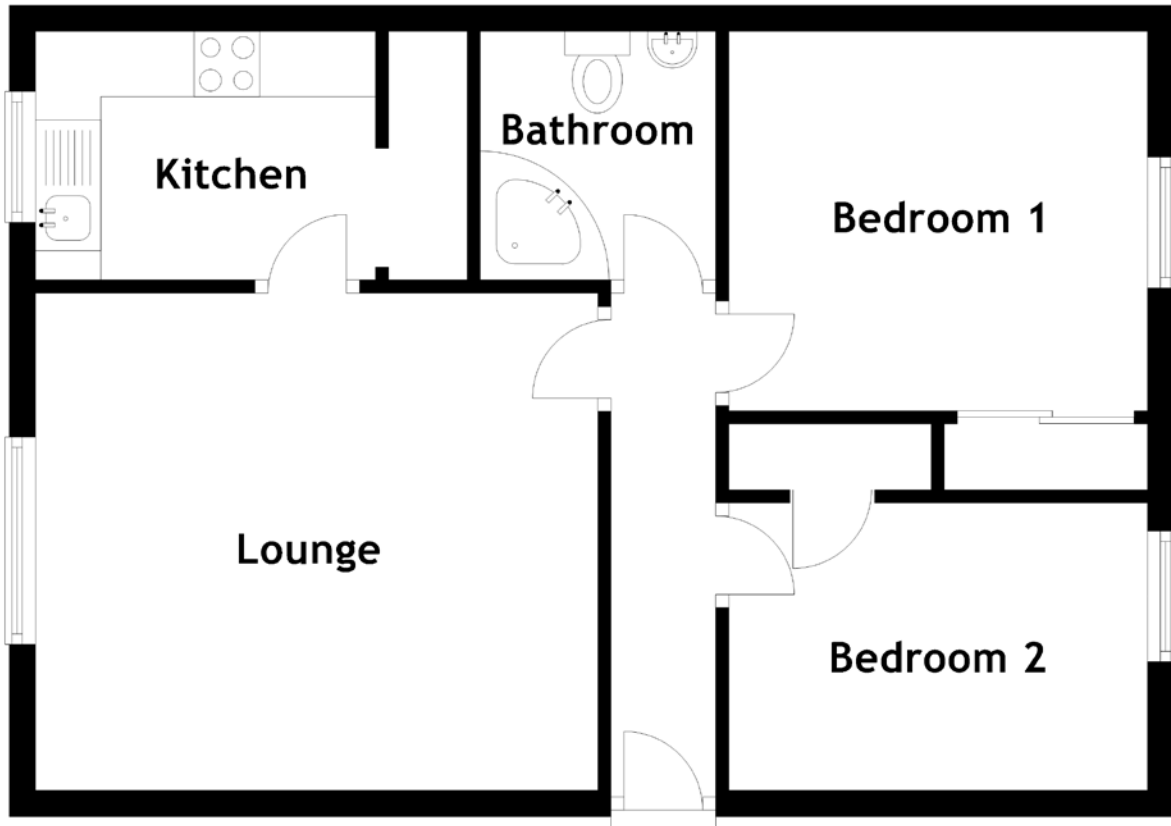

Approximate Dimensions  
(Taken from the widest point)

Lounge 4.30m (14'1") x 3.80m (12'6")  
Kitchen 2.60m (8'6") x 1.90m (6'3")

Bathroom 1.90m (6'3") x 1.80m (5'11")  
Bedroom 1 3.20m (10'6") x 2.90m (9'6")  
Bedroom 2 3.20m (10'6") x 2.20m (7'2")

Gross internal floor area (m<sup>2</sup>): 54m<sup>2</sup> | EPC Rating: C

