

# 1/1, 14 Midlock Street

IBROX, GLASGOW, G51 1SL

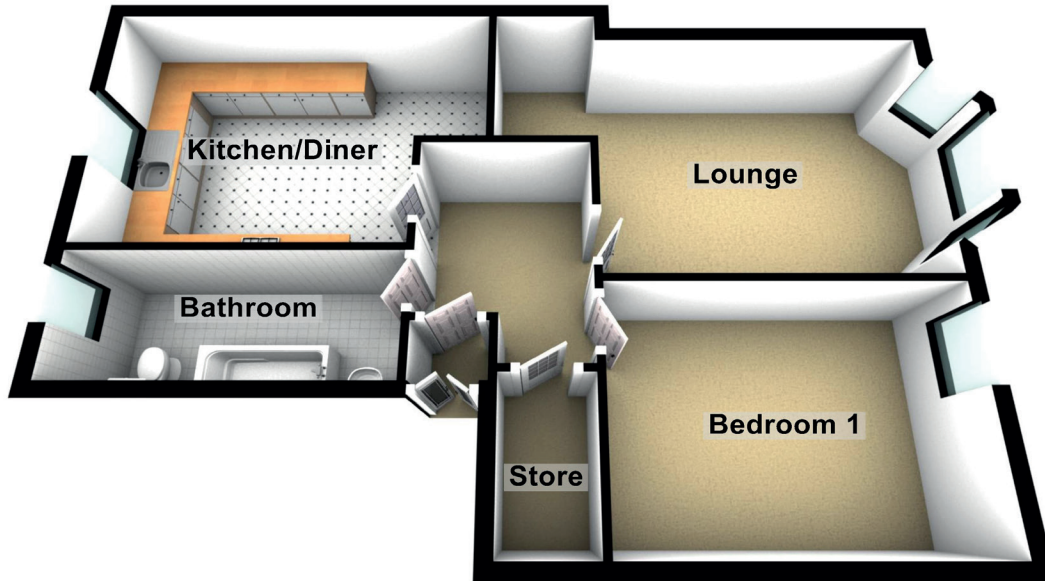

Approximate Dimensions (Taken from the widest point)

Lounge	5.50m (18'1") x 3.80m (12'6")
Kitchen/Diner	4.90m (16'1") x 3.40m (11'2")
Bedroom	4.40m (14'5") x 3.10m (10'2")
Bathroom	4.00m (13'1") x 1.60m (5'3")