

5a Douglas Muir Road

CLYDEBANK, WEST DUNBARTONSHIRE, G81 5DW

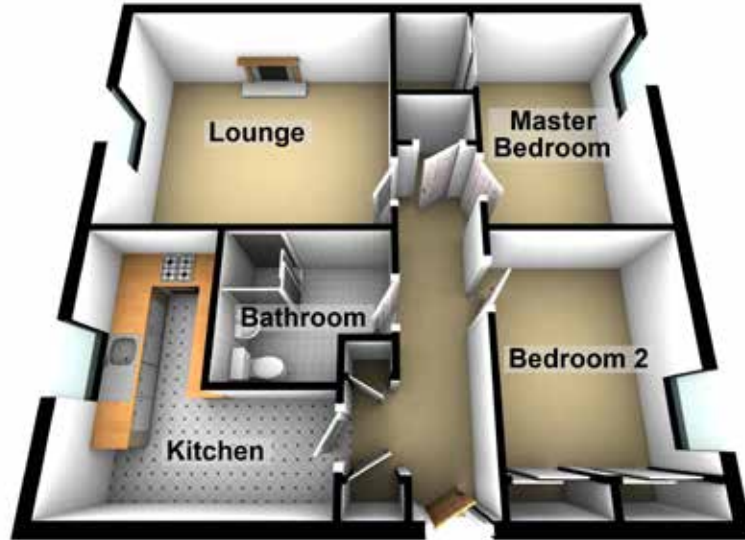

Approximate Dimensions (Taken from the widest point)

Lounge	4.60m (15'1") x 3.80m (12'6")
Kitchen	3.90m (12'10") x 3.70m (12'2")
Bedroom 2	3.00m (9'10") x 2.60m (8'6")
Master Bedroom	3.80m (12'6") x 2.60m (8'6")
Bathroom	2.10m (6'11") x 2.10m (6'11")

Gross internal floor area (m²) - 65m² EPC Rating - C