

2/3, 74 Chancellor Street

PARTICK, GLASGOW, G11 5PN

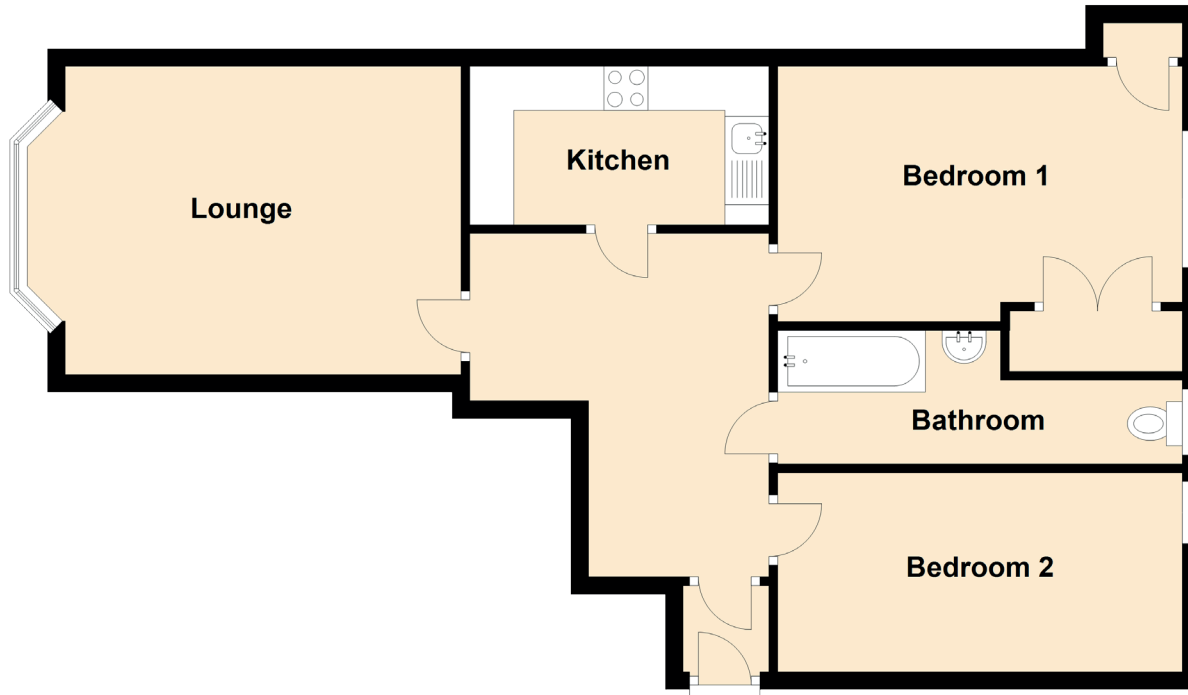

Approximate Dimensions
(Taken from the widest point)

Lounge	4.50m (14'9") x 3.30m (10'10")
Kitchen	3.40m (11'2") x 1.80m (5'11")
Bedroom 1	4.60m (15'1") x 2.90m (9'6")
Bedroom 2	4.60m (15'1") x 2.60m (8'6")
Bathroom	4.60m (15'1") x 1.52m (5')