

5 West Baldrige Road

DUNFERMLINE, KY12 9AW

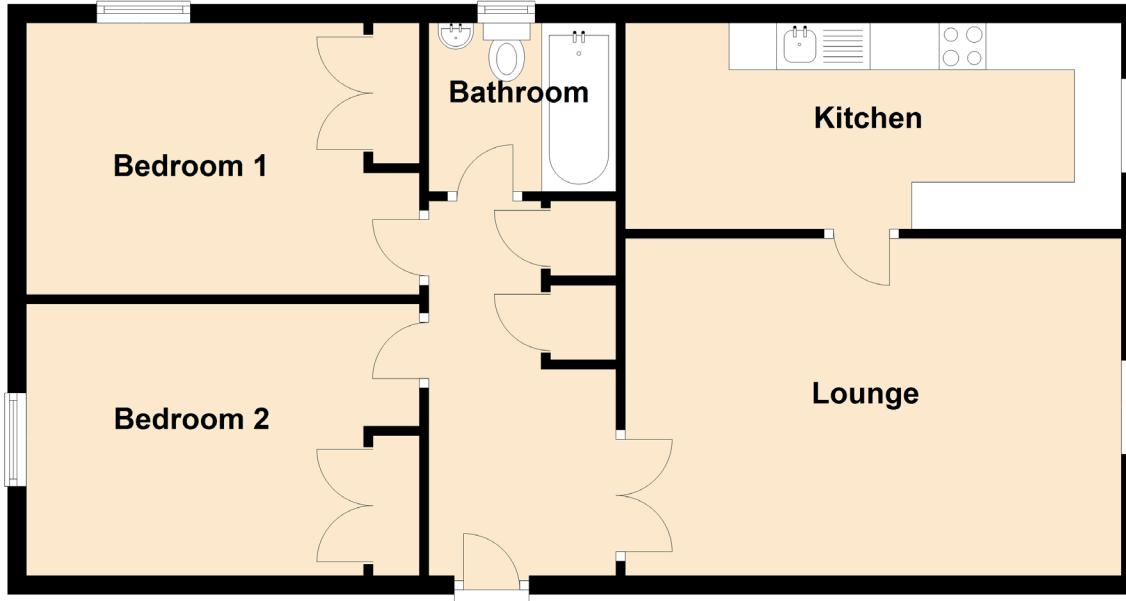

Approximate Dimensions
(Taken from the widest point)

Lounge	5.30m (17'5") x 3.60m (11'10")
Kitchen	5.10m (16'9") x 2.20m (7'3")
Bedroom 1	4.20m (13'9") x 2.90m (9'6")
Bedroom 2	4.20m (13'9") x 2.90m (9'6")
Bathroom	2.00m (6'7") x 1.80m (5'11")