

FLOOR PLAN, DIMENSIONS & MAP

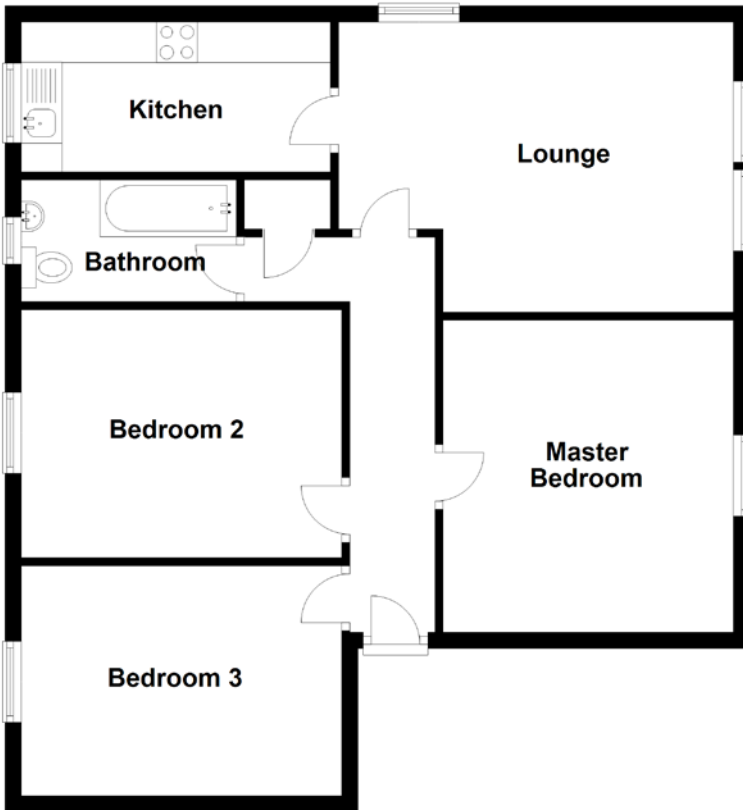

Approximate Dimensions
(Taken from the widest point)

Lounge	4.87m (16') x 3.58m (11'9")
Kitchen	3.81m (12'6") x 1.85m (6'1")
Master Bedroom	3.85m (12'8") x 3.58m (11'9")
Bedroom 2	3.95m (13') x 3.06m (10')
Bedroom 3	3.95m (13') x 2.84m (9'4")
Bathroom	2.65m (8'8") x 1.50m (4'11")

Gross internal floor area (m²): 84m²

EPC Rating: E

