

FLOOR PLAN, DIMENSIONS & MAP

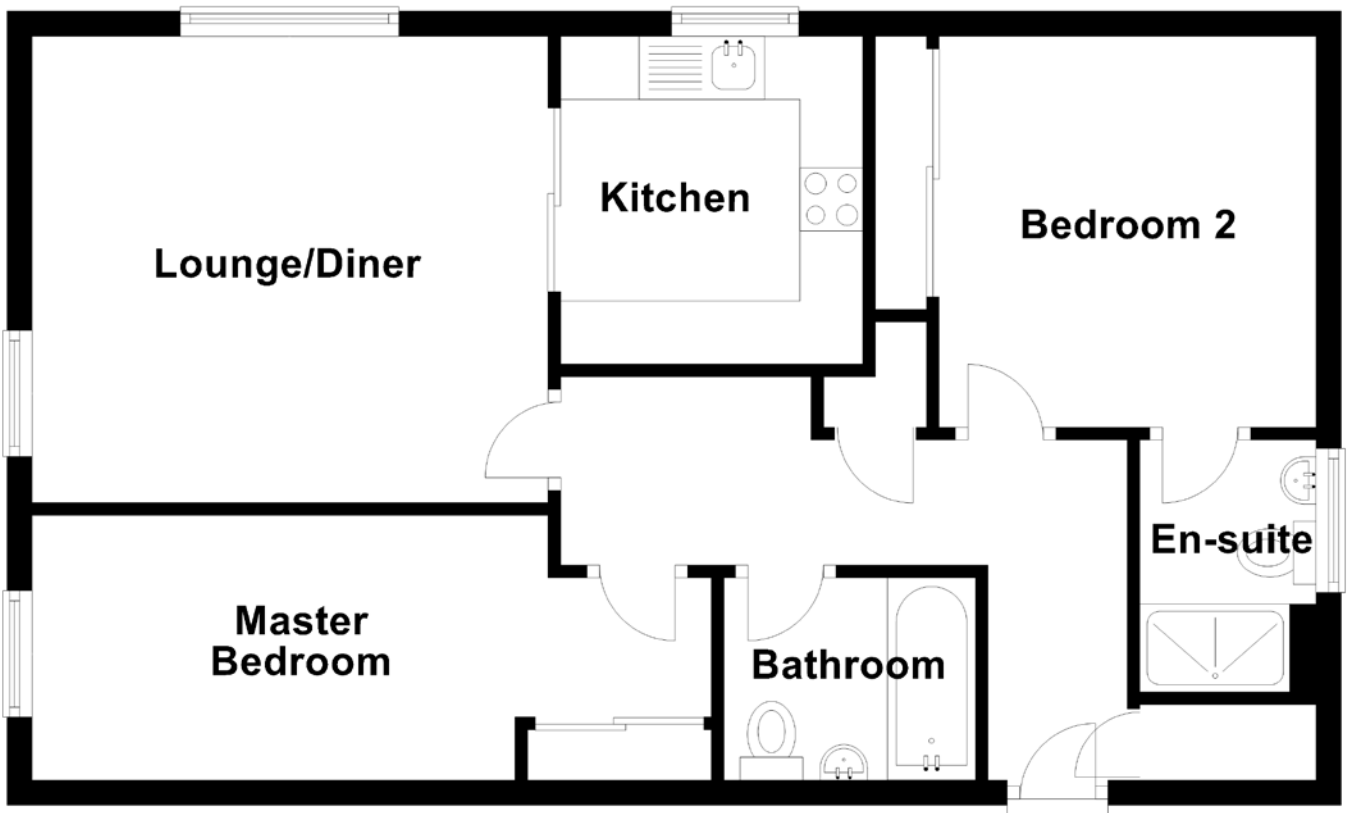

Approximate Dimensions
(Taken from the widest point)

Lounge/Diner	4.10m (13'5") x 3.70m (12'2")
Kitchen	2.60m (8'6") x 2.40m (7'10")
Master Bedroom	4.40m (14'5") x 2.10m (6'11")
En-suite	2.10m (6'10") x 1.40m (4'7")
Bedroom 2	3.10m (10'2") x 3.00m (9'10")
Bathroom	2.00m (6'7") x 1.60m (5'3")

Gross internal floor area (m²): 67m²
EPC Rating: B

Extras (Included in the sale): Selected fixtures and fittings, including; blinds, curtains, light fittings, carpets and fitted floor coverings. Please note, other items may be available through separate negotiation.

