

FLOOR PLAN, DIMENSIONS & MAP

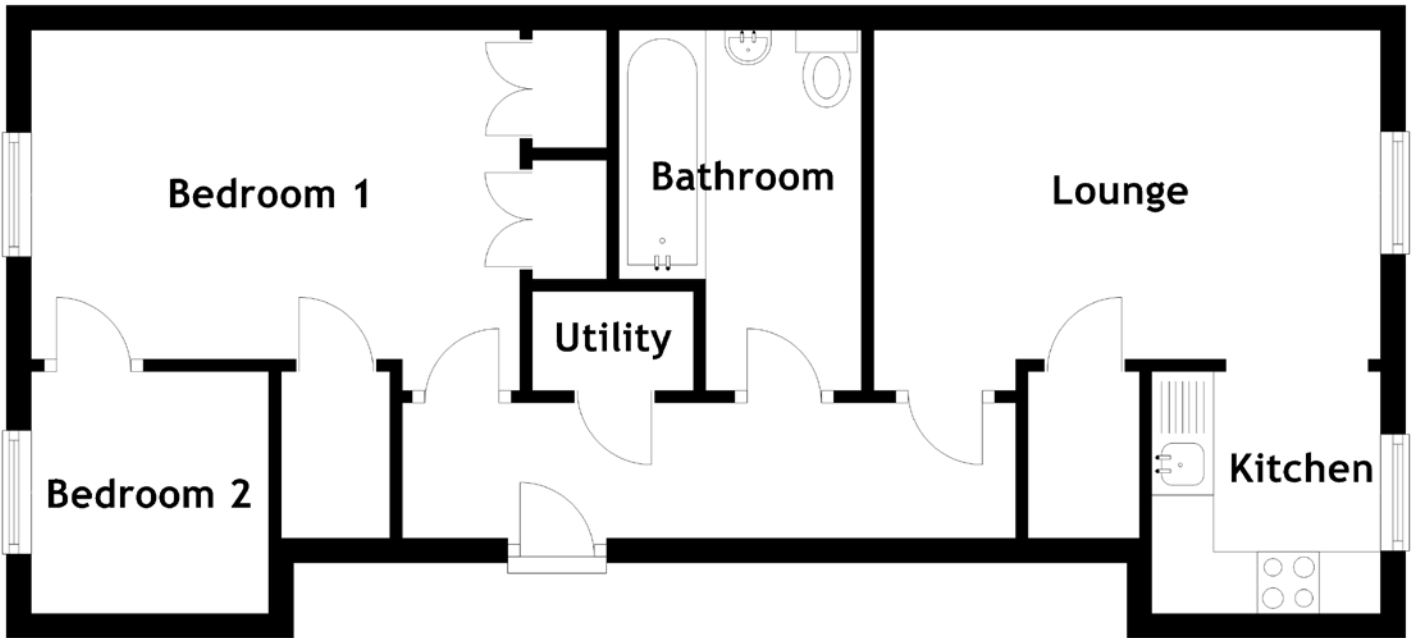

Approximate Dimensions (Taken from the widest point)

Lounge 4.10m (13'5") x 2.91m (9'7")
 Kitchen 1.92m (6'4") x 1.85m (6'1")
 Utility 1.07m (3'6") x 0.80m (2'7")

Bedroom 1 3.95m (13') x 2.91m (9'7")
 Bedroom 2 1.92m (6'4") x 1.87m (6'2")
 Bathroom 2.91m (9'7") x 1.86m (6'1")

Gross internal floor area (m²): 54m² | EPC Rating: C

