

# FLOOR PLAN, DIMENSIONS & MAP

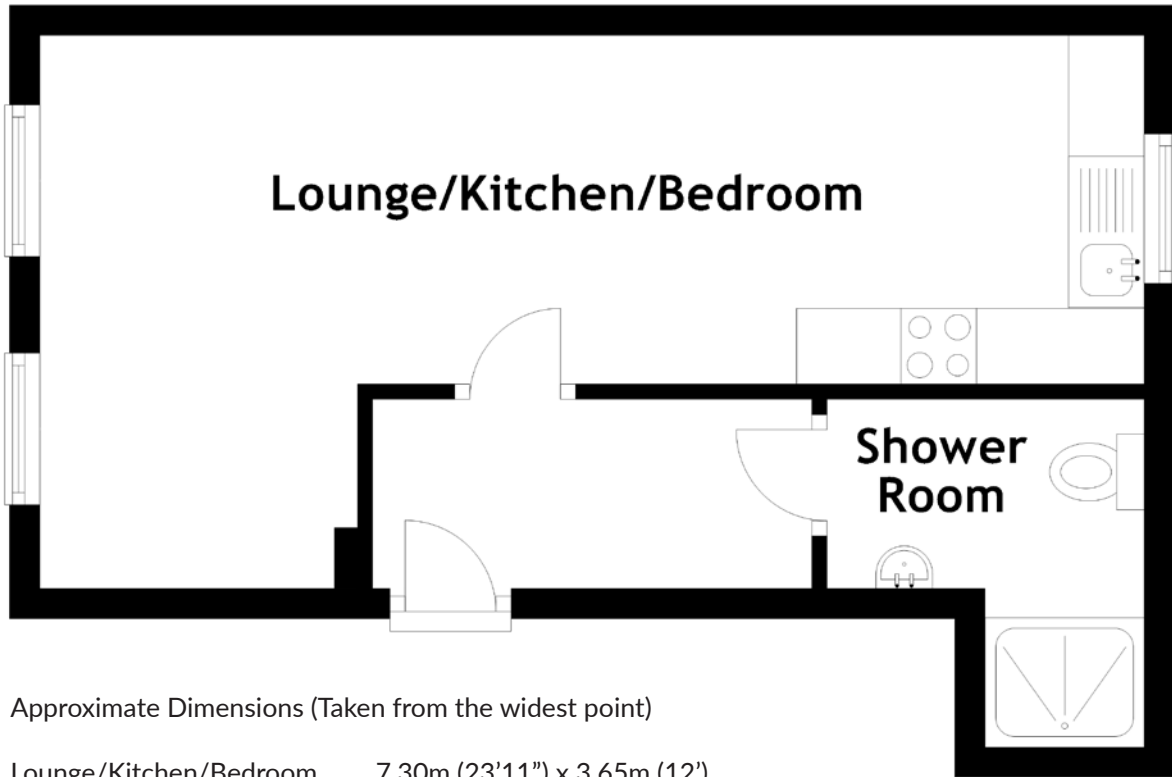

Approximate Dimensions (Taken from the widest point)

Lounge/Kitchen/Bedroom      7.30m (23'11") x 3.65m (12')  
Shower Room                      2.30m (7'6") x 2.10m (6'11")

Gross internal floor area (m<sup>2</sup>): 30m<sup>2</sup> | EPC Rating: C

Extras: Floor coverings, light fittings, blinds and window dressings.

